

Model 168110 18" x 7.2'-22.6' Nylon Wheel  
Model 168111 24" x 7.2'-22.6' Nylon Wheel  
Model 168112 18" x 7.2'-22.6' Steel Wheel  
Model 168113 24" x 7.2'-22.6' Steel Wheel

It is the responsibility of the assembler/user to completely read and understand all instructions and safety information before proceeding with assembly. Following these instructions will ensure proper function and safety.

**SAFETY INFORMATION**

**! DANGER**

- Do not put hands on scissor supports.

**! CAUTION**

- Conveyor is very heavy. Assembly requires more than two people to prevent injury.
- Clean the conveyor regularly to maintain the lifespan.

**! WARNING**

- Do not overload. Maximum capacity: 175 lb per foot.
- Keep the casters breaks down while in use.
- Do not stand up on top of the unit.
- Conveyor is not a toy. Not for use by children.
- This product contains chemicals which are known by the state of California to cause cancer, birth defects or other reproductive harm.

Portable Flexible  
& Expandable Conveyor

SPECIFICATIONS

Model	Wheel Material	Effective Width in.	Overall Width in.	Retracted Length ft.	Extended Length ft.	Lowest Height in.	Highest Height in.	Load Cap. lb./ft. <sup>2</sup>
	---	w	W	l	L	h	H	---
168110	Nylon	18	23.6	7.2	22.6	27.6	39.4	175
168111	Nylon	24	29.5	7.2	22.6	27.6	39.4	175
168112	Steel	18	23.6	7.2	22.6	27.6	39.4	175
168113	Steel	24	29.5	7.2	22.6	27.6	39.4	175

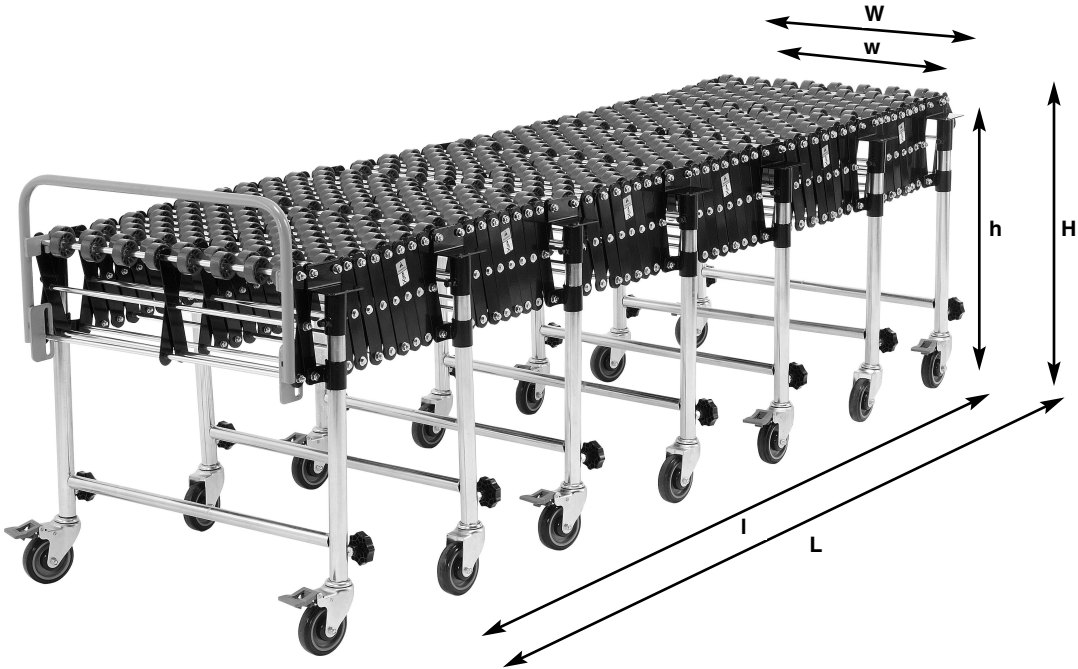

COMPONENTS

Model	Component Model No.	Description
168110	330CP118	18" Nylon Skate Wheel Expandable Conveyor (Body only)
	330CP122	18" Expandable Conveyor Leg Kit
168111	330CP119	24" Nylon Skate Wheel Expandable Conveyor (Body only)
	330CP123	24" Expandable Conveyor Leg Kit
168112	330CP120	18" Nylon Skate Wheel Expandable Conveyor (Body only)
	330CP122	18" Expandable Conveyor Leg Kit
168113	330CP121	24" Nylon Skate Wheel Expandable Conveyor (Body only)
	330CP123	24" Expandable Conveyor Leg Kit

COMPONENTS CONTENT

Component	Content	Key	Quantity
Skate Wheel Body	Conveyor body	1	1
	Leg support	2	7
Skate Wheel Leg	Swivel caster with brake	3	8
	Swivel caster without brake	4	6
	Box stop/Handle	5	1
	Hex Key	H1	1
	Leg knob	H2	14
	Box Wrench	H3	1

# Portable Flexible & Expandable Conveyor

## CAUTION

Conveyor is very heavy. Assembly requires more than two people to prevent injury.

**1**

Lay conveyor body (1) upside down on a level surface. Loosen all set screws with hex key (H1) provided.

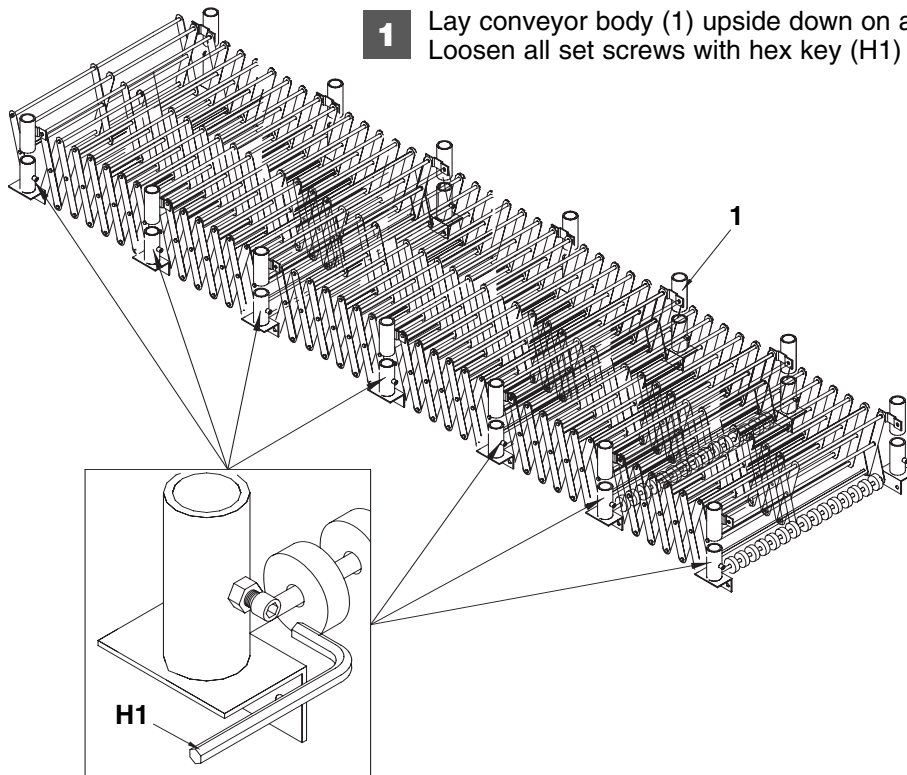
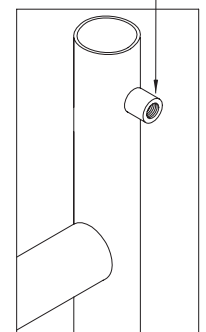
**Threaded Boss****2**

Insert leg supports (2) into sockets making sure threaded bosses are facing same direction.

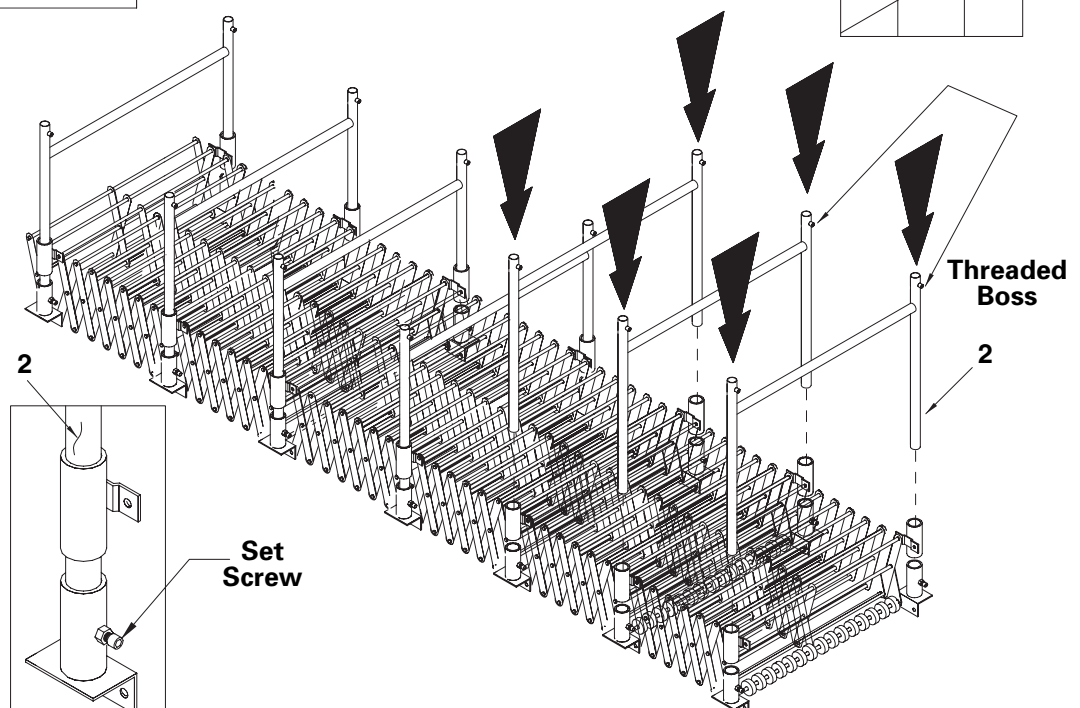
**Threaded Boss****Set  
Screw**

**Portable Flexible  
& Expandable Conveyor**

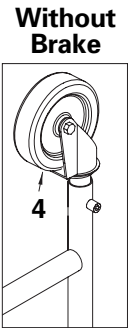
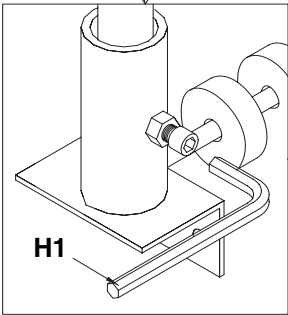
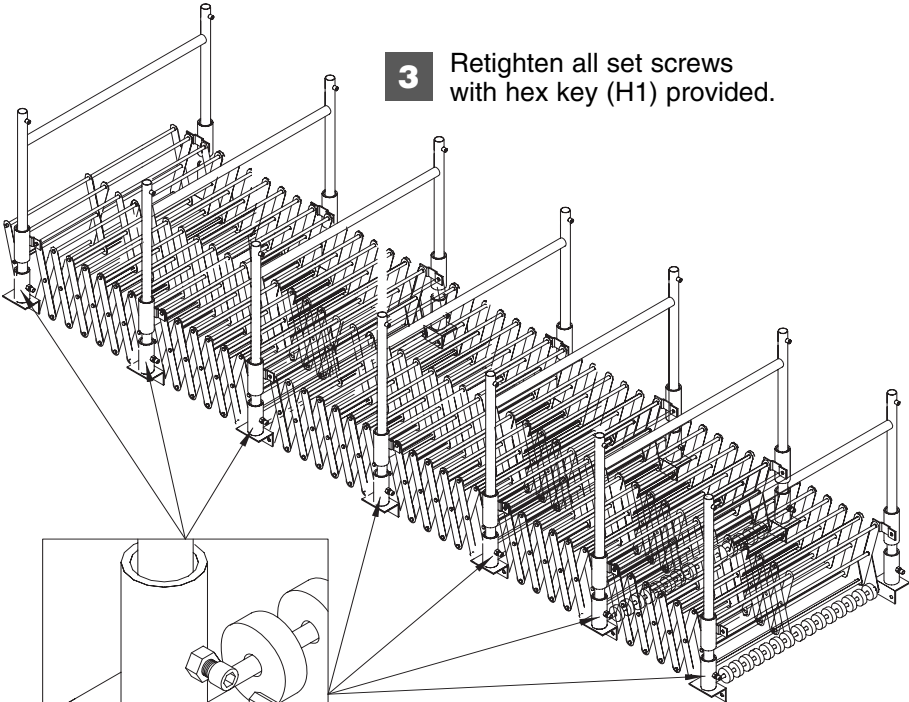

**4** Insert caster leg assemblies (3 & 4) into leg supports.

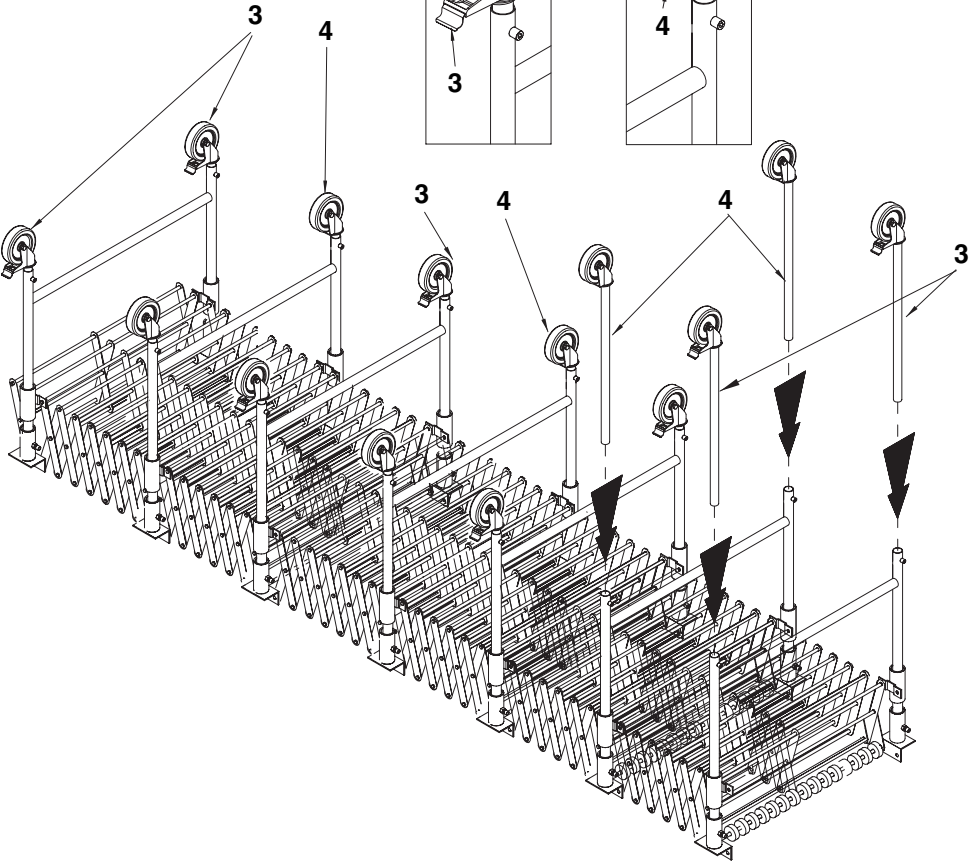



# Portable Flexible & Expandable Conveyor

- 5** Insert and tighten all knobs (H2) into caster posts.

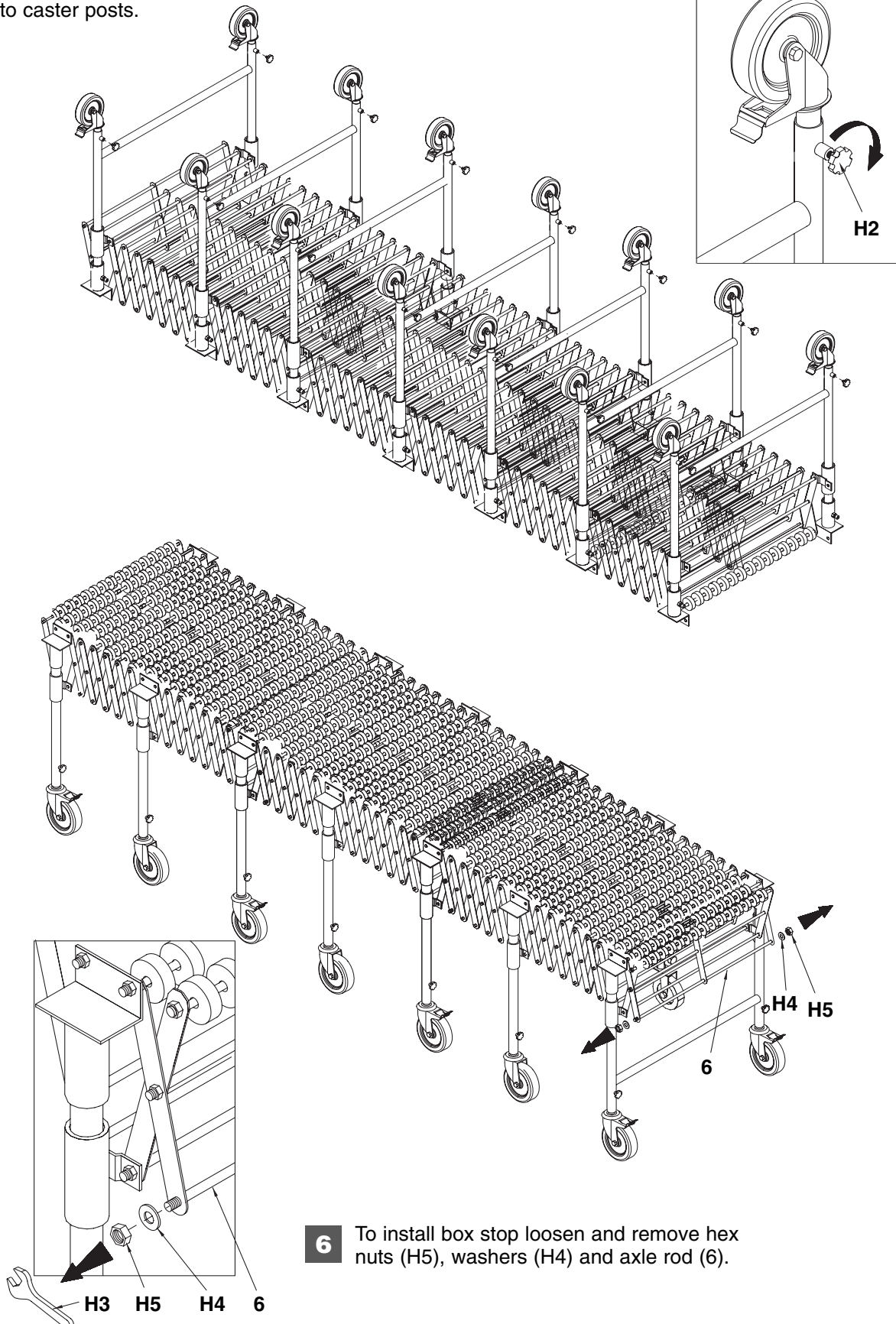

- 6** To install box stop loosen and remove hex nuts (H5), washers (H4) and axle rod (6).

# Portable Flexible & Expandable Conveyor

- 7** Attach box stop handle (5) to end of conveyor. Insert axle rod (6). Replace washers (H4) and retighten nuts (H5) with box wrench provided (H3).

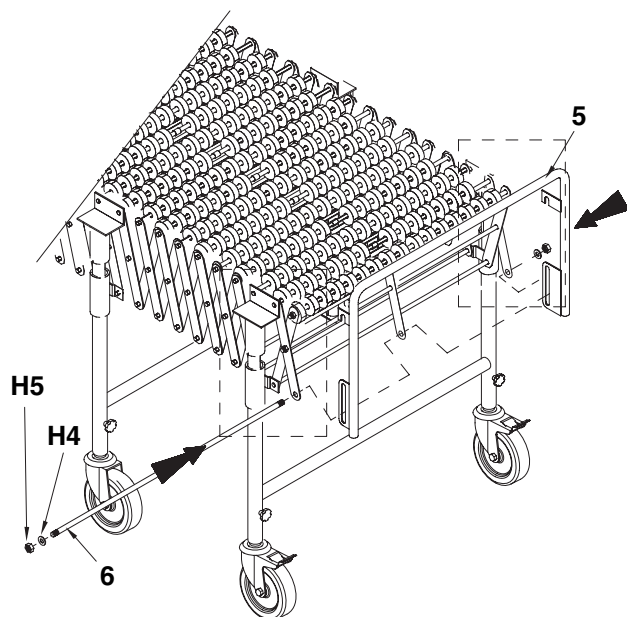

**STEP 1**

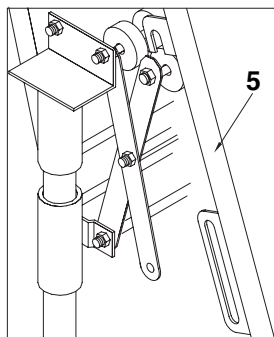

**STEP 2**

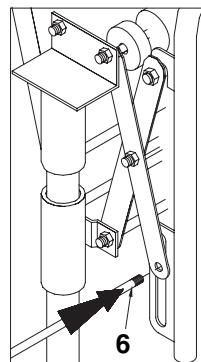

**STEP 3**

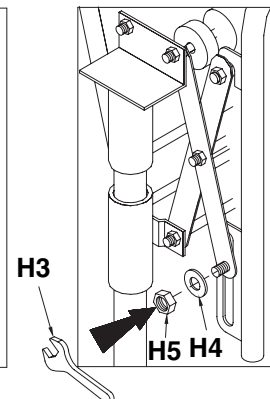

- 8** To use the handle (5) as a box stop, lift the horizontal bar and hook it to the top rod.

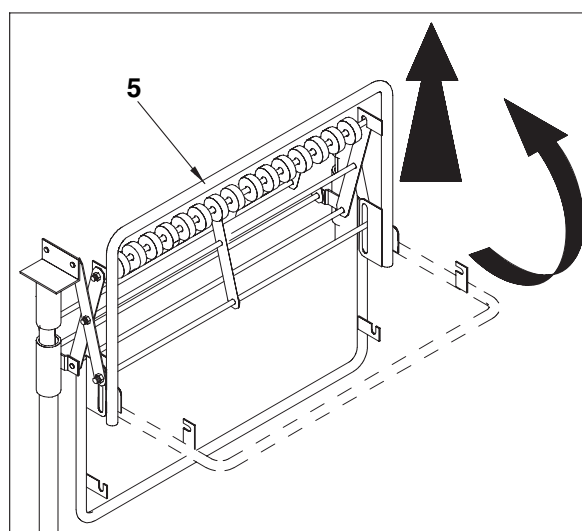

- 9** Set pitch and height as required by adjusting caster legs up or down.

