

# Cardboard Edge Protector Cutter

Replacement blade model no. 244247

## FEATURES

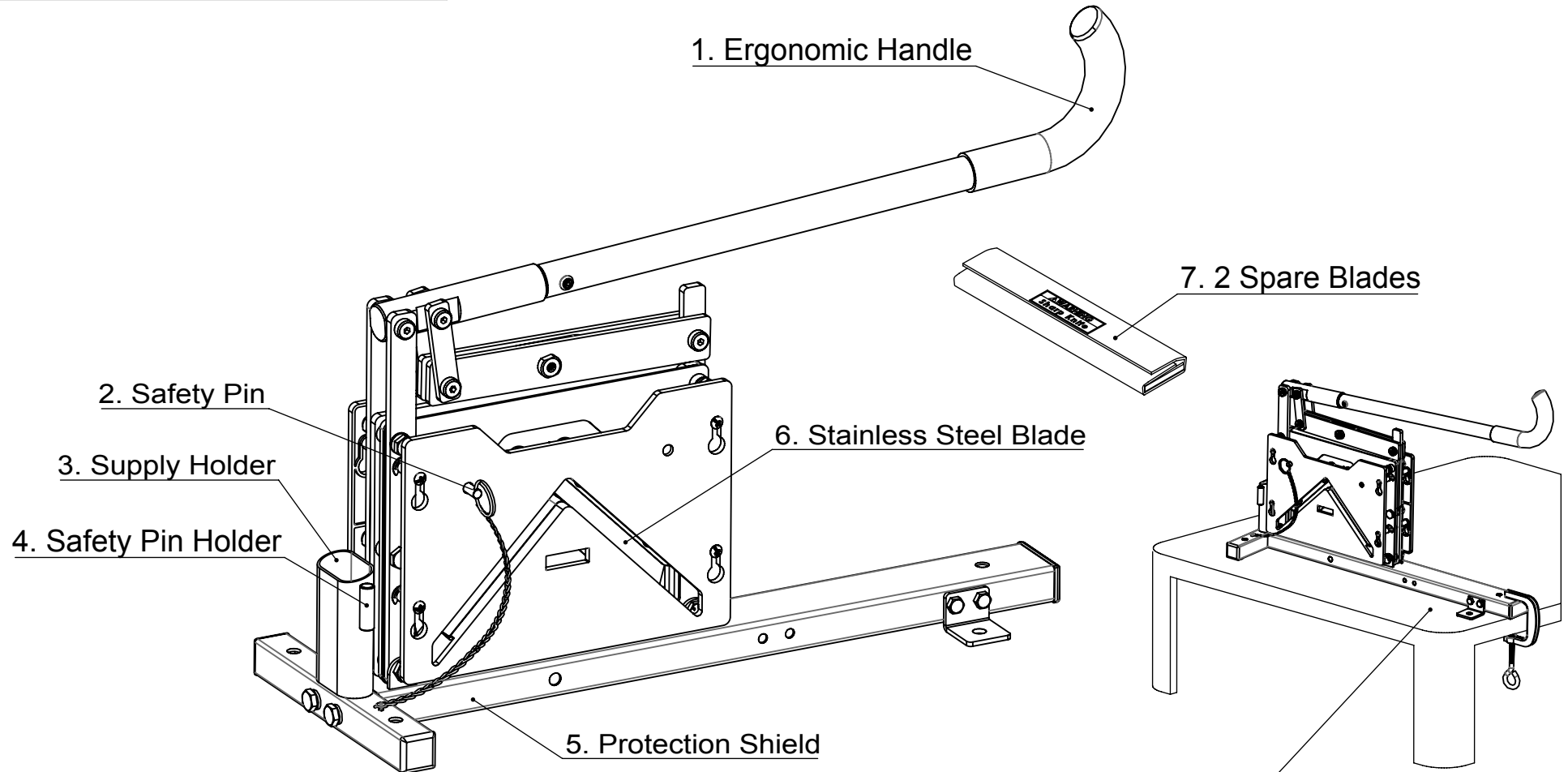

Model no. 244246

# Cardboard Edge Protector Cutter

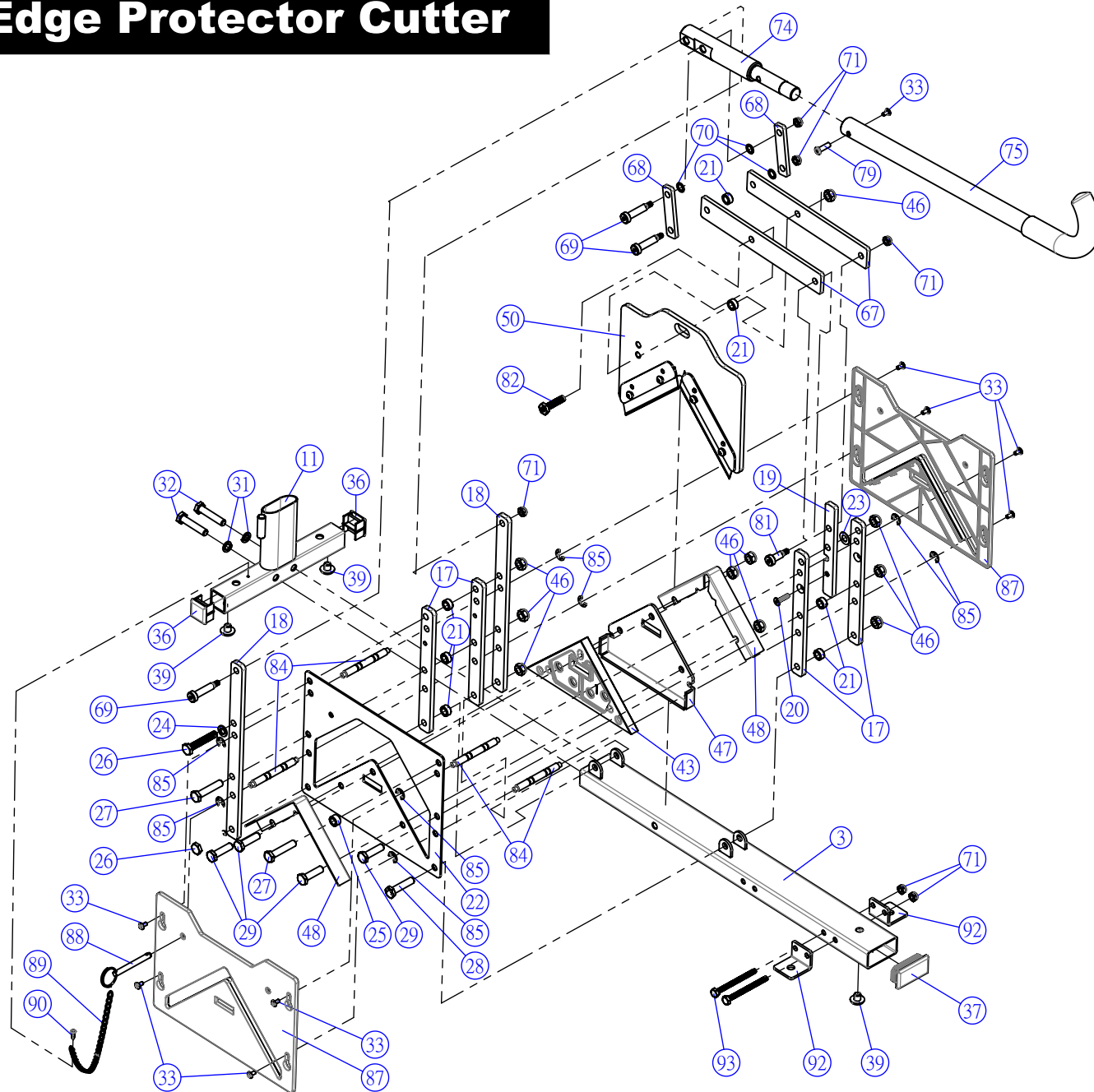

Model no. 244246

# Cardboard Edge Protector Cutter

## 50 Cutter Set

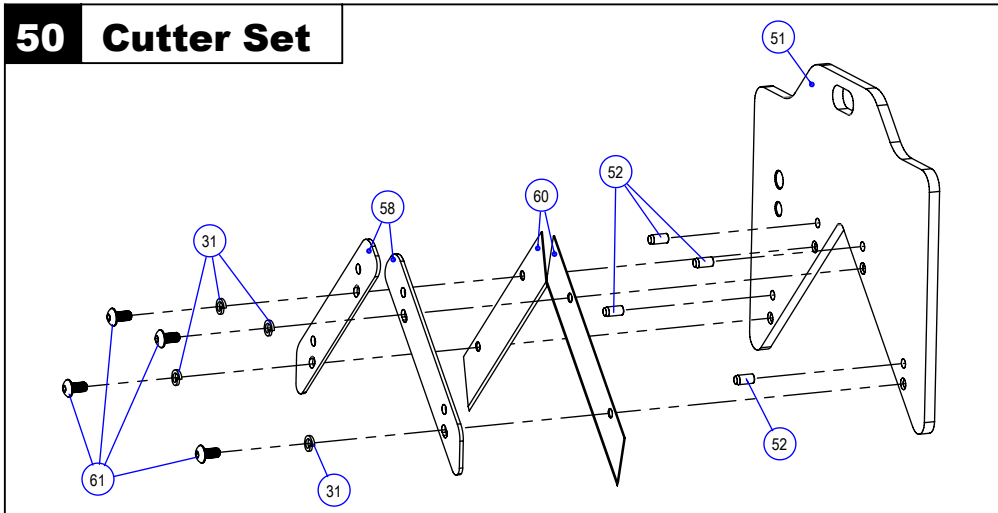

Part No.	Part Name	QTY
31	Washer	4
51	Cutter Base	1
52	Pin	4
58	Cutter Block	2
60	Blade	2
61	Screw	4

Part No.	Part Name	QTY
3	Base	1
11	Supply Holder	1
17	Interval Plate	4
18	Handle Fixed Plate	2
19	Handle Block	1
20	Screw	1
21	Metal Ring	7
22	Fixed Board	1
23	Washer	1
24	Washer	1
25	Nut	1
26	Screw	2
27	Screw	2
28	Screw	1
29	Screw	4
31	Washer	2
32	Screw	2
33	Screw	9
36	Tube End Cap	2
37	Cap	1
39	Slip-resistant Feet	3
43	Cutting Board	1
79	Screw	1
81	Screw	1
82	Screw	1
84	Protection Shield Pillar	4
85	E Ring	8
87	Protection Shield	2
88	Safety Pin	1
89	Chain	1
90	Screw	1
92	Wing	2
93	Screw	2
46	Nut	10
47	Fixed Plate	1
48	Block Plate	2
50	Cutter Set	1
67	Connecting Plate	2
68	Lever	2
69	Screw	3
70	Washer	3
71	Nut	6
74	Handle Head Holder	1
75	Handle	1

Model no. 244246

# Cardboard Edge Protector Cutter

## MAINTENANCE

1. Replace the blades when dull to ensure quality of cutting.
2. Clean the tool with brush or periodically blowing dust or dirt off with clean, dry compressed air.
3. Apply light machine oil to all moving parts regularly.

## BLADE SPECIFICATIONS

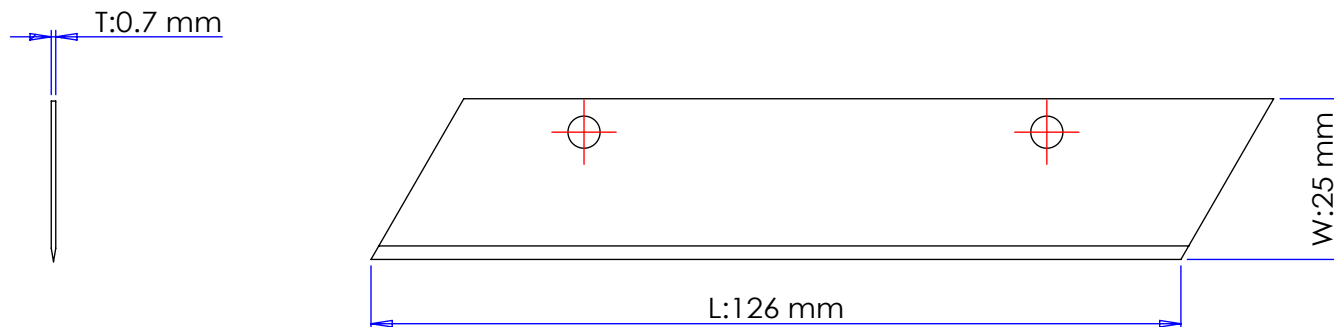

Material: Stainless Steel  
Part No. AC100-63

Model no. 244246

(Include 2 blades in paper cardboard box)

# Cardboard Edge Protector Cutter

## OPERATING INSTRUCTIONS

1

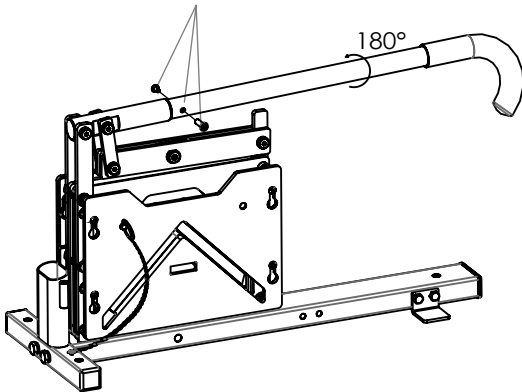

Loosen the screws with a screw driver and a hex wrench. Turn the handle up 180° and tighten the screws back.

2

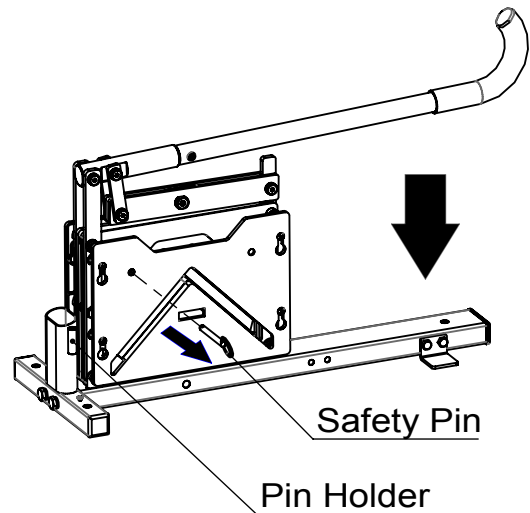

Press the handle down and while at this position, pull the safety pin out. The tool is now ready to work. Keep the safety pin in the pin holder.

3

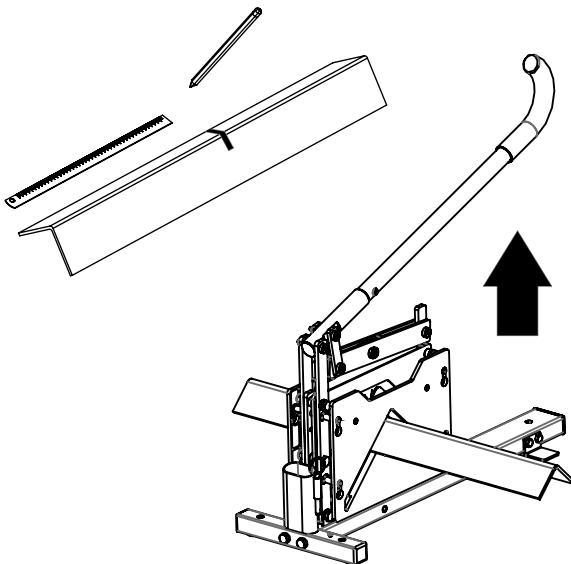

Use a ruler to measure the length you want to cut off. Make a mark there. Lift the handle so the edge protector can be inserted to the cutter slot. Cut the edge protector at the mark you make.

4

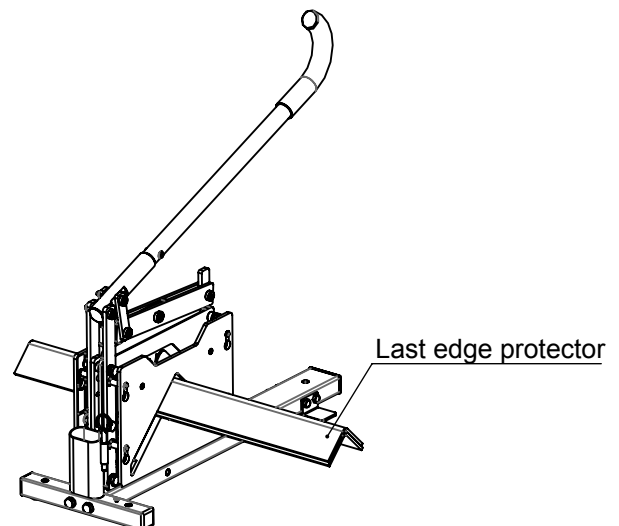

Use and hold the last edge protector as a ruler to measure the length you want to cut off if you want to cut the same size off as last one.

# Cardboard Edge Protector Cutter

## OPERATING INSTRUCTIONS

5

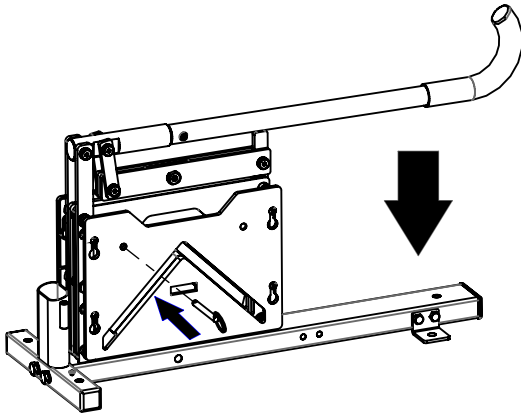

Press the handle down and while at this position, insert the safety pin.

6

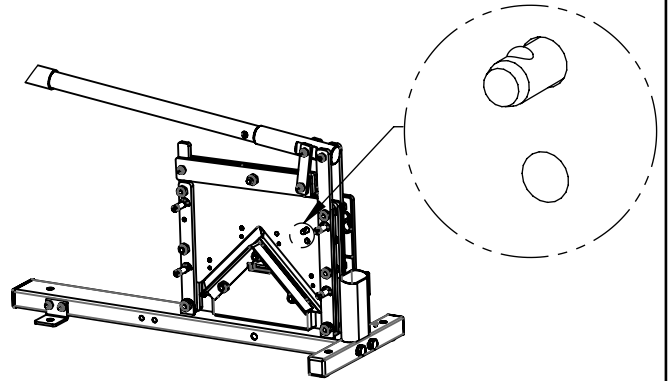

Check the other side of tool. The pin should protrude out of the top hole like shown.

7

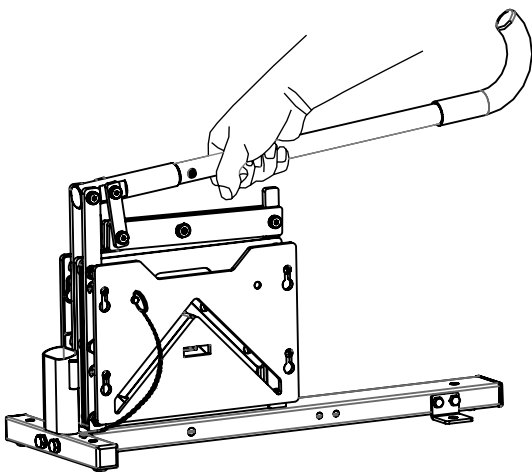

The safety pin now locks the movement of handle. **For safety reason, always lock the movement of handle when not in use.** In this condition, the tool is good for hand carry too.

# Cardboard Edge Protector Cutter

## BLADE REPLACEMENT

1

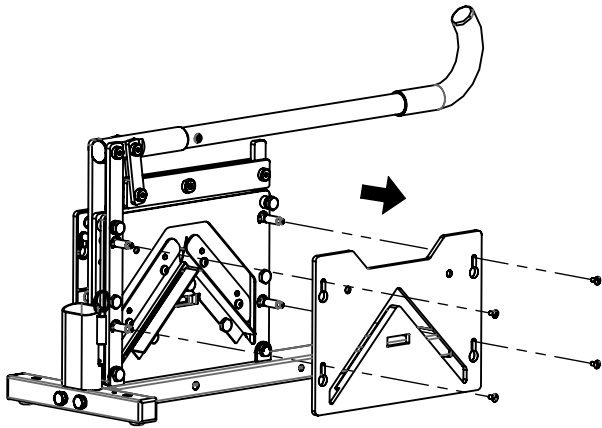

Remove 4 screws and pull the protection shield out.

2

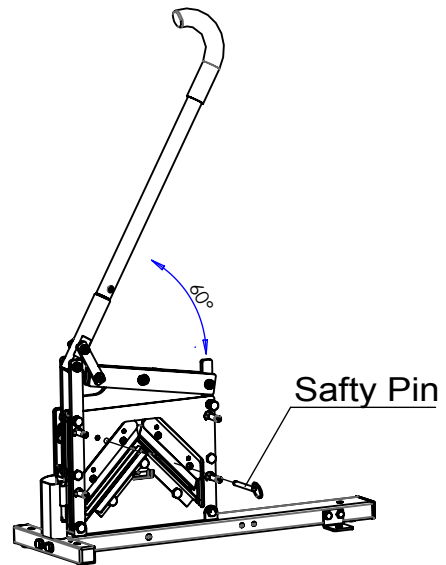

Lift the handle approximately  $60^\circ$  up so the safety pin can be inserted to a hole.

3

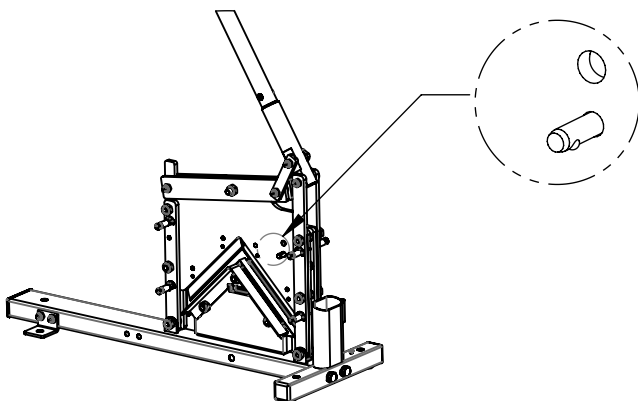

Look at the other side of the tool. **The pin should protrude out of the bottom hole.** The safety pin now blocks the movement of handle. The blades are also away from the cutting board and ready for the replacement.



Keep your fingers away from the sharp blades

4

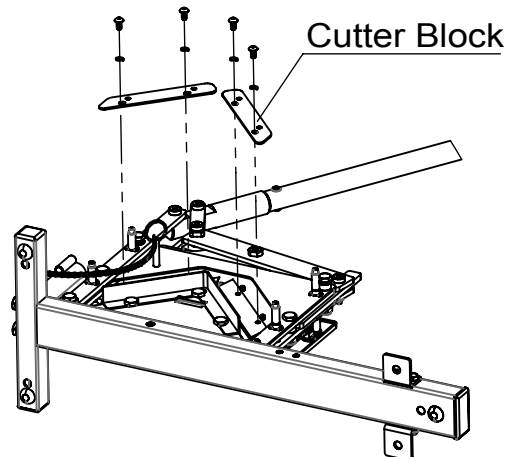

Put the tool down in a horizontal position. Use a hex wrench to free screws and washers. Take away 2 cutter blocks.

# Cardboard Edge Protector Cutter

## BLADE REPLACEMENT

5

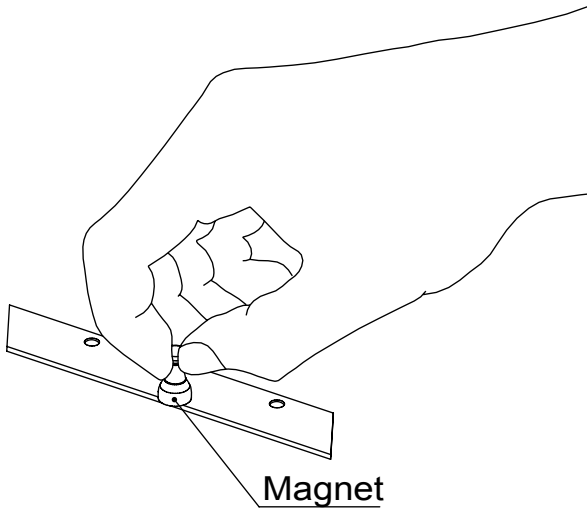

For safety reason, use magnet to hold the new blade.

6

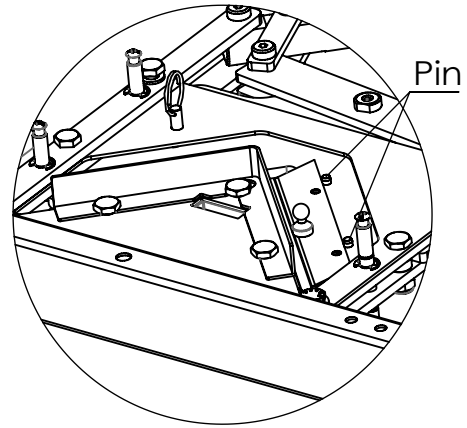

Hold the blade with magnet. **Put the blade against the pins.**

7

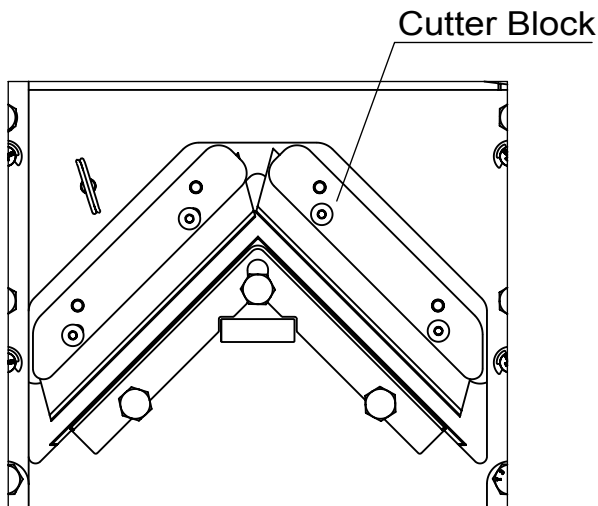

Put the cutter block back. Fasten 2 screws and washers. Repeat the same step to the other side of blade.

8

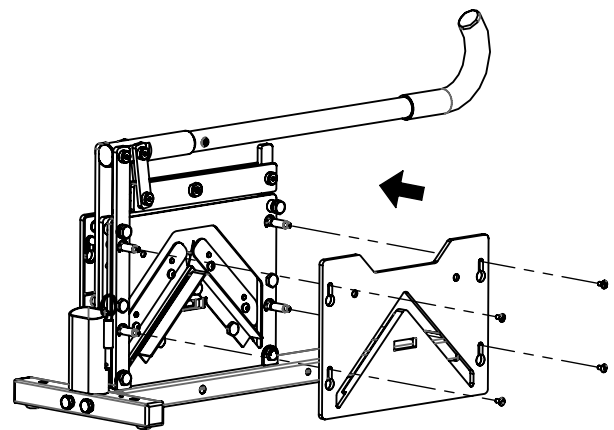

Press the handle down and while at this position, pull the safety pin out. Keep the safety pin in the pin holder. Put the protection shield back as shown. Tighten the 4 screws. Now the cutter is ready for use.



# Cardboard Edge Protector Cutter

## CUTTING BOARD REPLACEMENT

Replace cutting board only when it is damaged or cannot achieve a clean cut to the edge protector while the blades are still good.

1

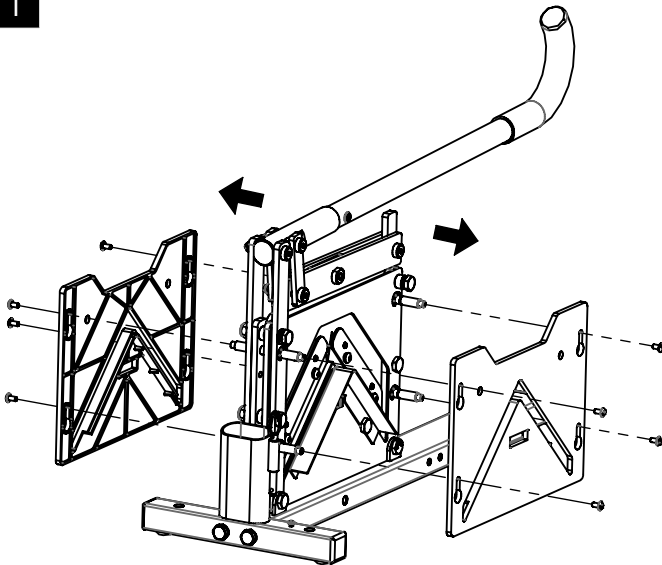

Loosen screws. Remove the protection shield on both sides.

2

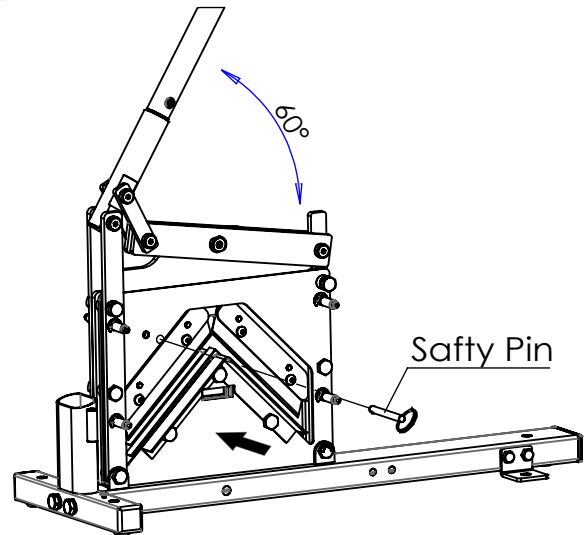

Lift the handle approximately 60° up so the safety pin can be inserted into a hole.

3

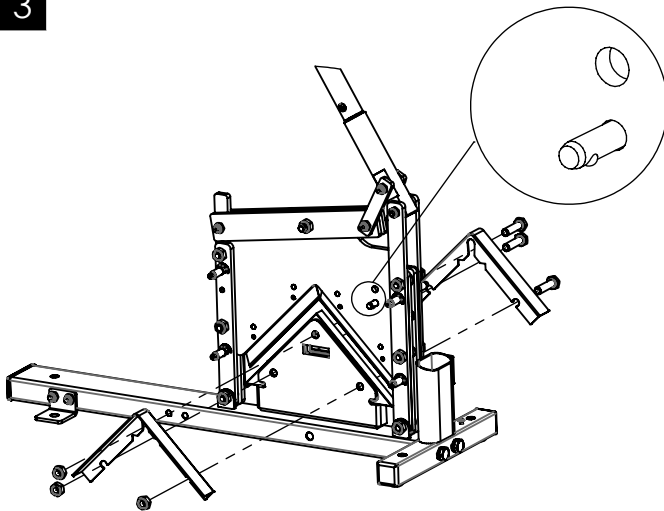

Look at the other side of the tool.  
**The pin should protrude out of the bottom hole.**  
The safety pin now blocks the movement of the handle. The blades are also away from the cutting board. Unscrew 3 bolts, nuts, block plates and fixed plate like shown.



**Keep your fingers away from the sharp blades.**

4

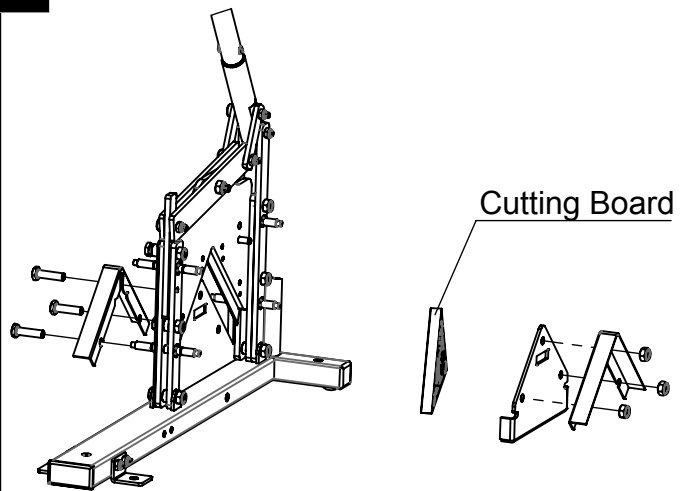

Replace with a new cutting board. Tighten fixed plate, block plates, bolts and nuts back.

# Cardboard Edge Protector Cutter

## CUTTING BOARD REPLACEMENT

5

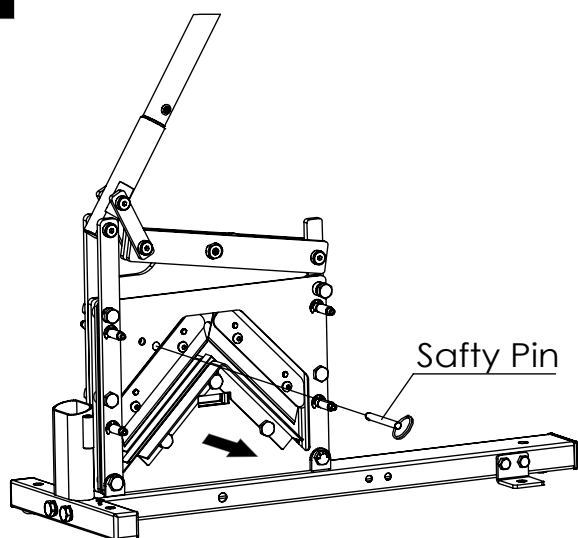

Pull the safety pin out.

6

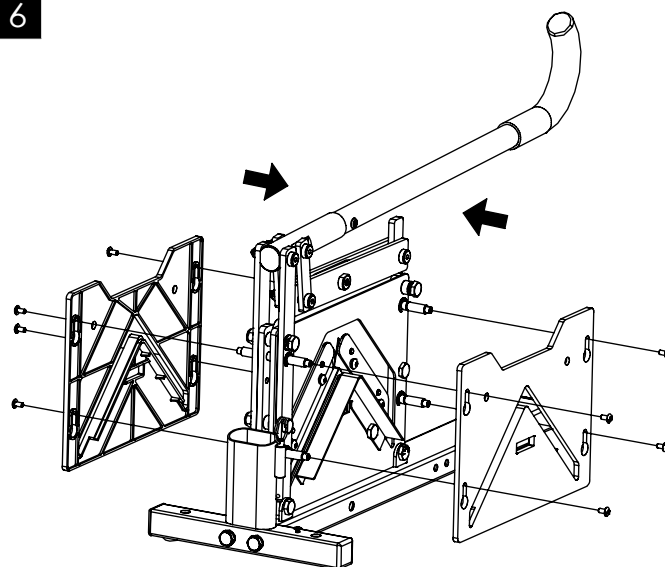

Put down the handle. Install the protection shields back and tighten the screws.

# SAFETY INSTRUCTIONS



1. Before using the tool, read the operating instructions carefully. Not using the tool properly can cause serious injury or death.



2. Always wear eye, and hand protection when operating the tool.



3. Do not put any part of your hands/fingers between the slot while cutting.

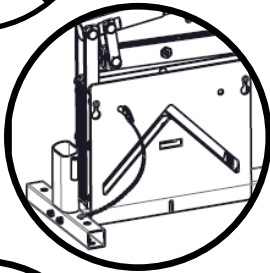

4. Always insert the safety pin to lock the handle when not in use.

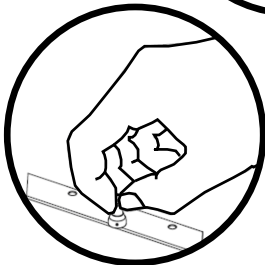

5. Use included magnet to hold and replace the blade.



6. Always use the original replacement parts to ensure quality.



7. Clean the tool with brush or compressed air periodically.

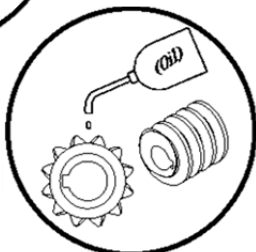

8. Apply light machine oil to all moving parts.