

### INSTALLING & USING OF BATTERY

1. The LED light will flash automatically when the batteries are running out of its power.
2. It's the sign for replace the batteries when the LED light flash itself.
3. It will be much better if you use the standard batteries (DC 6V/AA battery (4pcs)). Do not use new battery with old one together.  
Please follow the directions for use:
  - a. Unscrew the security screw on power supply kit with a screwdriver.
  - b. Unbolt the cover of power supply kit through pressing the handles on both sides.
  - c. Carry new batteries to power supply kit in the direction of "+" and "-".
  - d. Put the power supply kit back into proper location and fix it, then tighten the screw up.

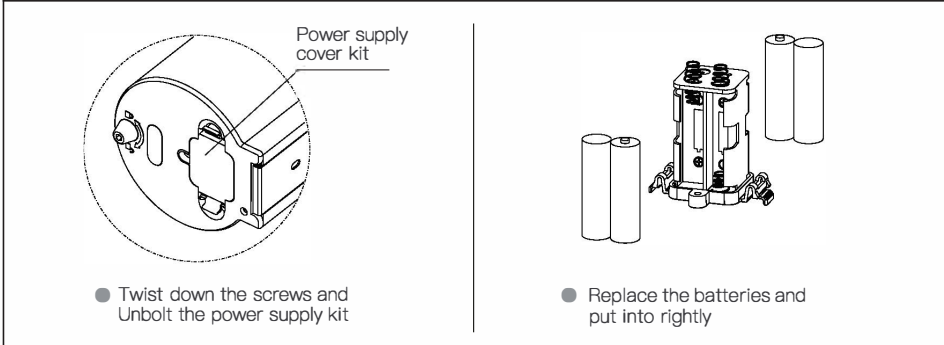

### HOW TO USE

1. Turn the key in the lock and open the top cover.
2. Uncover the inner container and recover it after putting into liquid soap, the surface of the unit should be cleaned if there is liquid soap overflows the storage.
3. Unbolt power supply kit by loosening and twisting down the screws. Load the batteries (DC 6V/AA battery (4pcs)) and put it back. Using screwdriver to lock the kit in the bottom of this unit.
4. Long press the setting button for about 3 seconds, then the LED light on with a flashing, after 3 times flashing will the unit stay in standby, long press the setting button to switch between turning the machine on and off.
5. Following the LED light direction, the foam soap will spray out automatically when you stretch out your hands under the flash sensor reception window.
6. To reach the standard may you have recurrent operations on point 5 when you first used.
7. It's the sign for replace the batteries when the LED light flash itself 3 times in 30 seconds. Once the batteries running out its power change the whole battery for brand-new one.

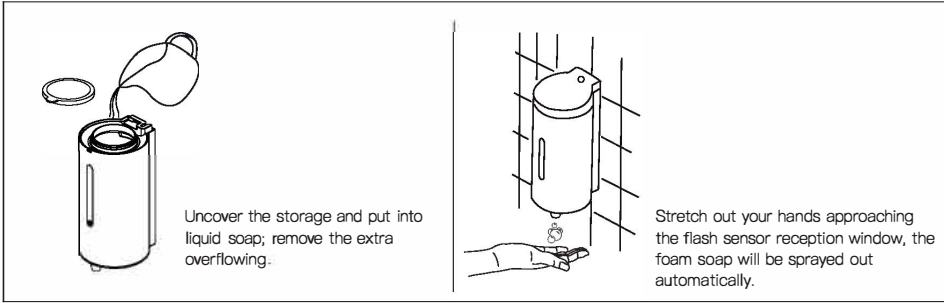

### HOW TO MAKE A SETTING

- After the machine is powered on, please press the setting button for more than 3 seconds and the indicator light flashes for 3 times. The machine will enter the standby state and the liquid output will be automatically adjusted to the factory default setting
- Adjustable liquid soap supply: At the standby status this unit can be set to different 5 level of foam soap supply. The volume of foam soap supply can be changed through slightly pressing the setting button. According to the testing result (using liquid water as object) that the original default is around 0.7ml. Press the setting button changed the original default to level 3 (about 1.0ml, the indicator flashes 3 times), then level 4 (about 1.3 ml, flashes 4 times), then level 5 (about 1.6 ml, flashes 5 times), then level 1 (about 0.4 ml, flashes 1 times). This loop program can be easily controlled by users or managers.

### SIMPLE TROUBLESHOOTING ACTIVITIES

Situation	Causes	Method
LED light doesn't work	Control system trouble	Replace control system
	Power supply problem	Check circuit or battery
	Batteries loose or run out of power	Reload or change new batteries
	Poor contact inner power cable	Recheck inner power cable
	Dirty sensor window	Clean sensor window immediately
LED light flash frequently	Less power supply	Recharge or change batteries (DC 6V/AA battery (4pcs))
	On-going sensor reception	Remove reflective object
No liquid soap supply	Long sensing distance	Insert hands or slowly move hands up & down
	Unqualified machine	Contact regional dealer or contractor
	Supply foam soap within short time	Make an adjustment in the manner intended by manufacturer
Less foam soap supply	Extremely dense liquid	Refill Low dense liquid
	Blocked pipe	Try again or contact qualified person

Note: No impurities and other dirt in the container to avoid blocking. If the unit only supplies fluid instead of foam, please replace the filter element as it is blocked.

### MAINTENANCE & WARRANTY

1. The maintenance is for free charge within 1 year (from the date of invoice).
2. The range of maintenance is exclusive of normal depreciation or any damages caused by improperly using.
3. It's not in the range of maintenance when the unit was fixed and repacked by user or was damaged in operation with unoriginal objects.
4. The manufacturer will take the responsibilities for own products. If the unit is out of warranty, the manufacturer charges only the cost of material in principle and delivers the original objects to the users.
5. There are other situations for repair but charge the cost also:
  - A. Include risks of fire, earthquake, flood and other forces of nature.
  - B. Be damaged by improperly installation & program debugging or connect the power supply kit into improper terminal block location.
  - C. Improper using & maintenance or using in seriously bad environment caused problems of this unit.
  - D. Damages are caused by wrongly move and refit or repaired by unqualified person.
  - E. Liquid soap supply kit is blocked by gelatinous precipitation or other objects.
  - F. No warranty card or warranty card has lost the rights.
6. By keeping the warranty card and other certifications can make sure the rights of you for free services. All information needs to be provided to the dealer or contractor when you repair this unit.

## Automatic Foam Soap Dispenser

### USER MANUAL

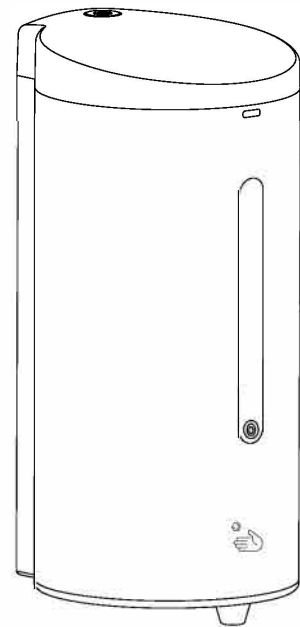

Model no. 641521

### CAUTION & IMPORTANT SAFETY INSTRUCTIONS

- CAUTION:**
1. Do not delivery heavy strength on this unit because there are small components and solenoid valves as inner structure.
  2. All surfaces of this unit should be cleaned with a soft cloth and a noncaustic cleaning solution. Then wipe extra cleaning solution & dirt out with wet cloth, and then dry the unit with soft cloth. Do not clean this unit by showering or using nonstandard cleaning solutions. To keep this unit working in best condition please don't do anything that will do harm to the sensor window.
- READ AND KEEP THESE INSTRUCTIONS**
- SAFETY PRECAUTIONS**
- WARNING-TO REDUCE THE RISK OF INJURE TO PERSONS OBSERVE THE FOLLOWING:**
- This appliance is not intended for use by children (to protect them from eating liquid soap), unless they have been guided by a person who is responsible for their safety.
  - To protect the environment please make sure the exhausted battery is disposed in an environmental friendly and healthy way. By collecting and recycling waste, this exhausted battery has to be disposed at an authorized place.
  - This unit has been designed with microcomputer & electronic circuit and so on. Do not immerse the appliance in water or other liquid.

- TO MAKE SURE THE APPLIANCE DO WORK AND EXTEND ITS LIFESPAN UNDER THE GOOD CONDITION, PLEASE NOTICE THAT:**
1. The instructions must be followed carefully when installing this unit.
  2. Using the same AA battery (4pcs) of well-known brand. If the power supply doesn't work well, it may do harm to the unit and make short lifetime of this appliance.
  3. When installing into wall, do check the wall is flat or not, cleans the surface of wall at the same time.
  4. Distance (more than 25cm) will be needed from the bottom of unit to tables or other objects.
  5. The instructions of installation will be given to the user or manager by qualified person.
  6. Reflective objects must not be put in the sensing distance under the unit.
  7. Don't cover with reflective objects on the table against the bottom of this unit. If the unit stops or works strangely please check it around and make sure there are reflective objects (such as mirror, stainless steel or other things) be wrongly placed.
  8. Indoor use only, do not use outdoor.

### SPECIFICATIONS

Voltage	DC6V/ AA Battery (4pcs)	Supply	0.4~1.6ml(five-order adjustable)
Volume	700ml	Sensing distance	5-9cm
Ambient temperature	0~45℃	Material	304 stainless steel
Appearance size	100x110x227mm	N.W	1.1kg

- SERVICE TIPS:**
- Please make sure the following items are included with your automatic dispenser when you open it the first time. If any items are missing or if there are any problems about the objects, contact your regional dealer or contractor.
  - Any specification of the items changed might be not informed in time. If there are any difficulties in installation, please contact your regional dealer or contractor.
  - Main objects are sealed by special bag. Don't hit or drag too heavy when you move or open the bags.

### PACKING LIST

Automatic foam soap dispenser	X1	ST5X25 screws kit	X3	Manual	X1	Key	X1
Wall mount kit	X1	Plastic nail-head	X3	Certification	X1		

### SKETCH MAP IS FOLLOWING

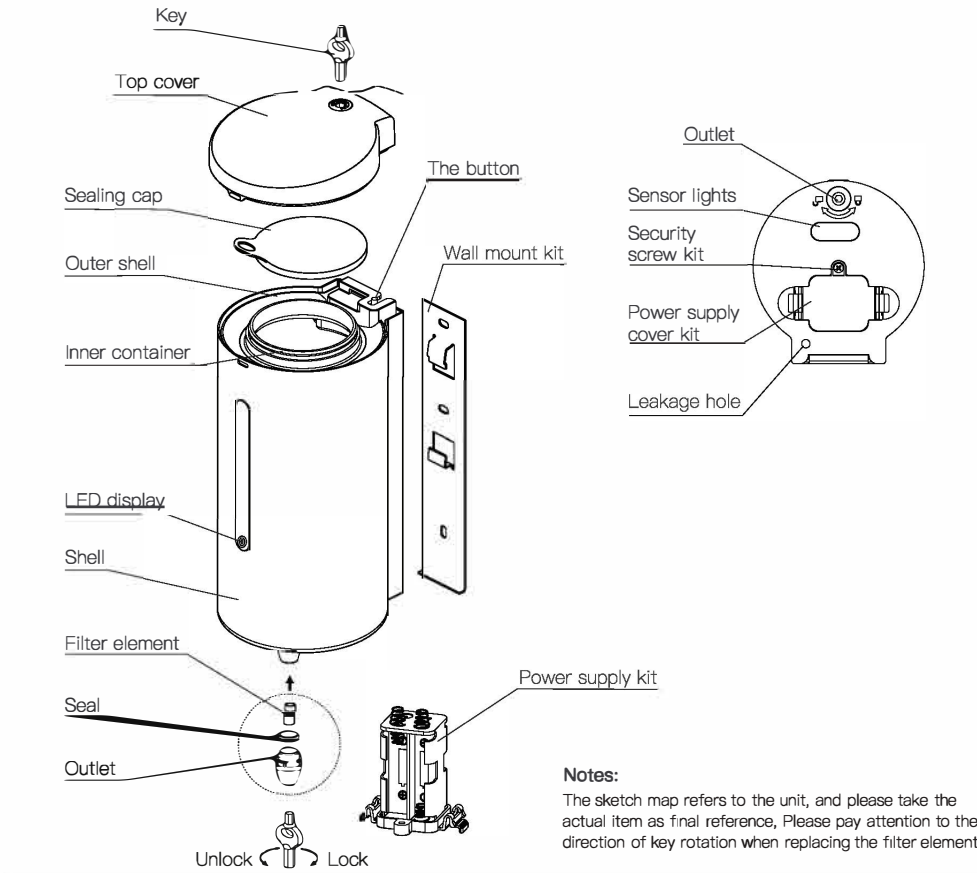

### SKETCH MAP OF INSTALLATION

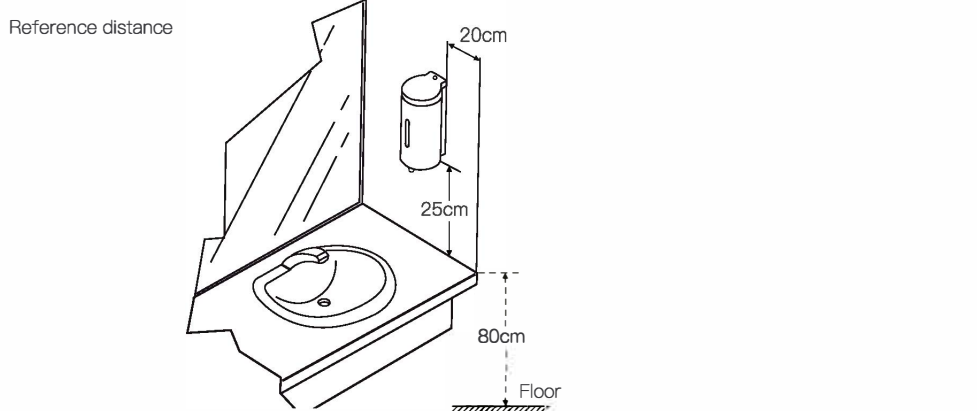

### INSTALLATION STEPS

1. Wall mount kit shall be put in the manner intended by manufacturer. Use pencil to mark the position of the hole.
2. Use a drill to bore three holes (φ6) in the wall according to the marks. Put plastic nail-heads into the corresponding holes.
3. Screws will be matched with plastic nail-heads in the wall, fix them together with wall mount kit.
4. Tilting the dispenser at a slight angle is helpful for insertion. Hook up dispenser with right direction and press (in order: up-press). Make sure the dispenser is stable by hooking up with the wall mount kit.
5. Push down slightly on the dispenser. Then the dispenser and the wall mount kit hook up tightly.