

www.globalindustrial.com  
1-800-645-2986

# KD BIN CABINET ASSEMBLY INSTRUCTION

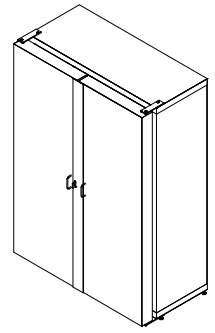

CONTENTS			CONTENTS			CONTENTS		
REF.	QTY.	DESCRIPTION	REF.	QTY.	DESCRIPTION	REF.	QTY.	DESCRIPTION
1	1	BOTTOM	H1	4		H7	2	
2	1	BACK PANEL	H2	80		H8	2	
3	1	LEFT SIDE PANEL	H3	80		H9	4	
4	1	RIGHT SIDE PANEL	H4	4		H10	4	
5	1	TOP	H5	4		H11	1	
6	4	FRONT STIFFENER	H6	4				
7	1	LEFT DOOR						
8	1	RIGHT DOOR						
9	2	HANDLE						

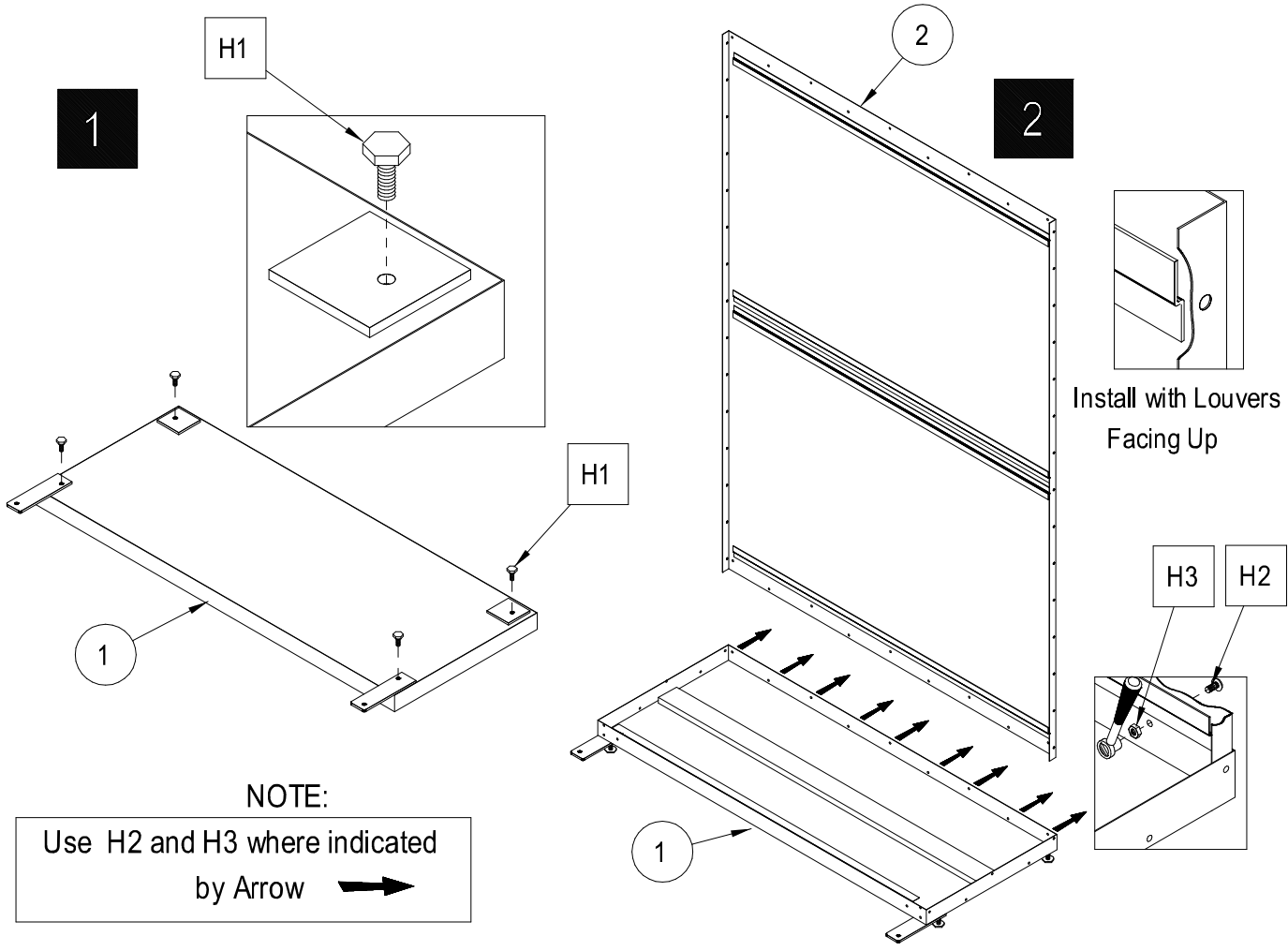

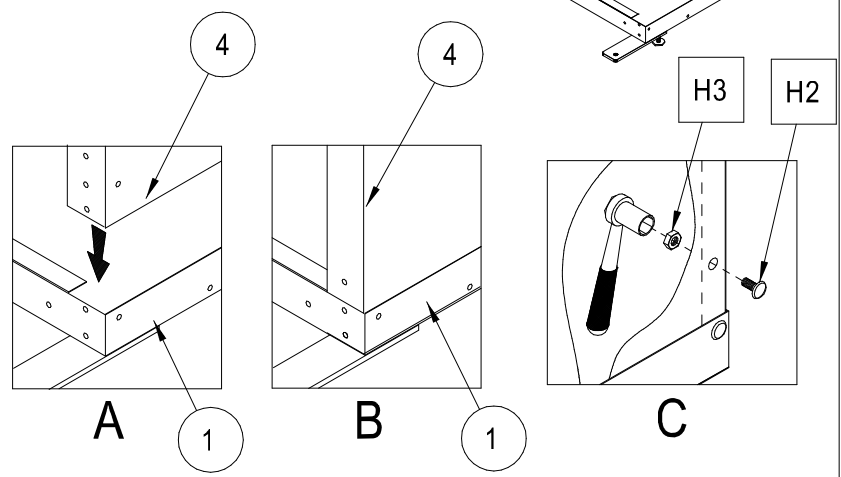
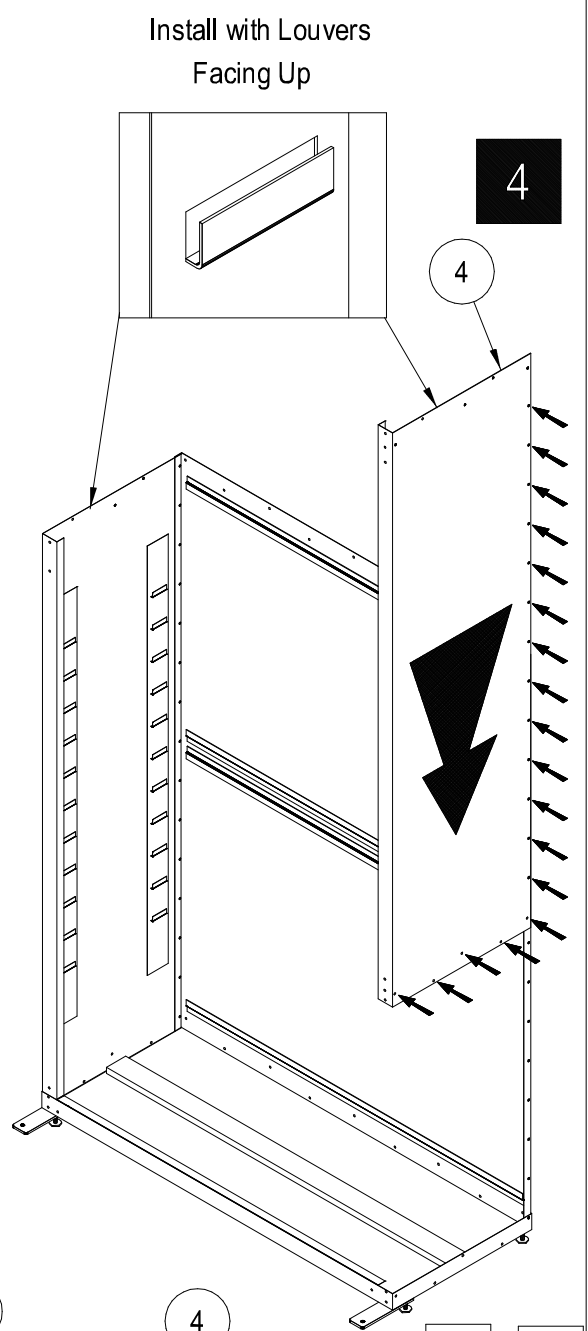
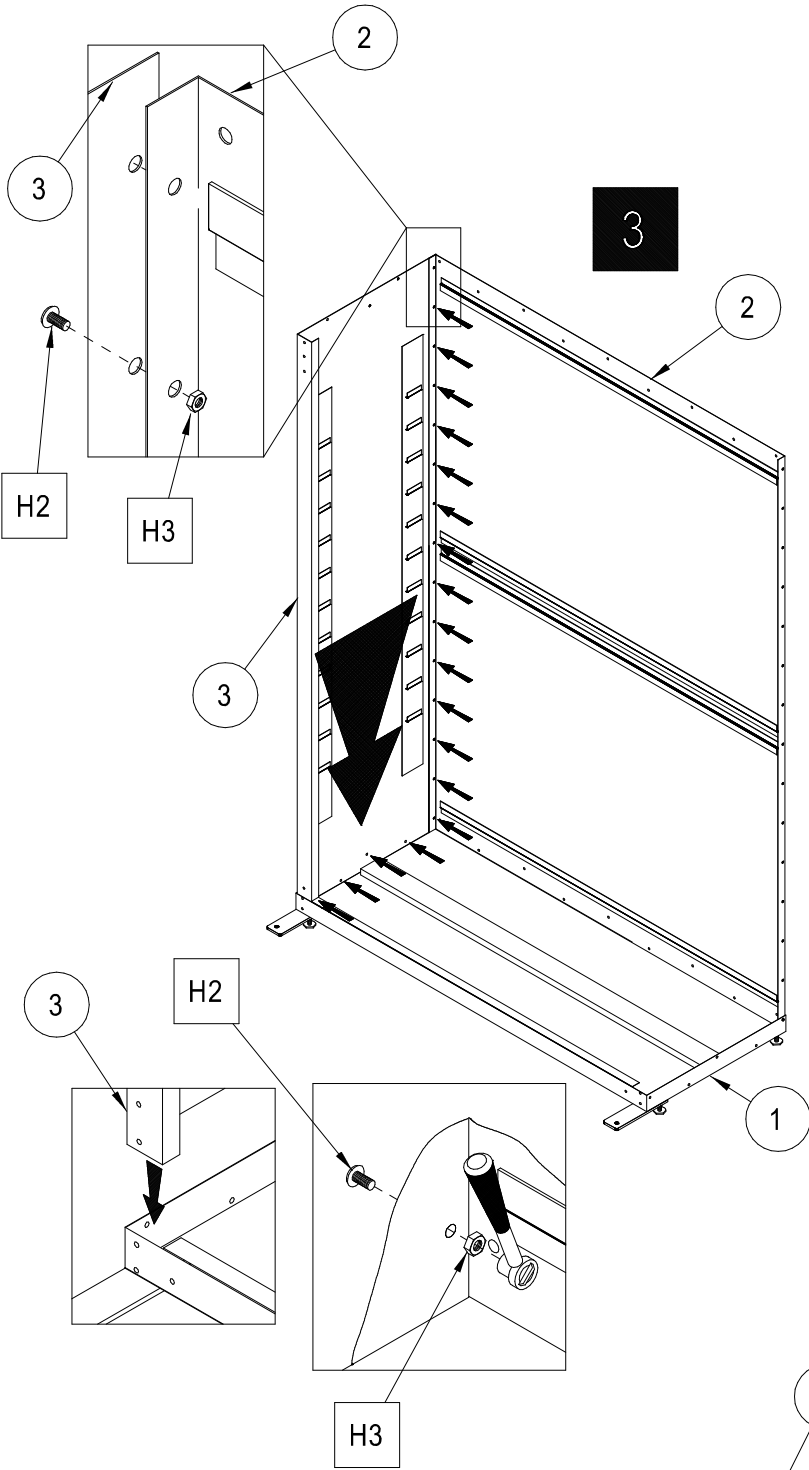
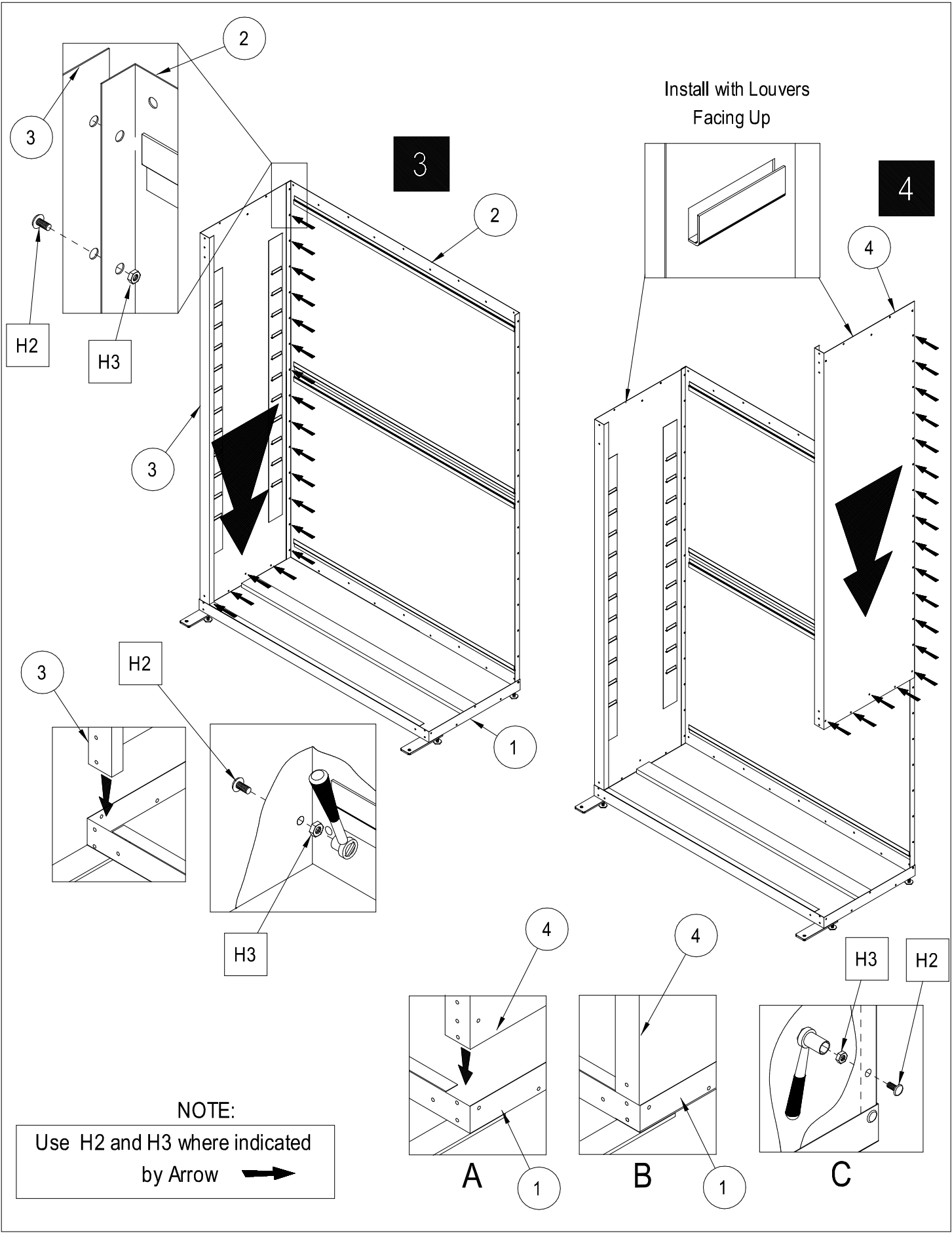

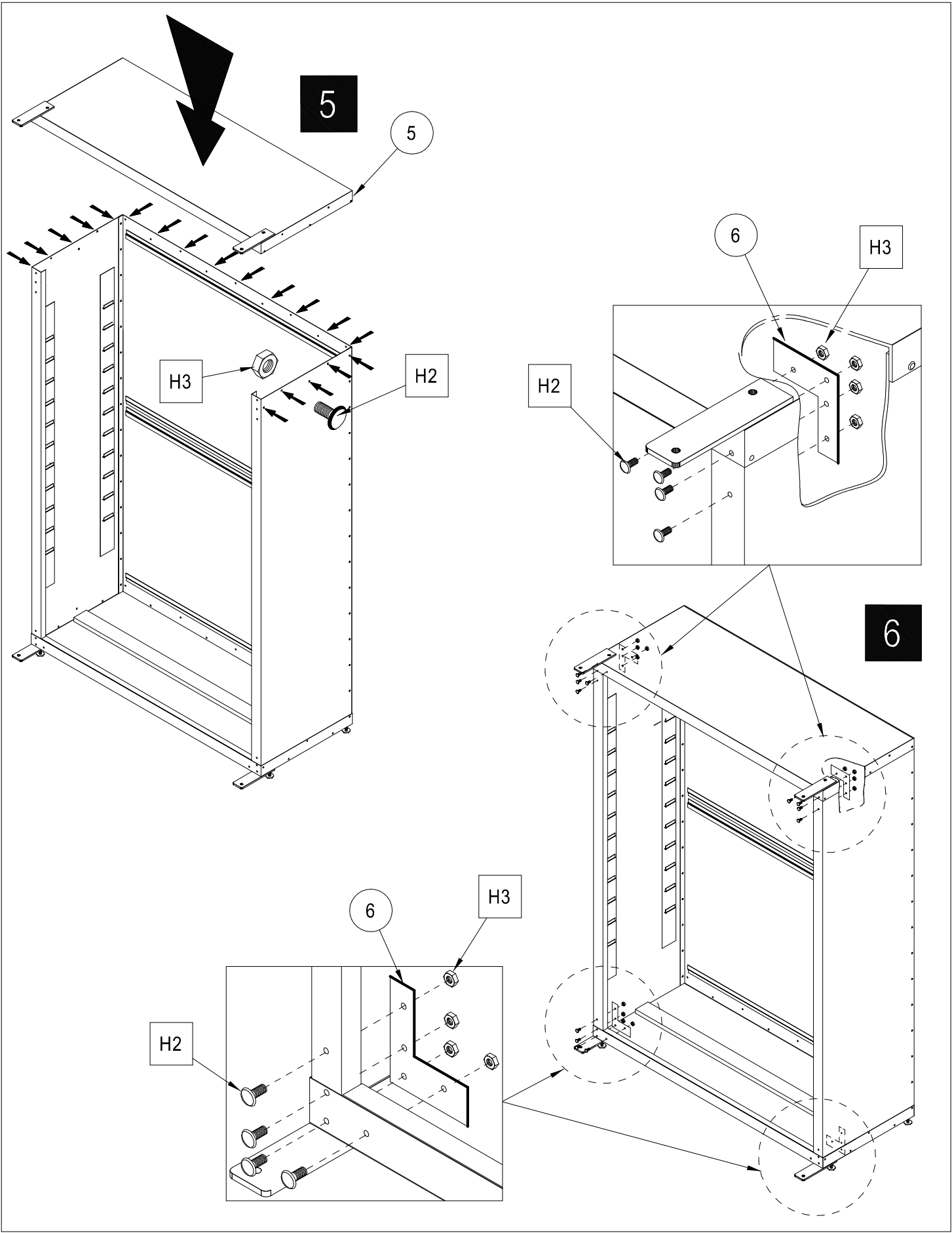

7

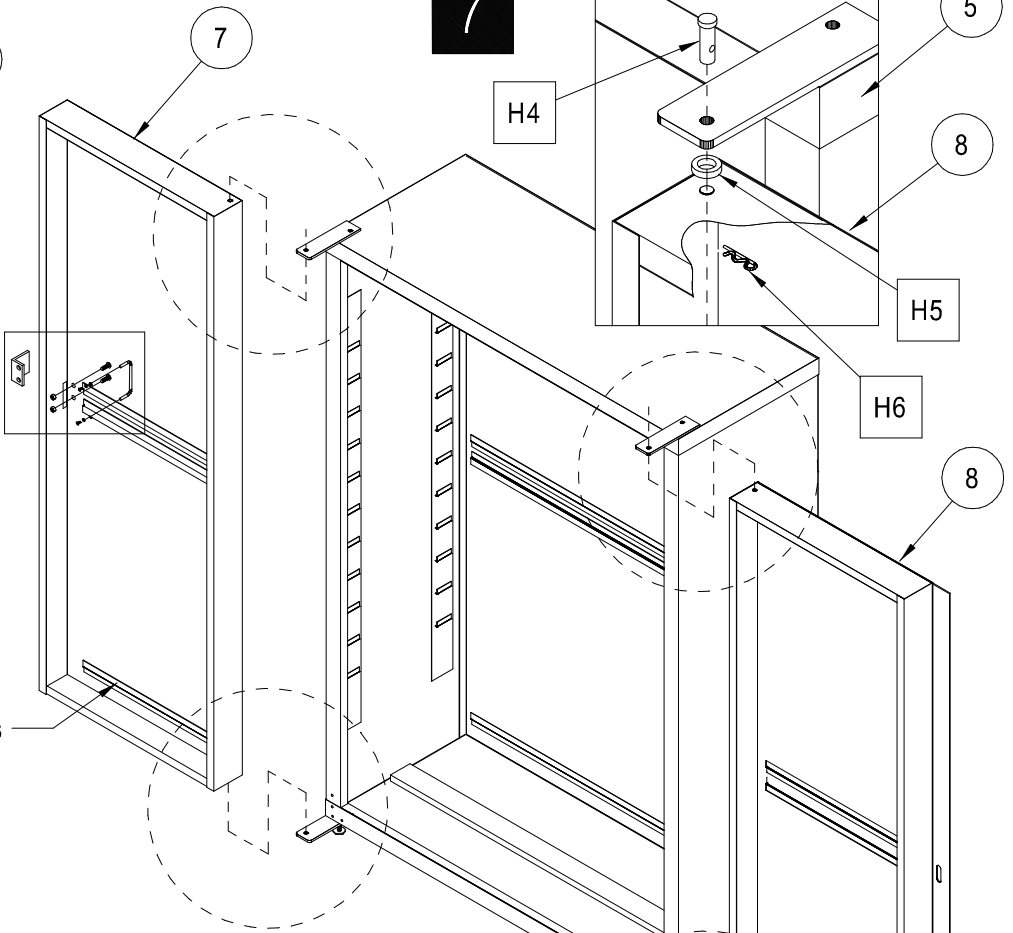
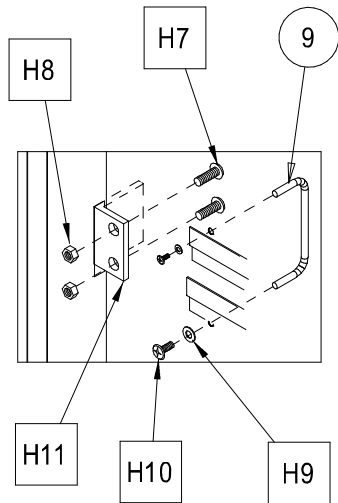

Install with Louvers Facing Up

Install with Louvers Facing Up

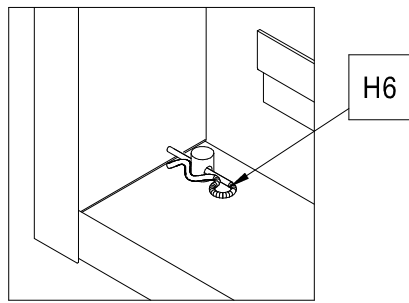
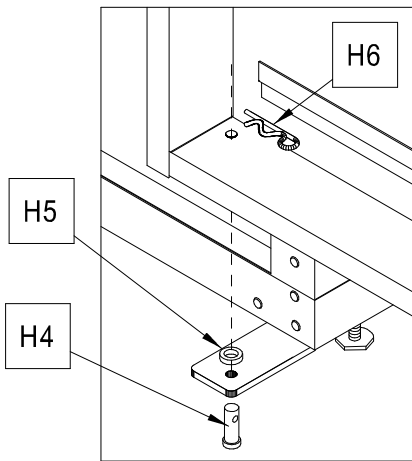

8

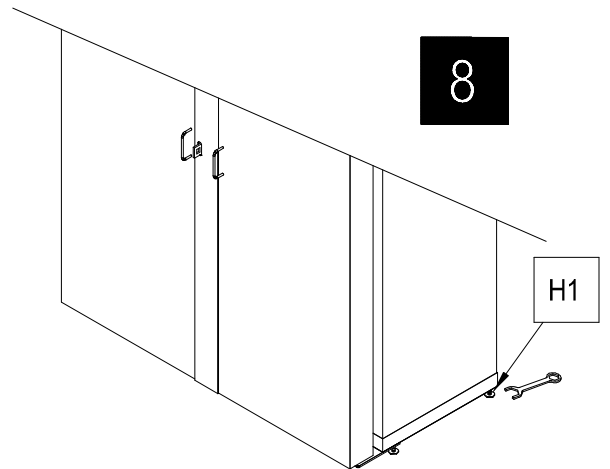

Adjust H1 Screws to Level Cabinet

Make Sure All Hardware is Properly Tightened and Secure Before Use



www.globalindustrial.com  
1-800-645-2986

# KD BIN CABINET SHELF INSTALLATION

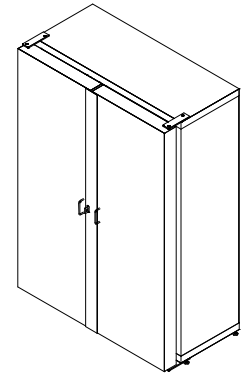
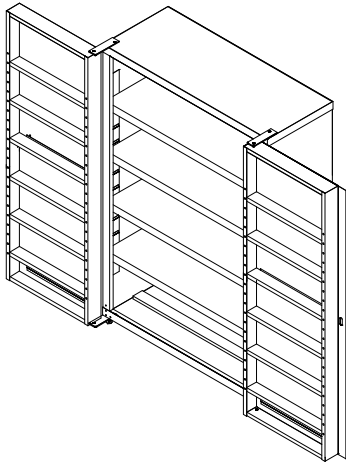

CONTENTS		
REF.	QTY.	DESCRIPTION
1	4	CABINET SHELF
2	12	DOOR SHELF
H1	24	
H2	24	

CABINET SHELF INSTALLATION

DOOR SHELF INSTALLATION

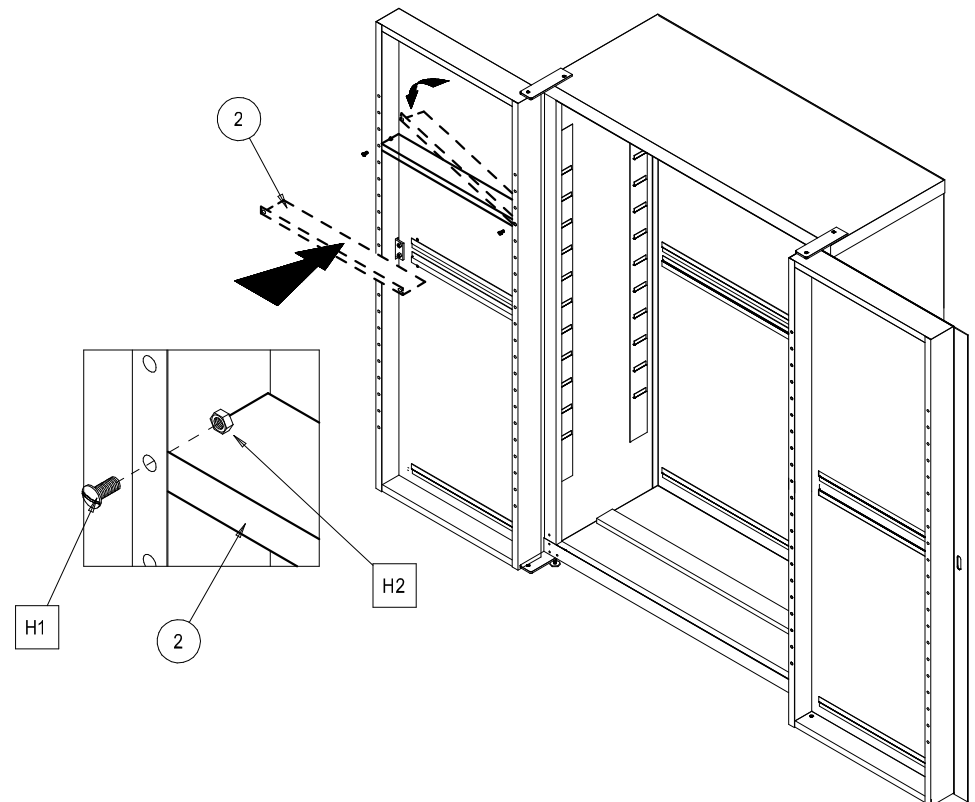
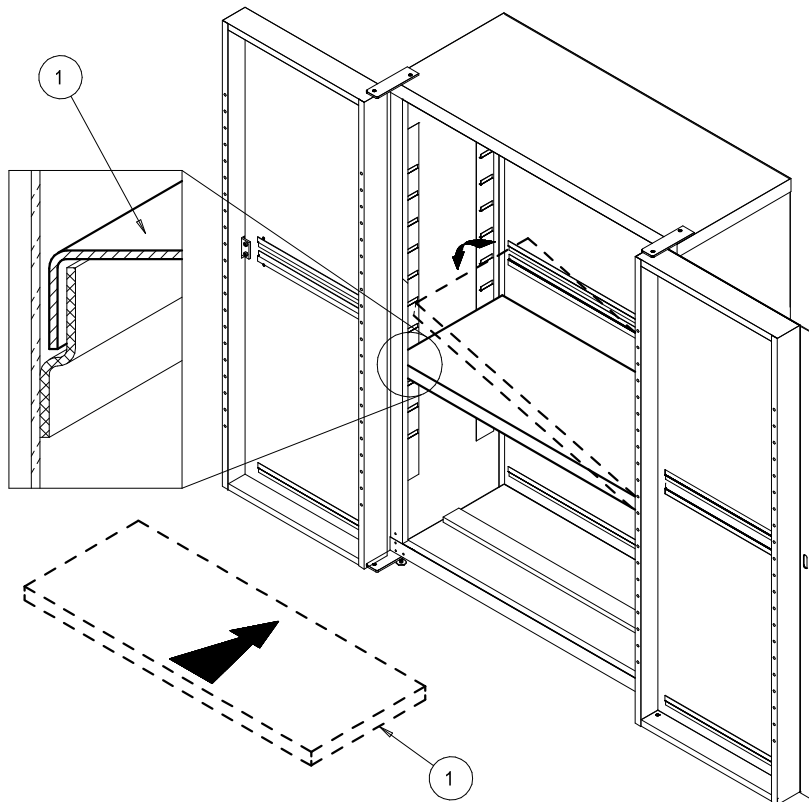



www.globalindustrial.com

1-800-645-2986

# THE ORGANIZER HEAVY - DUTY CABINET ASSEMBLY INSTRUCTION

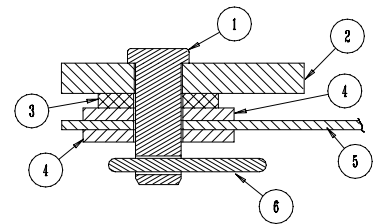

REF	DESCRIPTION
1	3/8" x 1" L CHAMFERED END ZINC PLATED CLEVIS PIN (USE PIVOT POINT CP-142 OR SIMILAR)
2	EXISTING 1/4" THK. STEEL PLATE
3	EXISTING 3/8" NYLON WASHER
4	1.25 OD x .406 ID x .1 THK ZINC PLATED STEEL WASHER (2 REQ'D PER HINGE LOCATION)
5	TOP EDGE OF EXISTING STEEL DOOR
6	5/32 x 1" L ZINC PLATED STEEL EXTENDED PRONG COTTER PIN

1

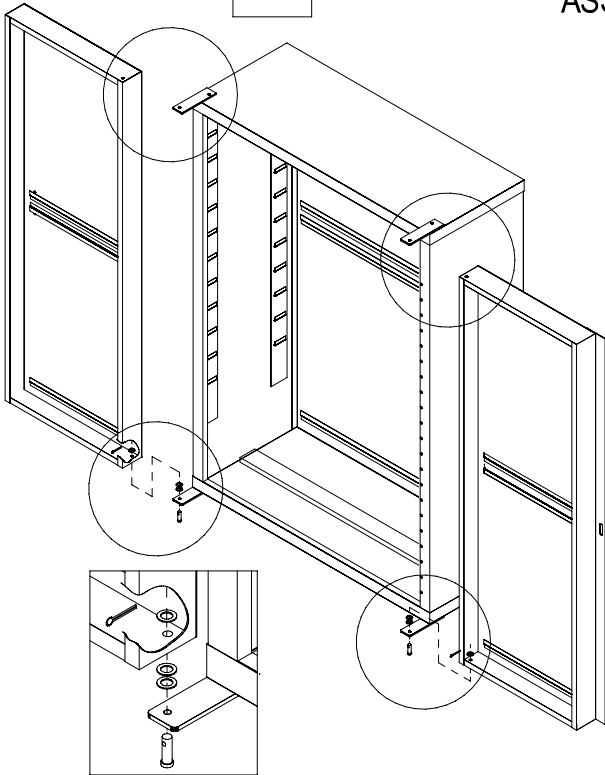

2

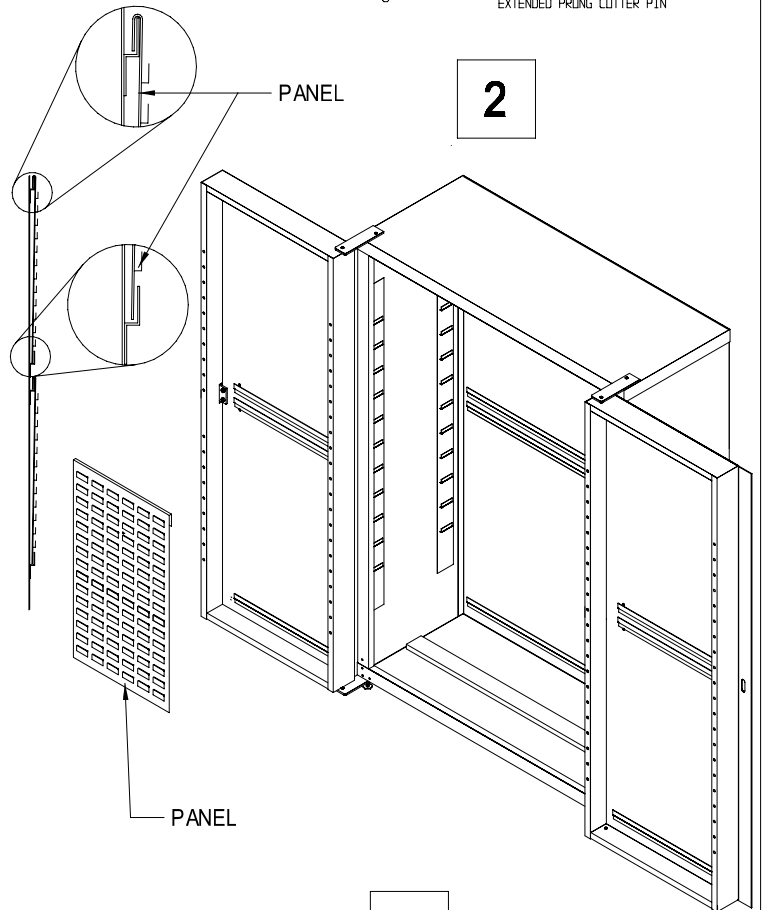

3

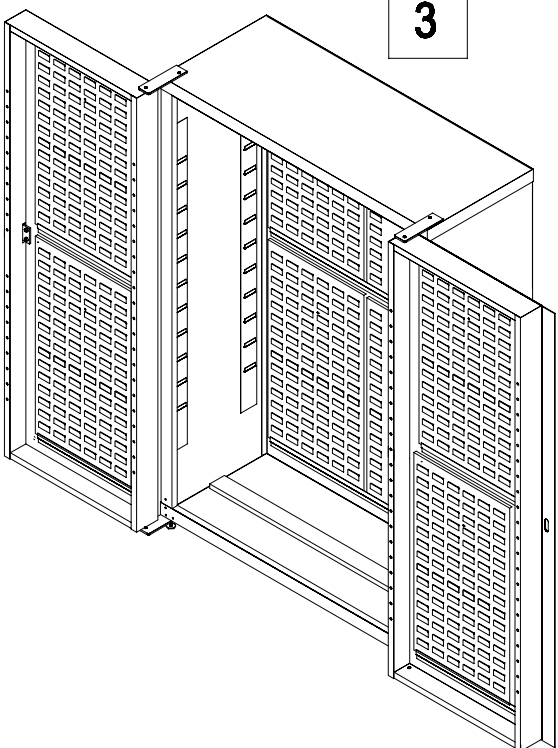

4

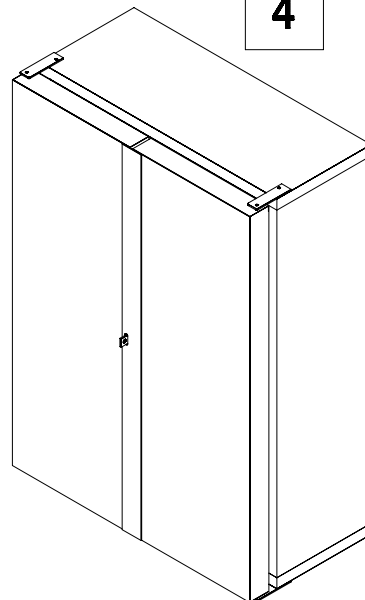

# THE ORGANIZER HEAVY - DUTY CABINET

## ASSEMBLY INSTRUCTION

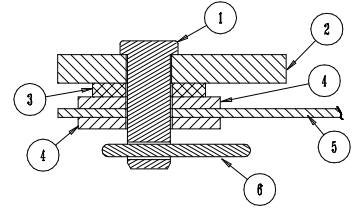

REF	DESCRIPTION
1	3/8 x 1" L CHAMFERED END ZINC PLATED CLEVIS PIN (USE PIVOT POINT CP-142 OR SIMILAR)
2	EXISTING 1/4" THK. STEEL PLATE
3	EXISTING 3/8" NYLON WASHER
4	1.25 OD x .406 ID x .1 THK ZINC PLATED STEEL WASHER (2 REQ'D PER HINGE LOCATION)
5	TOP EDGE OF EXISTING STEEL DOOR
6	5/32 x 1" L ZINC PLATED STEEL EXTENDED PRONG CUTTER PIN

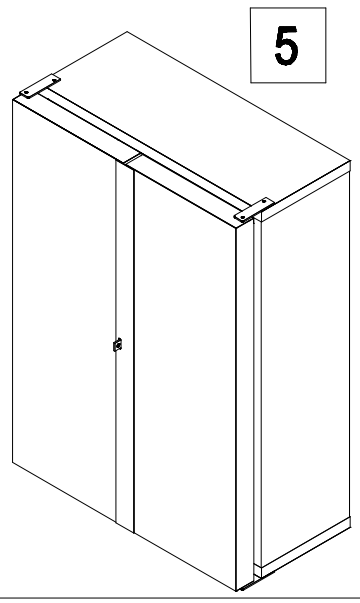
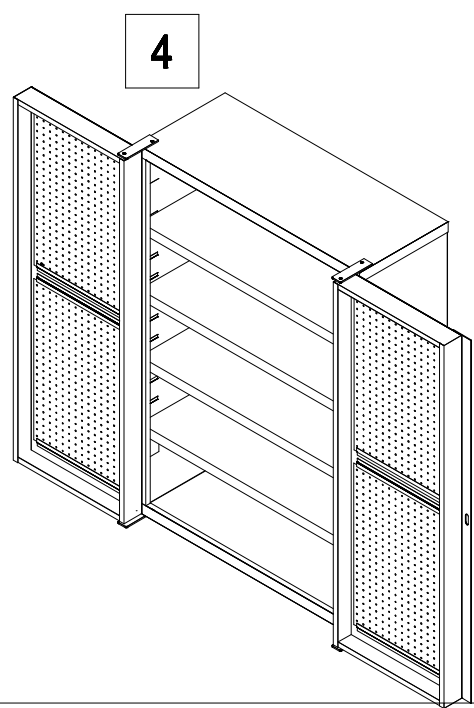
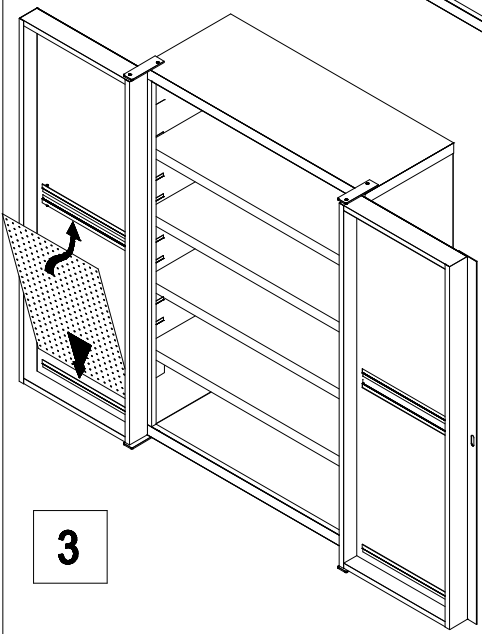
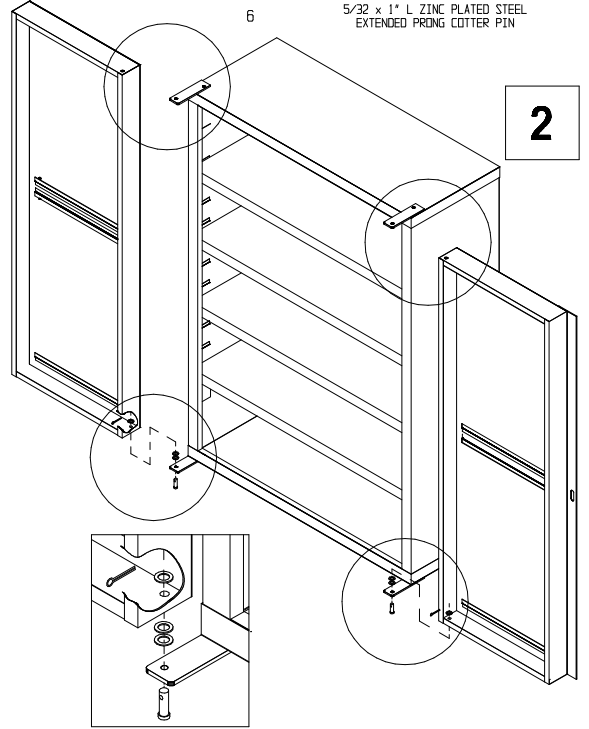
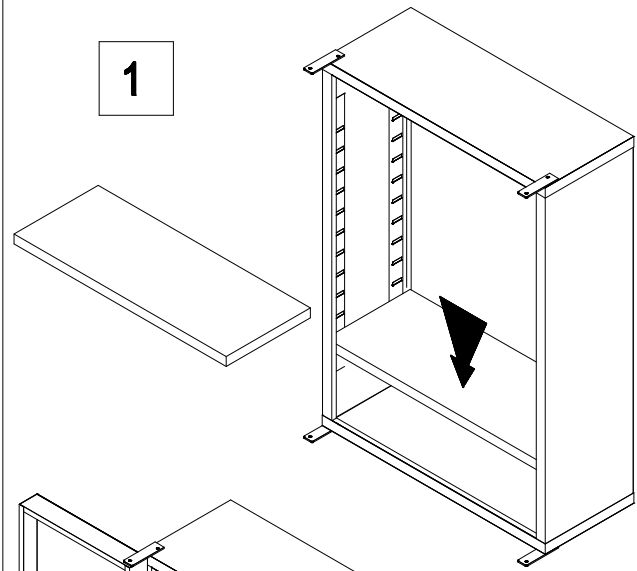

# SECURITY WORK STORAGE CENTER DRAWER MOUNTING KIT

MODEL 500CP39

This kit is used to mount the Storage Drawers into the Steel Cabinet.

CONTENTS		
Ref#	Qty	Description
1	(2)	Front Rails
2	(2)	Back Rails
3	(4)	Cross Channels
4	(8)	1/4-20 Screws
5	(8)	1/4-20 Nuts
6	(4)	Spacer Bars

## Instructions

1. Assemble the Left and Right mounting rail assemblies using 1 Front Rail (#1), 1 Back Rail (#2), 2 Cross Channels (#3) and (4) 1/4-20 Screws (#4) and 1/4-20 Nuts (#5) for each.

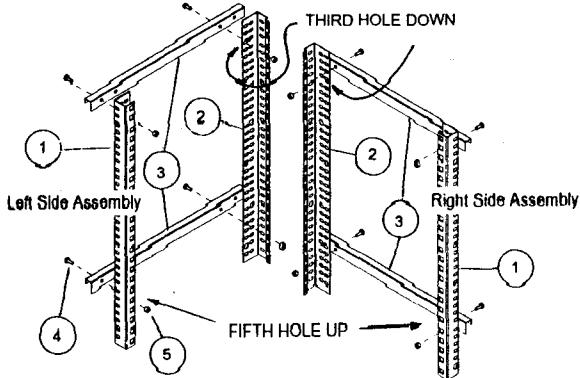

2. A) Hang the Left Side assembly onto the 2nd and 6th set of Louvers on the Left side of the Cabinet (counting from the bottom).  
B) Repeat for the Right Side Assembly.  
C) Install a Spacer Bar (#6) behind each Cross Channel.

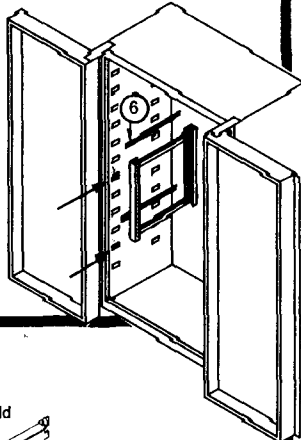

3. A) Identify the Left (L) and Right (R) Drawer Slides packaged with the Drawers (cut-out should be on top and in front).

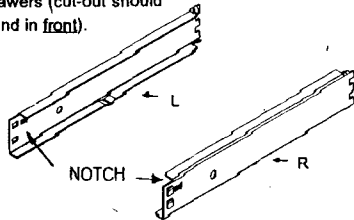

- B) Attach the Left Drawer Slide (L) flush with the bottom of the Mounting Rail assemblies by sliding rear tabs into notches on Back Rail and securing the front with (2) 1/4" x 1/2" Flat Head Screws.

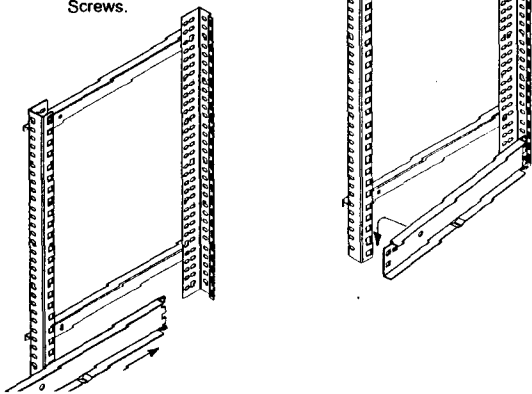

4. Similarly attach additional Drawer Slides, leaving a space which corresponds to the Drawer size you are using (i.e., leave a 6" space for a 6" high Drawer, and a 5" space for a 5" high Drawer.)

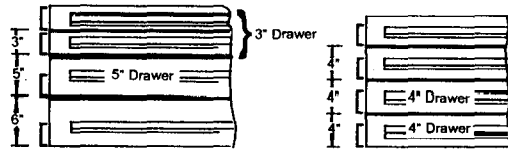

5. A) Slide the Drawer carriage into the Drawer Slides. (Notice that the brake lever functions automatically. If you can remove the carriage without releasing the brake, then you probably inverted the Left and Right Drawer Slides installed in step 3. Remember, the cut-out should face up, not down.)

- B) Slide the Drawers into the carriages.

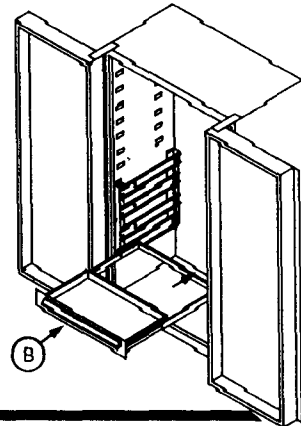

6. Place the worksurface on top of the Drawer Mounting Rail assemblies.

