

User's manual

Manual del usuario

Manuel de l'utilisateur

Customer Service  
US: 1-800-645-2986

Servicio de atención al Cliente  
US: 1-800-645-2986

Service à la clientèle  
Canada: 888-645-2986

## LED Recessed Troffer

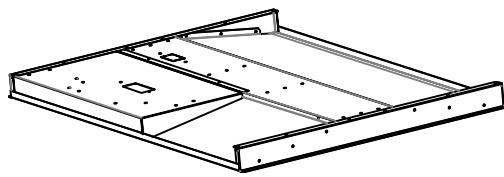

Model 812411

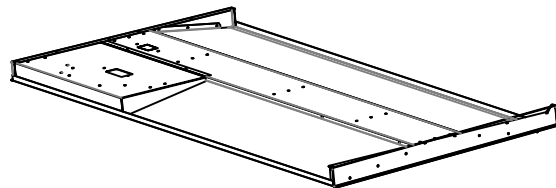

Model 812412

### GENERAL SAFETY INFORMATION

- To reduce the risk of property damage, personal injury, and/or death from fire, electric shock, falling equipment, and other hazards please read all instructions and warnings.
- Installation, service, and maintenance should be performed by a qualified licensed electrician.
- Do not install on damp, moist, or newly plastered surfaces.
- Fixture LEDs are not replaceable.

### • DO NOT INSTALL DAMAGED PRODUCTS!

#### SPECIFICATIONS

Input: AC 100-277V 50/60HZ

**Model 812411: 2 x 2 Recessed Troffer**  
36 Watts, 4500 Lumens, Color Temperature 4000K

**Model 812412: 2 x 4 Recessed Troffer**  
50 Watts, 6250 Lumens, Color Temperature 4000K

### ⚠ WARNING

#### RISK OF ELECTRICAL SHOCK

- Turn off electrical power at fuse or circuit breaker box prior to installation.
- Turn off power prior to performing any maintenance.
- Verify supply voltage accuracy.
- Ensure all electrical and grounded connections are in accordance with the National Electrical Code and any other applicable local code requirements.
- All wiring connections should be capped with approved wire connectors.

### ⚠ CAUTION

#### RISK OF INJURY

- Wear gloves and safety glasses at all times during installation/maintenance.
- Avoid direct eye exposure to light source.
- Ensure fixtures are properly secured to T-bar grid and ceiling, using wire or aircraft cable capable of supporting a minimum of 100 lbs.

#### RISK OF FIRE

- Keep combustible and other materials away from luminaires and lamp/lens.
- Do not install insulation within 2 inches of light fixture.

## INSTALLATION

### Power Leads Connection

Remove screw holding access cover plate and remove the necessary knockout.

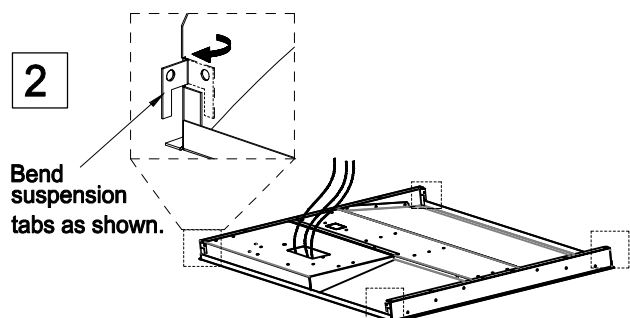
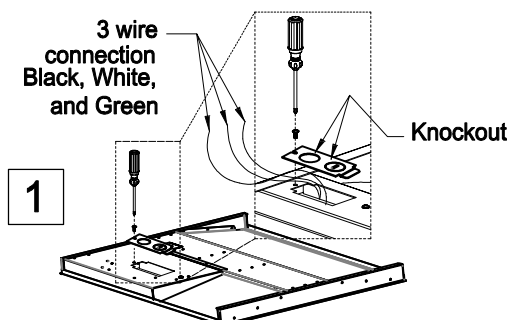

# LED Recessed Troffer

Set light fixture into the suspension with tabs. Hang over the T-Bar as shown.

Remove the ceiling(s) at an appropriate location where the light fixture is to be installed.

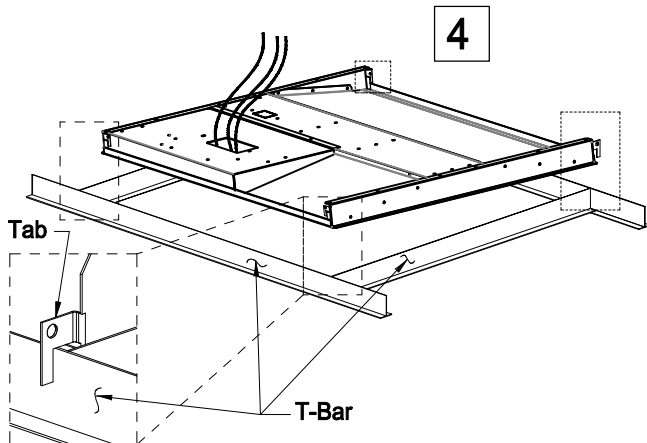
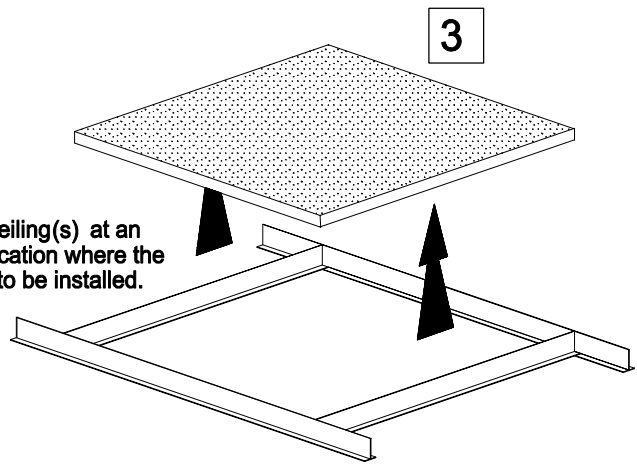

After securing the light fixture to the T-Bar, secure the light fixture to the ceiling with aircraft cable or wires capable of supporting 100 lbs. minimum.

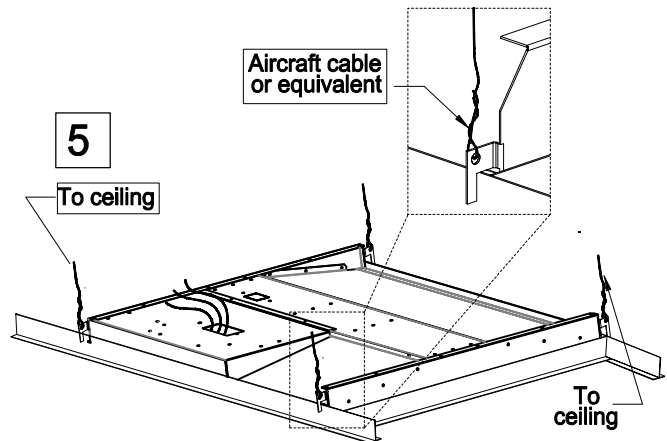

Connect cable wires with appropriate relief strain and wire connectors (not provided). Make sure ALL wires are tucked in before reinstalling the cover plate.

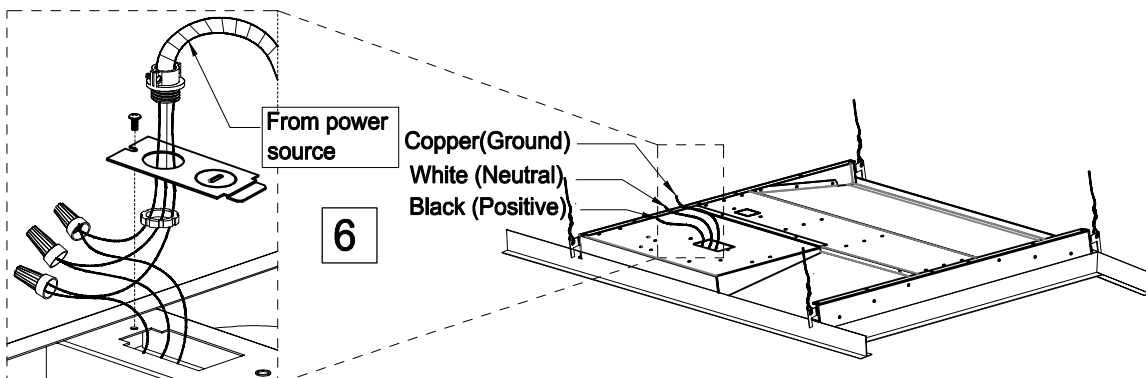

Operation is subject to the following two conditions:

(1) This device may not cause harmful interference, and (2) this device must accept any interference received, including interference that may cause undesired operation.

NOTE: This equipment generates, uses and can radiate radio frequency energy and, if not installed and used in accordance with the instructions, may cause harmful interference to radio communications. However, there is no guarantee that interference will not occur in a particular installation. If this equipment does cause harmful interference to radio or television reception, which can be determined by turning the equipment off and on, the user is encouraged to try to correct the interference by one or more of the following measures:

- Reorient or relocate the receiving antenna.
- Increase the separation between the equipment and receiver.
- Connect the equipment into an outlet on a circuit different from that to which the receiver is connected.
- Consult the dealer or an experienced radio/TV technician for help.