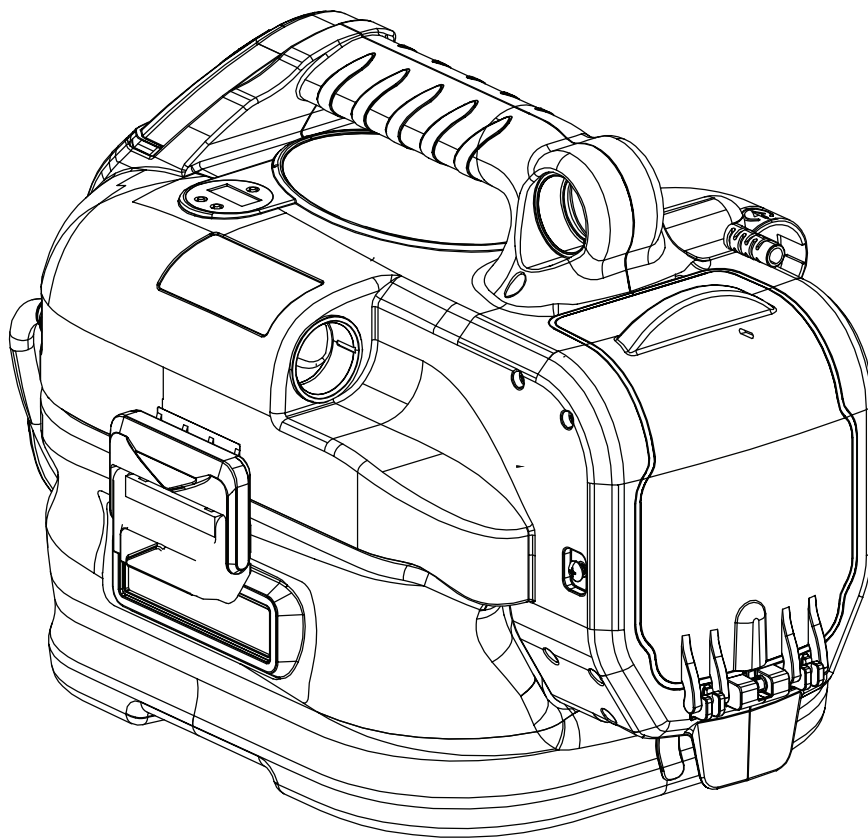

**User's manual**
**Manual del usuario**
**Manuel de l'utilisateur**
**Customer Service**  
**US: 1-800-645-2986**
**Servicio de atención al Cliente**  
**US: 1-800-645-2986**
**Service à la clientèle**  
**Canada: 888-645-2986**

# Battery Powered HEPA Wet/Dry Vacuum w/ Air Inflate Adapter

**Model(s): 641808**

## Specifications:

Battery Voltage (DC)	Charger Voltage (AC)	Tank Volume	Weight	Power	Vacuum	Effective Suction
18V	120V	2 Gal	12.3 lb	180W	>16 kPa	22%

# HEPA Wet/Dry Vacuum

## SAFETY INSTRUCTIONS

1. Do not vacuum flammable liquids, gases, or other hazards.
2. Do not step on, kink, or cut the vacuum hoses. If the hoses are damaged or otherwise impaired, cease operation of the vacuum.
3. Regularly change filter and dust bag to prevent blockage or vacuum choking.
4. Cease operation of the vacuum in the event of a blockage. Running the vacuum for an extended duration when the hose is blocked may cause permanent damage.
5. Do not stick hands or any other body parts in the vacuum hose.
6. Do not operate the vacuum with an overfilled dust bag/tank.
7. Do not allow children to operate the vacuum.
8. Vacuum can be used to clean spills and fluids, but cannot be exposed to rain or wet conditions. Water entering a power tool will increase the risk of electric shock.
9. Grounded chargers must be plugged into an outlet properly installed and grounded in accordance with all local codes and ordinances. Never remove the grounding prong or modify the plug in any way. Do not use adapter plugs. Check with a qualified electrician if you are unsure if the outlet is properly grounded. If the tools should electrically malfunction, grounding provides a low resistance path to carry electricity away from the user.
10. Disconnect battery before making any adjustments, maintenance, or storing the machine.
11. Do not use vacuum if power switch does not work. Cease operation and repair switch or replace vacuum.
12. Do not use vacuum if battery is damaged. Cease operation and repair or replace battery.
13. Do not use third party or aftermarket accessories, they may impare operation of the sander or malfunction during normal use.
14. Maintain all labels and nameplates on the machine so that they are clearly visible and legible.

# HEPA Wet/Dry Vacuum

## PACKING LIST

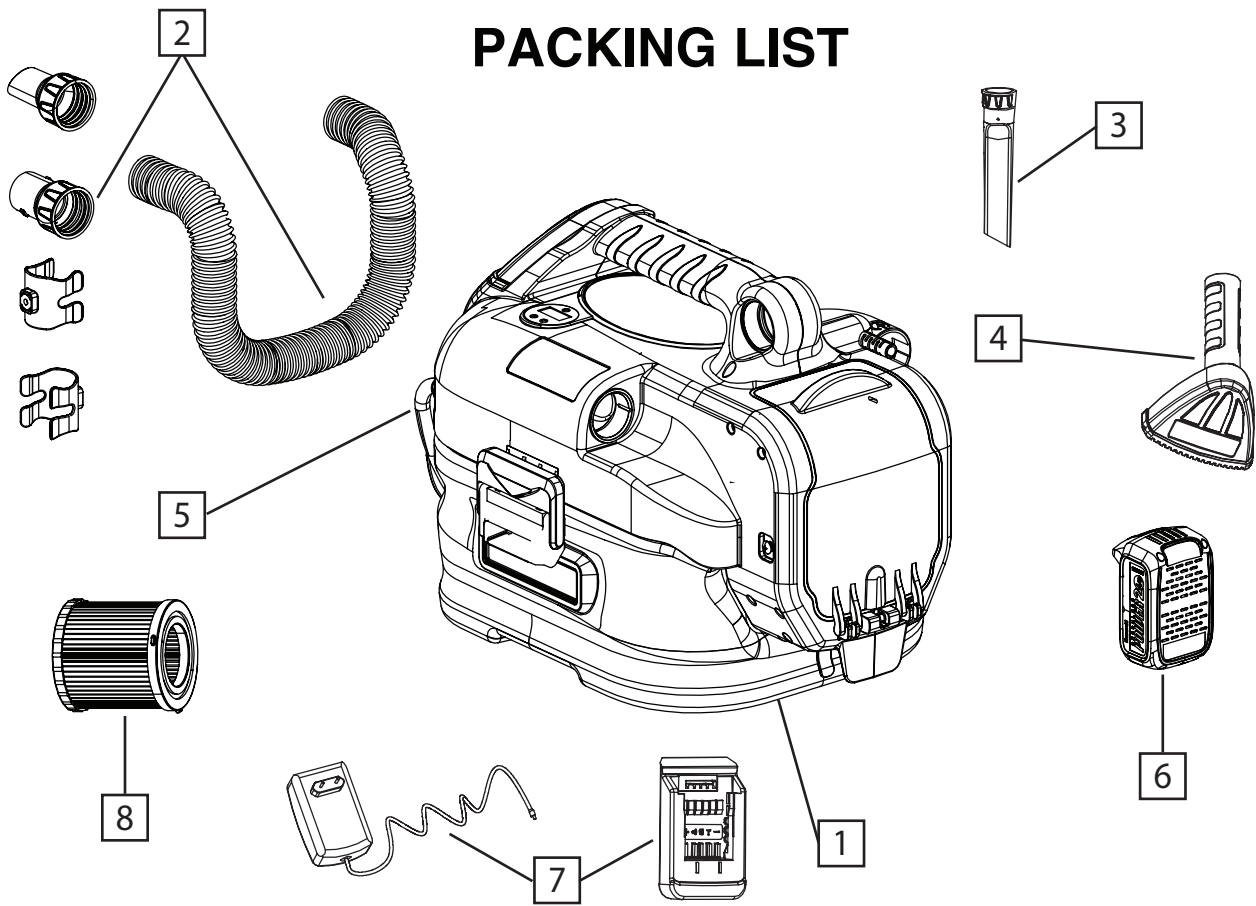

CONTENTS		
Ref.	Qty.	Description
1	1	Vacuum Cleaner
2	1	Hose and Hose Clips
3	1	Dry Nozzle
4	1	Wet Nozzle
5	1	Inflation Tube
6	1	Battery
7	1	Battery Charger
8	1	HEPA Filter

# HEPA Wet/Dry Vacuum

## OPERATION INSTRUCTIONS

1. To turn vacuum on, set the power switch located at the front of the vacuum cover to "vacuum". When turning vacuum on, make sure it is properly plugged in first while it is still off. Turn switch off before unplugging after finishing vacuuming, or when changing accessories.
2. To connect hose to vacuum, insert end of hose into air inlet at the left of the vacuum cover and rotate hose end clockwise until locked. To remove, rotate counterclockwise and then pull.
3. To use blower, insert end of hose into air outlet at the right of the vacuum cover and rotate hose end clockwise until locked. To remove, rotate counterclockwise and then pull. To use blower, set power switch to "vacuum".
4. To connect wet/dry nozzle to hose, insert end of hose into brush outlet and rotate clockwise until tight. To remove, rotate counterclockwise and then pull.
5. To use tire inflator, connect inflator tube to tire valve stem and tighten. Press the setting button and set the desired tire pressure on the display screen. Set the power switch to "inflator" to begin inflating tire. Pump will stop automatically when desired tire pressure is achieved.
6. Clean the vacuum tank after every use. To access the vacuum tank, remove the vacuum cover by opening the two side clamps and pulling the cover up and out of the tank. Dump the contents of the tank. If contents of the tank are wet, clean and dry the tank after discarding contents.
7. Clean the HEPA filter after every use. To access the filter, remove the vacuum cover by undoing the the two side clamps and pulling the cover up and out of the tank. Turn the filter locking knobs counterclockwise and remove the filter. Clean the filter under cold, running water. Do not use detergents or soaps to clean the filter. **DO NOT DAMAGE SAFETY VALVE WHEN REMOVING FILTER.**

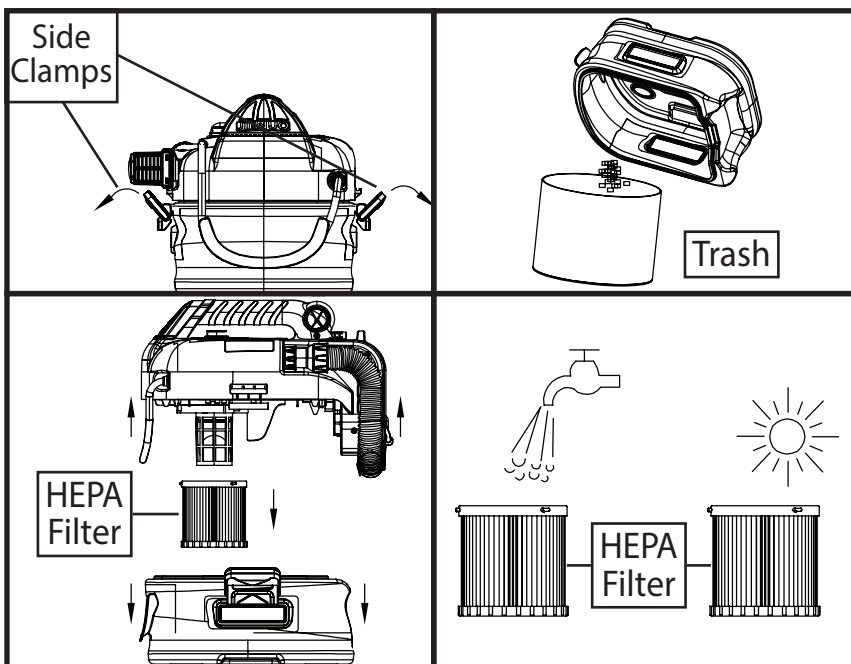
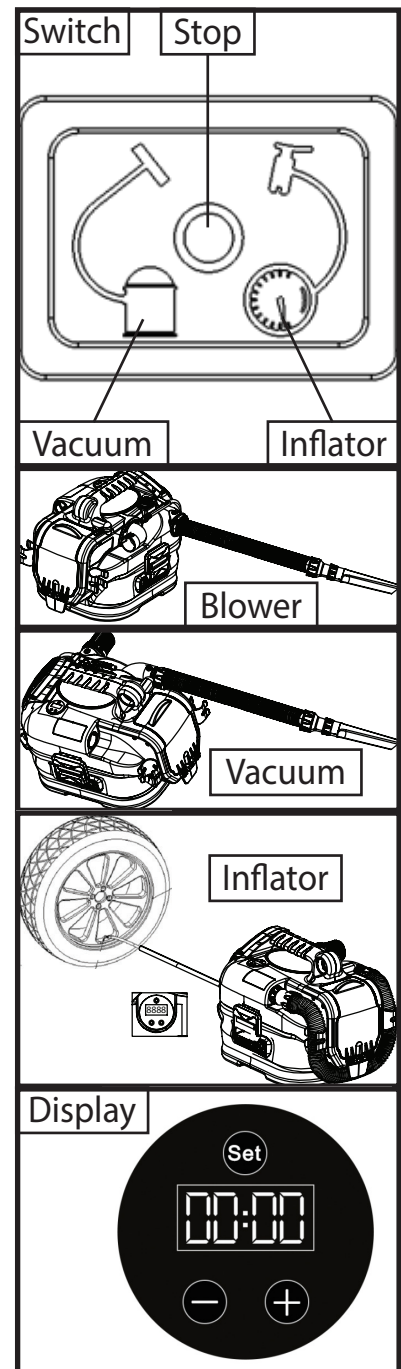

### **⚠ WARNING**

DO NOT use vacuum to suck or blow burning or flammable material or otherwise hazardous chemicals

# HEPA Wet/Dry Vacuum

## CHARGING INSTRUCTIONS

1. Slide battery pack onto charger upside down until it clicks in place.
2. Plug the charger into a wall outlet. The RED charge indicator LED should illuminate. Battery should reach full charge in approximately 60 minutes.
3. GREEN charge indicator LED should illuminate when battery is fully charged. Unplug the charger.
4. Press the release button on the battery and slide the battery out of the charger.

NOTE: the battery may have become hot during charging, allow the battery to return to room temperature before use.

NOTE: the battery ships partially charged to avoid deep discharge damage, however you still must fully charge the battery before your first use.

## MAINTENANCE

1. Avoid using the vacuum for more than 20 minutes at a time.
2. Clean the filter and tank after every use. Do not run the vacuum with a dirty filter or full tank.
3. Dump any dirty water after vacuuming to prevent corrosion.
4. Dry all wet surfaces with a paper towel or dry cloth.
5. DO NOT vacuum for more than 20 minutes at a time, the battery will overheat.
6. Allow the battery to come down to room temperature before recharging

## TROUBLE SHOOTING

PROBLEM	POSSIBLE CAUSE	CORRECTIVE ACTION
Motor won't start	Battery charge is low Battery is not properly inserted On/off switch is broken	Charge battery Remove and reinstall battery correctly Replace on/off switch
Reduced suction	Tank is full HEPA filter is clogged Blockage in nozzle or hose Battery charge is low	Empty and clean tank Clean/replace the filter Remove and clean nozzle/hose Charge battery
Motor stops when vacuuming	Battery charge is low	Charge battery
Battery pack fails to charge	Poor contact between battery and charger Battery is too hot	Remove and reinstall battery correctly Wait for battery to cool to room temperature before charging