

PART# 600/1

Flush End Cap for 1" Tubing Diameter

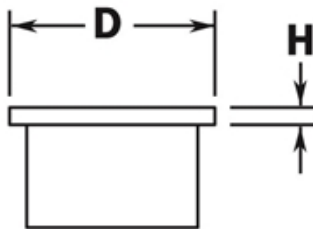

H	1/8"
D	1"

MATERIAL & AVAILABLE FINISHES			
	BRASS	304 SST	316 SST
Polished	√	√	
Satin	√	√	
Clear Coat	√		

MATERIAL USAGE			
	BRASS	304 SST	316 SST
Indoor	√	√	
Outdoor	√*		

*Uncoated brass only

MATERIAL CARE	
Brass	Use Lavi Metal Polish (Item# 00202) and apply with a damp, soft cloth.
Stainless Steel	Use metal cleaner and apply with a damp, soft cloth.

INSTALLATION	Designed to mate with 1" OD x 0.05" wall tube. Adhere fitting to tube using Loctite 326 Metal Adhesive (#00201) and Primer (#00211).
HARDWARE INCLUDED	---
USE TOGETHER WITH	1" OD x 0.05" wall tube (A100).