

**PART# 600/1H**

**Flush End Cap for 1-1/2' Diameter Tubing**

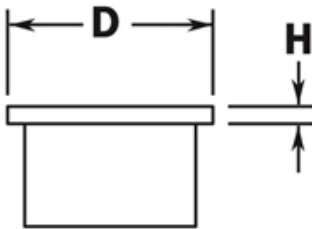

<b>H</b>	1/8"
<b>D</b>	1-1/2"

MATERIAL & AVAILABLE FINISHES			
	BRASS	304 SST	316 SST
<b>Polished</b>	√	√	
<b>Satin</b>	√	√	
<b>Clear Coat</b>	√		

MATERIAL USAGE			
	BRASS	304 SST	316 SST
<b>Indoor</b>	√	√	
<b>Outdoor</b>	√*		
*Uncoated brass only			

MATERIAL CARE	
<b>Brass</b>	Use Lavi Metal Polish (Item# 00202) and apply with a damp, soft cloth.
<b>Stainless Steel</b>	Use metal cleaner and apply with a damp, soft cloth.

<b>INSTALLATION</b>	Designed to mate with 1.5" OD x 0.05" wall tube. Adhere fitting to tube using Loctite 326 Metal Adhesive (#00201) and Primer (#00211).
<b>HARDWARE INCLUDED</b>	---
<b>USE TOGETHER WITH</b>	1.5" OD x 0.05" wall tube (A110).