

ASSEMBLY INSTRUCTIONS

Remove all items from the carton . Verify all pieces before assembly.

PARTS LIST

KEY	QTY	DESCRIPTION
1	1	Table
2	1	Steel Frame
3	8	Table Screw (for model #695CP05 / 06)
	6	Table Screw (for model # 695CP04)
4	2	Leg (L & R)
5	6	Frame Screw + Washer
6	4	Caster
7	2	Lever
8	1	Allen Wrench

STEP 1.

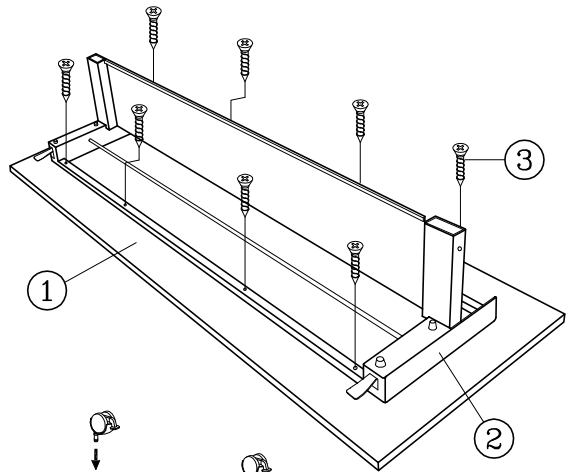

STEP 2.

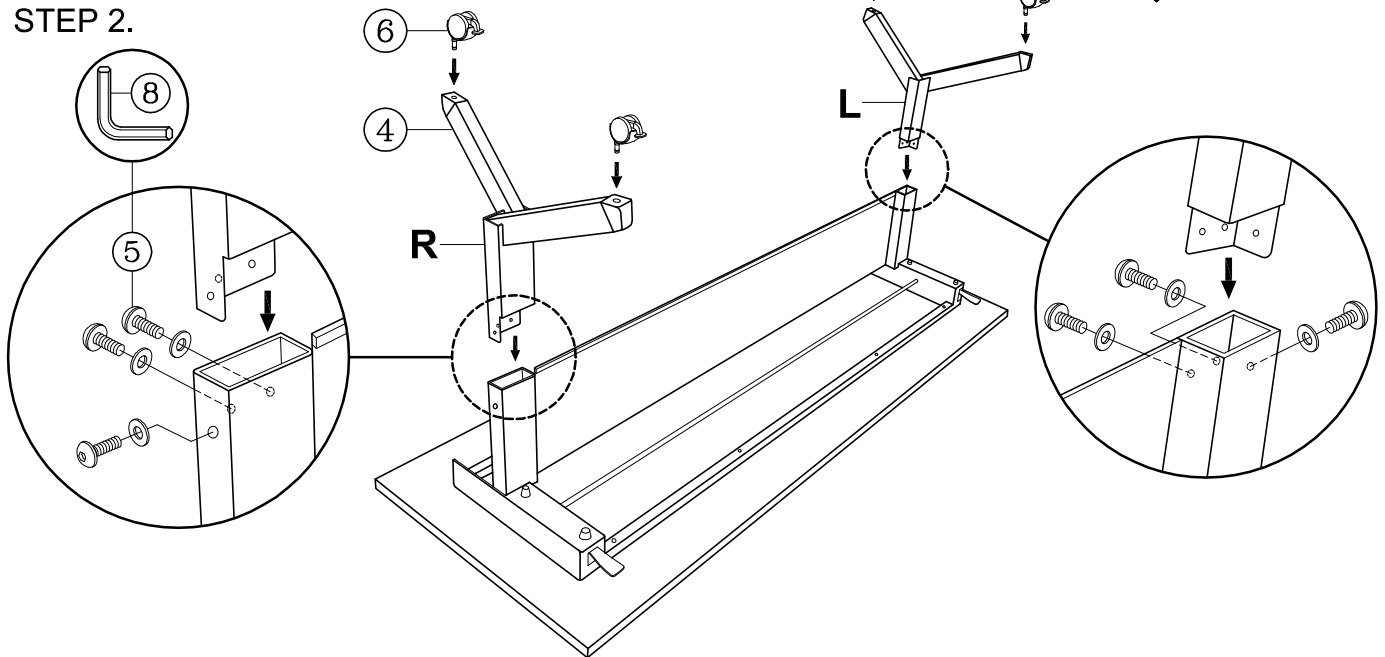

STEP 3.

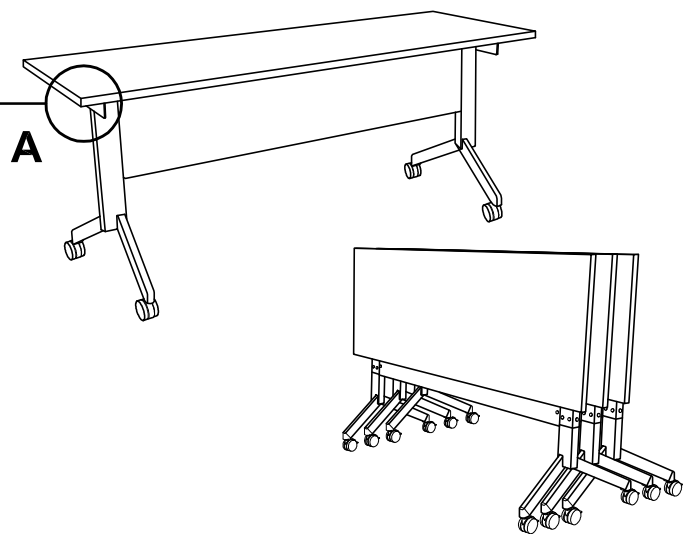
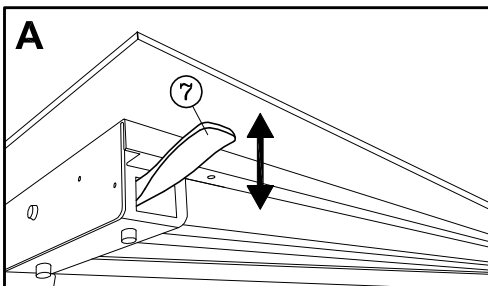

A : Flip top up - Lift lever towards up to release locking mechanism and rotate top up.

Flip top down - Lift lever towards up to release locking mechanism and rotate top down.

★ Use caution when using initially . Check all screws to be sure they are securely tightened.

695CP04 / 6905CP05 / 695CP06

ATTENTION

1. THIS ASSEMBLY INSTRUCTION IS ONLY FOR ASSEMBLING THE TABLE. THE TABLE DRAWING MAY BE DIFFERENT FROM TABLE APPEARANCE.
2. SOME SCREWS MAY PREASSEMBLED , ASSEMBLERS CAN IGNORE THE STEP.
3. REMOVE ALL ITEMS FROM THE CARTON. VERIFY ALL PIECES BEFORE ASSEMBLY.

PREVENTIVE MAINTENANCE AND WARNING!

- IF ANY PARTS ARE MISSING, BROKEN, DAMAGED OR WORN, STOP USE OF THE PRODUCT UNTIL REPAIRS ARE MADE USING FACTORY AUTHORIZED PARTS.
- DISPOSE OF PACKAGING PROPERLY.
- FAILURE TO FOLLOW THESE WARNINGS COULD RESULT IN SERIOUS INJURY.
- EVERY SIX MONTHS, PLEASE MAKE SURE ALL BOLTS, SCREWS AND KNOBS ARE FULLY TIGHTENED TO ENSURE STABILITY.