

Cashier Shield

1. Align **Upright** with the dimples on the **Base**. Screw the base to the upright from underneath using the Philips Head Screw provided. Installation is the same for both racetrack steel base and clamp on base.

2. Remove plastic endcap. Insert **Acrylic Panel**:

For Acrylic to be 12" above counter – Insert 1 large plastic set screw into the large hole in each upright, and install the single large set screw at least 2/3 into the upright. Install small set screws into each of the smaller holes 1 full turn (not more), with one small set screw in the front and one in the rear of each upright. Insert acrylic panel into upright channel. Acrylic panel rests on the 1 long set screw. Tighten the short set screws to secure the acrylic panel using a small screwdriver, or you can use the side of a credit card.

For Acrylic to be full upright height - Install small set screws into each of the smaller holes 1 full turn (not more), with one small set screw in the front and one in the rear of each upright. Insert acrylic panel into upright channel. Acrylic panel rests on the bases. Tighten the short set screws to secure the acrylic panel using a small screwdriver, or you can use the side of a credit card. Note the larger set screws are NOT used in this configuration. They can be saved for later use or discarded.

3. Replace plastic endcap.

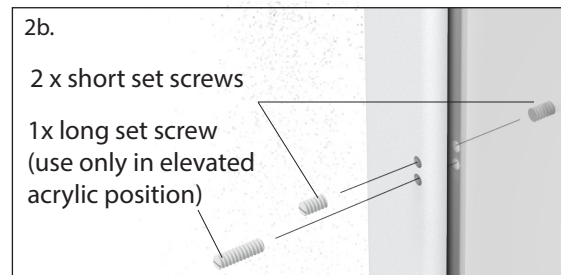
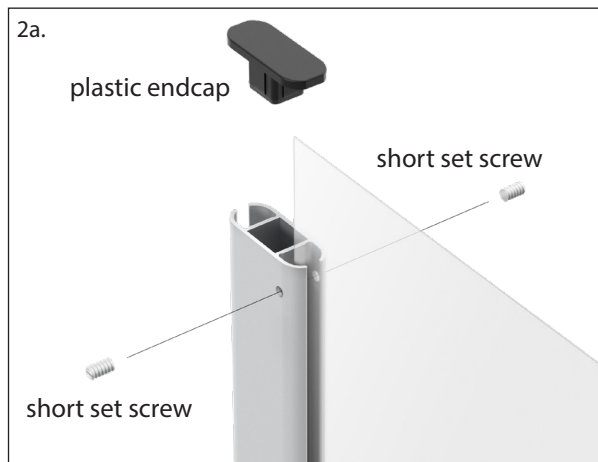
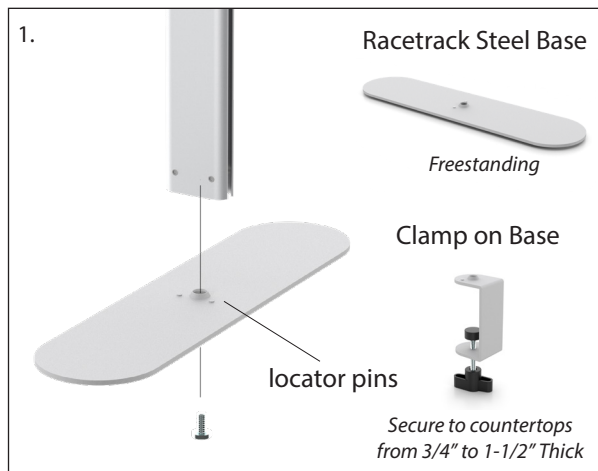

Single Acrylic Panel Model No. 298644, 298645, 298646, 298647
 Two Acrylic Panels Model No. 298648, 298649, 298650, 298651
 Add-on Panel Model No. 298652, 298653, 298654, 298655