



MVE 440/2M

Single Phase - 2 poles - 3600 RPM - 60 Hz
115 Volt



Mechanical Features		Electric Features	
General		General	
Working Moment	2.27 inLb	Nominal Voltage	Δ : 115
Unbalance	1.14 inLb	Input Power	0.28 Hp
FC	416.67 Lb	Current A Max	Δ : 2.62 A
Bearings		Power factor	
TYPE (SKF)	6302 2Z	la/In	
	100% 4616	Capacitor	16
Life(h)	80%: 9015	Certification	
	50%: 36926	ETL CLASS II DIV.II GROUP F,G TENV NEMA 4	T4
Bearing Grease		ATEX II 3D Ex tD A22 IP66	T 100°
Lube Schedule (Oz)		Amb Temp.	-4 ≤ T°F ≤ +104
Lube Replacement (Oz)			
Grease Type			

Dimensional Features (inches)

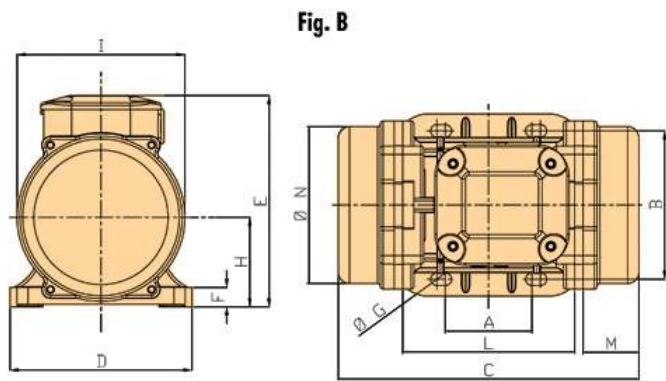

A	2.44-2.91
B	4.17
C	9.09
M	2.13
G	0.35
holes	4
D	5.16
E	6.26
F	0.59
H	2.52
I	4.76
L	4.84
N	4.41

Clamping
Torque(ft-
lb)

16.97

[[Drawings Download](#)]

Weight(Lb)	Screw	Washer	Cable Type	Cable Glannde
15.43	M8	8.4x16	16-4c	M20x1,5

REV.2-03/10/2013