

# EXTRUDED RUBBER BUMPER (NO HOLES) - M-6-120

APPROX WEIGHT: 91.92 lbs.  
 DOES NOT INCLUDE WEIGHT OF POWER OR PACKAGING!!!

\*\*\* ANY ADDITIONS, DELETIONS, OR OMISSIONS MUST BE CORRECTED ON THIS DRAWING AS THIS DRAWING WILL BE CONSIDERED ALL INCLUSIVE \*\*\*

ALL GRAPHICS PROVIDED ARE FOR REFERENCE ONLY. IF CERTAIN DIMENSIONS ARE CRITICAL PLEASE VERIFY THOSE DIMENSIONS WITH YOUR SALESPERSON

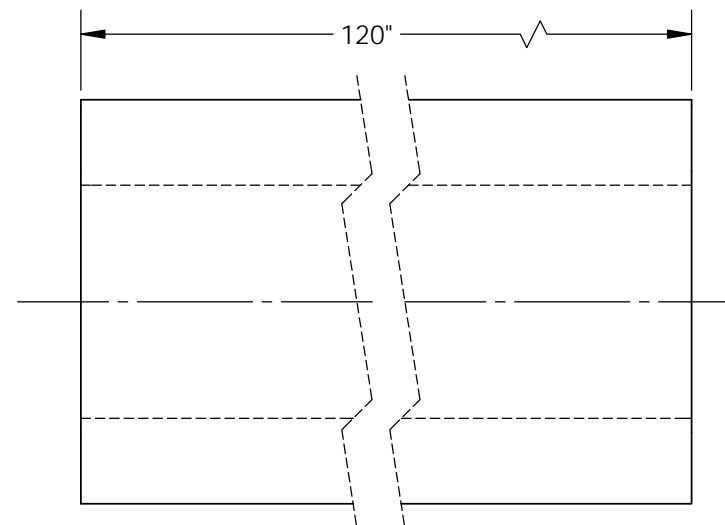
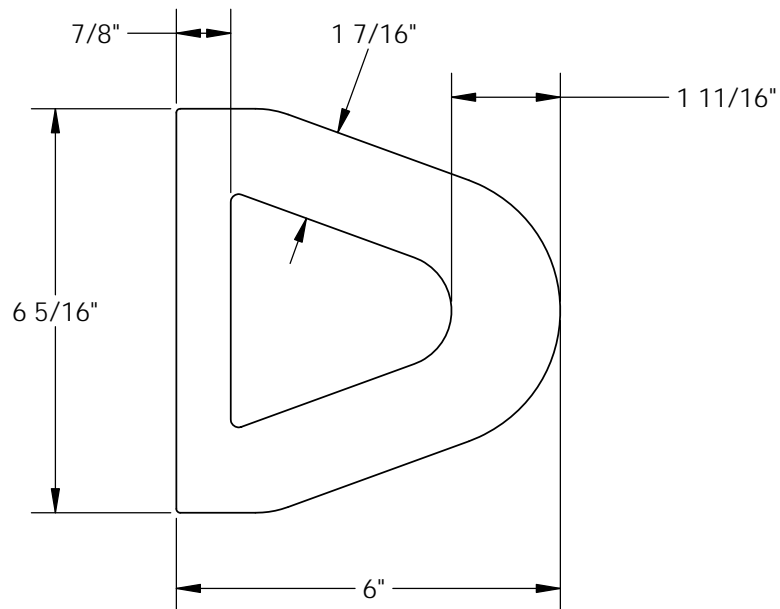

NOTE: ACTUAL PART LENGTH MAYBE  
 -0"/+7"

DIMENSION TOLERANCE ± 1/2"

## STANDARD FEATURES

MODEL NUMBER IS M-6-120  
 OVERALL WIDTH IS 6 5/16"  
 OVERALL LENGTH IS 120"  
 OVERALL HEIGHT IS 6"  
 NUMBER OF MOUNTING HOLES 0

## SPECIAL FEATURES

NONE

<b>APPROVAL</b>	I, THE UNDERSIGNED, AGREE THAT THE PRODUCT AS REPRESENTED SATISFIES DESIGN AND DIMENSION REQUIREMENTS. I ALSO ACKNOWLEDGE MY DUTY TO CONFIRM PRODUCT AND INSTALLATION COMPLIANCE WITH ALL APPLICABLE FEDERAL, STATE AND LOCAL REGULATIONS AND STANDARDS.	
	<b>ALL SPECIAL UNITS ARE NON-RETURNABLE</b> <input type="checkbox"/> As drawn <input type="checkbox"/> As marked	
Signed: _____		Date: _____
<b>LEAD TIME WILL START UPON RECEIPT OF SIGNED APPROVAL DRAWING</b>		

FOR INTERNAL USE ONLY PROJECT SIGN OFF	
SALES	
ENG.	
FAB.	
POWER	

DISTRIBUTOR'S NAME:		P.O.#
VESTIL MANUFACTURING		X
W.O.#		X
DRAWN BY:	RPS	DATE: 08/28/2012
SALES:		X
REFERENCE:	X	SCALE: 1:3
FILE NAME:		29-007-202
QUOTED LEAD TIME:	X	QUOTE #
		X