



**VESTIL MANUFACTURING CO.**

2999 North Wayne Street, P.O. Box 507, Angola, IN 46703

Telephone: (260) 665-7586 -or- Toll Free (800) 348-0868

Fax: (260) 665-1339

[www.vestil.com](http://www.vestil.com)

[sales@vestil.com](mailto:sales@vestil.com)

**CYL-2, CYL-2-FF, CYL-2-FP & CYL-2-FP-FF Cylinder Carts**

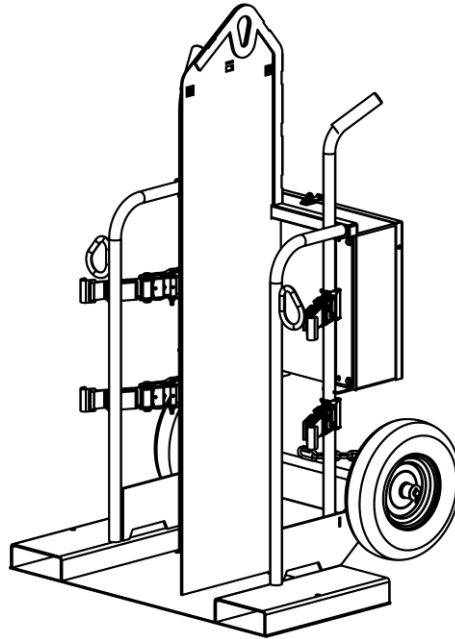

**Receiving Instructions**

After delivery, remove the packaging from the product. Inspect the product closely to determine whether it sustained damage during transport. If damage is discovered, record a complete description of it on the bill of lading. If the product is undamaged, discard the packaging.

**NOTE:** The end-user is solely responsible for confirming that product design, use, and maintenance comply with laws, regulations, codes, and mandatory standards applied where the product is used.

**Technical Service & Replacement Parts**

For answers to questions not addressed in these instructions and to order replacement parts, labels, and accessories, call our Technical Service and Parts Department at (260) 665-7586. The department can also be contacted online at <https://www.vestil.com/page-parts-request.php>.

**Electronic copies of Instruction Manuals**

Additional copies of this instruction manual may be downloaded from <https://www.vestil.com/page-manuals.php>.

**Table of Contents**

**Page**

National Standards.....	2
Specifications.....	2
Signal Words.....	3
Safety Instructions.....	3
CYL-2-FP & CYL-2-FP-FF Exploded View & Bill of Materials.....	4
CYL-2 & CYL-2-FF Exploded View & Bill of Materials.....	5
Using the Cylinder Cart.....	6 - 7
Record of Satisfactory Condition.....	7
Inspecting & Maintaining the Cylinder Cart.....	7 - 8
Labeling Diagram.....	8
Limited Warranty.....	9

## NATIONAL STANDARDS

This product can be used as either a front end attachment when mounted on the forks of a fork truck, or a below-the-hook lifter when attached to a hoist or other overhead lifting device.

### FRONT END ATTACHMENT

According to US Federal Occupational Safety and Health Administration (OSHA) Rule 1910.178 (29 CFR 1910.178; the "Rule"), this device is a front end attachment (for a lift truck) whenever it is mounted on the forks of a lift truck. The Rule incorporates American National Standard ANSI/ITSDF B56.1 (the "Standard") published by the Industrial Truck Standards Development Foundation (ITSDF) on its website ([www.itsdf.org](http://www.itsdf.org)). The standard is freely downloadable at <http://www.itsdf.org/cue/b56-standards.html>. Before putting this cart into service, acquire a copy of the Standard. Apply all relevant parts of Part II: For the User. If instructions provided in this manual conflict with the Standard, then the instructions in the Standard must be applied. Vestil requests that you immediately inform it about inconsistencies by contacting [TECHNICAL SERVICE](#) personnel. Contact information for [TECHNICAL SERVICE](#) appears on the cover page of this manual.

### BELOW-THE-HOOK LIFTING DEVICE

When attached to an overhead lifting device, this product is a "Below-the-Hook Lifting Device" (BTH lifter). [ASME standard B30.20](#) (the "Standard") applies to BTH lifters. Acquire a copy of the latest version of the Standard before putting the lifter into service. Follow all use and maintenance/care instructions provided in the Standard as well as all other provisions for owners and users. If content in the manual conflicts with recommendations or mandatory provisions in the Standard, apply the Standard. Vestil encourages you to immediately contact [TECHNICAL SERVICE](#) if you discover any conflicts.

## SPECIFICATIONS

Documents that provide specifications for CYL-2 series cylinder carts are available online to anyone who visits Vestil's website. Specifications include dimensions, net weight, and capacity information. Navigate to <https://www.vestil.com/product.php?FID=886>. Scroll to the *Product Specifications Table* portion of the page. Find the entry for the cylinder cart you purchased and click the button in the "PDF" column that looks like a pencil inside a blue-bordered box. A PDF file will open. This file is the specifications document. Print a copy of the document and keep it with your copy of this manual. The following is an exemplar specifications document for model CYL-2.

**WELDING CYLINDER TORCH CART - CYL-2**

APPROX WEIGHT: 240 lbs.  
DOES NOT INCLUDE WEIGHT OF POWER OR PACKAGING!!!

\*\*\* ANY ADDITIONS, DELETIONS, OR OMISSIONS MUST BE CORRECTED ON THIS DRAWING AS THIS DRAWING WILL BE CONSIDERED ALL INCLUSIVE \*\*\*  
ALL GRAPHICS PROVIDED ARE FOR REFERENCE ONLY. IF CERTAIN DIMENSIONS ARE CRITICAL PLEASE VERIFY THOSE DIMENSIONS WITH YOUR SALESPERSON

**STANDARD FEATURES**

MODEL NUMBER IS CYL-2  
CAPACITY IS 500 LBS.  
OVERALL WIDTH IS 40 1/4"  
LEFT SIDE USABLE WIDTH IS 13 3/8"  
RIGHT SIDE USABLE WIDTH IS 10 7/16"  
OVERALL DEPTH IS 34 9/16"  
OVERALL HEIGHT IS 66 3/8"  
7 1/2"W x 2 9/16"H USABLE FORK POCKETS  
STRAPS TO SECURE TANKS  
SAFETY CHAIN TO SECURE UNIT TO FORK TRUCK  
16" PNEUMATIC WHEELS  
TOUGH BAKED IN POWDERCOATED YELLOW FINISH

**SPECIAL FEATURES**

NONE

I, THE UNDERSIGNED, AGREE THAT THE PRODUCT AS REPRESENTED SATISFIES DESIGN AND DIMENSION REQUIREMENTS. I ALSO ACKNOWLEDGE MY DUTY TO CONFIRM PRODUCT AND INSTALLATION COMPLIANCE WITH ALL APPLICABLE FEDERAL, STATE AND LOCAL REGULATIONS AND STANDARDS.

**ANY MODIFIED UNITS ARE NON-RETURNABLE**

[ ] As drawn [ ] As marked

Signed: \_\_\_\_\_ Date: \_\_\_\_\_

Printed Name: \_\_\_\_\_

LEAD TIME WILL START UPON RECEIPT OF SIGNED APPROVAL DRAWING

<p>FOR INTERNAL USE ONLY PROJECT SIGN OFF</p> <table border="1" style="width: 100%; border-collapse: collapse;"> <tr> <td>SALES</td> <td></td> </tr> <tr> <td>ENG.</td> <td>SR</td> </tr> <tr> <td>FAB.</td> <td>X</td> </tr> <tr> <td>POWER</td> <td></td> </tr> </table>	SALES		ENG.	SR	FAB.	X	POWER		<p>DISTRIBUTOR'S NAME: <b>VESTIL MANUFACTURING</b></p> <table border="1" style="width: 100%; border-collapse: collapse;"> <tr> <td>DRAWN BY:</td> <td>SR</td> <td>DATE:</td> <td>7/10/06</td> </tr> <tr> <td>REFERENCE:</td> <td>X</td> <td>SCALE:</td> <td>1:16</td> </tr> <tr> <td>QUOTED LEAD TIME:</td> <td>X</td> <td>QUOTE #</td> <td>X</td> </tr> </table>	DRAWN BY:	SR	DATE:	7/10/06	REFERENCE:	X	SCALE:	1:16	QUOTED LEAD TIME:	X	QUOTE #	X
SALES																					
ENG.	SR																				
FAB.	X																				
POWER																					
DRAWN BY:	SR	DATE:	7/10/06																		
REFERENCE:	X	SCALE:	1:16																		
QUOTED LEAD TIME:	X	QUOTE #	X																		

## SIGNAL WORDS

This manual uses SIGNAL WORDS to indicate the likelihood of personal injuries, as well as the probable seriousness of those injuries, if the product is misused in the ways described. Other signal words call attention to uses of the product likely cause property damage. The following are signal words used in this manual and their definitions.

### DANGER

Identifies a hazardous situation which, if not avoided, **WILL** result in DEATH or SERIOUS INJURY. Use of this signal word is limited to the most extreme situations.

### WARNING

Identifies a hazardous situation which, if not avoided, **COULD** result in DEATH or SERIOUS INJURY.

### CAUTION

Indicates a hazardous situation which, if not avoided, **COULD** result in MINOR or MODERATE injury.

### NOTICE

Identifies practices likely to result in product/property damage, such as operation that might damage the product.

## SAFETY INSTRUCTIONS

Vestil strives to identify foreseeable hazards associated with the use of its products. However, no manual can address every conceivable risk. Minimize risk by keeping the cart in optimal condition, by inspecting and maintaining the product as instructed in the *INSPECTIONS & MAINTNENANCE* section of this manual, by applying the lessons of these *SAFETY INSTRUCTIONS*, and by exercising sound judgment whenever using this device.

### WARNING

Risks of serious personal injuries or death.

- **Read this manual in its entirety before assembling, installing, using, inspecting or servicing the product.** A copy of this manual should always be available to all persons who assemble, install, use, inspect, or maintain this device.
- DO NOT exceed the maximum rated load.
- Inspect the cart as instructed in [INSPECTING & MAINTAINING THE CYLINDER CART](#) on p. 7-8. Remove the cart from service if the inspection reveals changes from [satisfactory condition](#), including: 1) cracked welds; 2) corrosion, extreme wear, or other condition that affects the ability of the product to support weight; 3) significantly worn or damaged wheels; 4) missing ratchet straps. DO NOT use the product until it is restored to normal condition. ONLY use manufacturer-approved replacement parts.
- DO NOT use the cart to transport any cylinder that does not seat securely in the brackets.
- DO NOT transport a cylinder without firmly applying the ratchet straps.
- ALWAYS apply safe lifting practices whenever the cart is connected to a lifting device (e.g. overhead hoist).
- Before this product may be mounted on the forks of a lift truck and be used to transport cylinders, U.S. Occupational Safety and Health Administration rule 1910.178(a)(4) and (a)(5) require that the owner/user: 1) Obtain written approval from the manufacturer(s) of all forklifts [or from a professional engineer] that will be used with the hopper; 2) Change capacity, operation, & maintenance instruction plates, tags, or decals accordingly; AND 3) Mark the forklift truck to identify the cylinder cart and show the approximate weight of the truck and cart combination at maximum elevation with load laterally centered. Requirements are published at [https://www.osha.gov/pls/oshaweb/owadisp.show\\_document?p\\_table=STANDARDS&p\\_id=9828](https://www.osha.gov/pls/oshaweb/owadisp.show_document?p_table=STANDARDS&p_id=9828)
- DO NOT use this hopper with rough terrain lift trucks or telehandlers (boom trucks). ONLY use this hopper with high lift fork trucks utilizing a vertical mast and carriage. DO NOT mount the hopper on stackers or manually propelled lift trucks.
- When transporting a cylinder up-or-downhill, always remain uphill to the cylinder.
- DO NOT remove or obscure any label. All product labels must be readable and undamaged.
- DO NOT modify the cart in any way. Unauthorized modifications automatically void the limited warranty on p. 9 and might make the cart unsafe to use.

### NOTICE

Proper use, maintenance, and storage are essential for this product to function properly.

- Keep the product clean & dry.
- Only store the cart indoors.

### CYL-2-FP & CLY-2-FP-FF Exploded View and Bill of Materials (16-006-240)

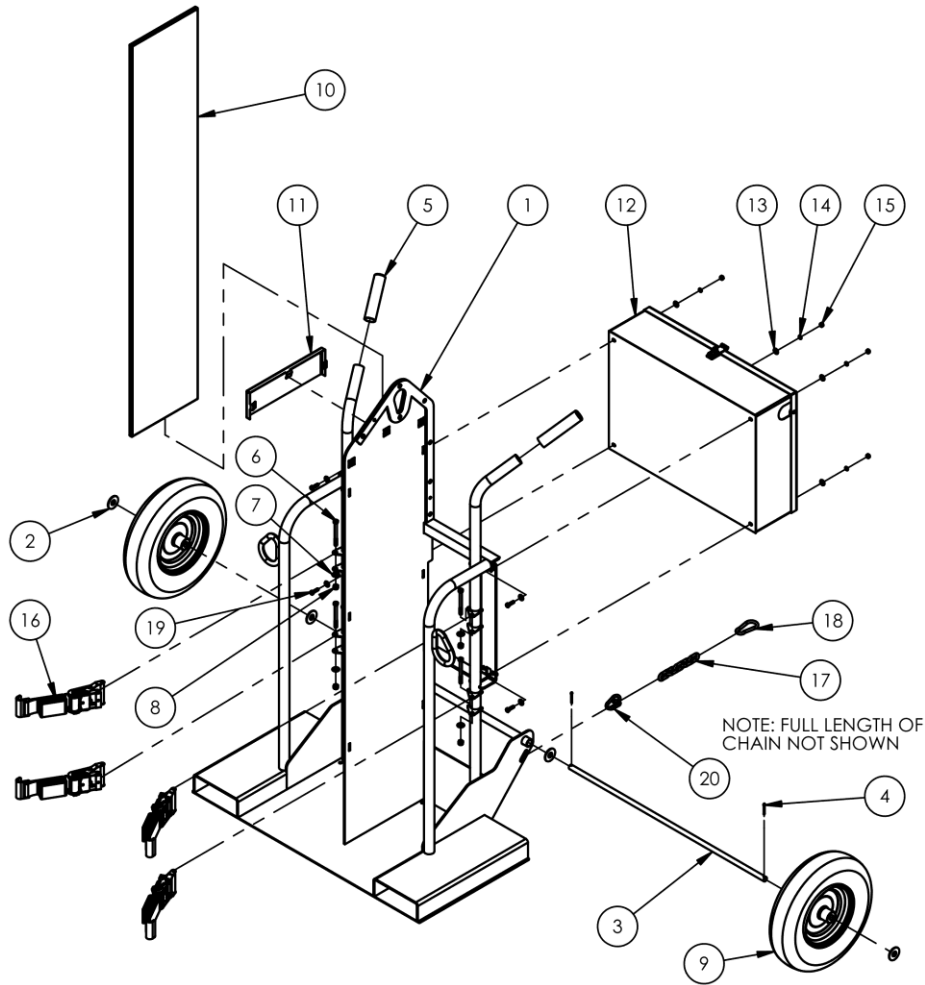

Item no.	Part no.	Description	Quantity
1	16-514-195	WELDMENT, FRAME, BASE	1
2	33016	FLAT WASHER, LOW CARBON, USS, ZINC PLATED, 5/8"	4
3	16-112-044	AXLE, PIN	1
4	65078	EXTENDED PRONG COTTER PIN, ZINC FINISH, 1/8" x 1 1/2"	2
5	07-025-005	HANDLE, BLACK RUBBER, 6"	2
6	11067	HHCS #2 Z PLATED, GRADE A, Ø 5/16 - 18 x 3.5 LG	4
7	33006	FLAT WASHER, ZINC PLATED, USS, Ø 5/16"	4
8	37021	NYLON INSERT LOCK NUT, GRADE 2, ZINC FINISH, 5/16"-18	4
9	16-132-126 16-132-246	Wheel: Pneumatic tire, 4" x 16" Foam filled tire, 4" x 16"	2
10	16-014-259	FRAME, FIREPROOF MARINITE INSERT	1
11	16-014-268	FRAME, FIREPROOF PANEL, FORMED	1
12	99-514-010	TOOLBOX	1
13	33004	FLAT WASHER, USS, ZINC PLATED, Ø 1/4"	8
14	33618	MEDIUM SPLIT LOCK WASHER, Ø 1/4"	4
15	36102	HEX NUT, GRADE A, ZINC PLATED, 1/4-20	4
16	16-145-018	2" x 36" STRAP WITH RATCHET	4
17	09-145-018	CHAIN, 5/16" x 56" LG	1
18	08-145-041	SPECIALTY HARDWARE, SNAP HOOK, Ø 5/16	1
19	11005	BOLT, GRADE A, Ø 1/4-20 UNC x 1 LG, HHCS #2 Z-PLATED	4
20	99-145-084	LAP LINK, 5/16" X 1 1/2"	1

**CYL-2, CYL-2-FF, CYL-2-G, and CYL-2-FF-G Exploded Parts View and Bill of Materials (16-006-136)**

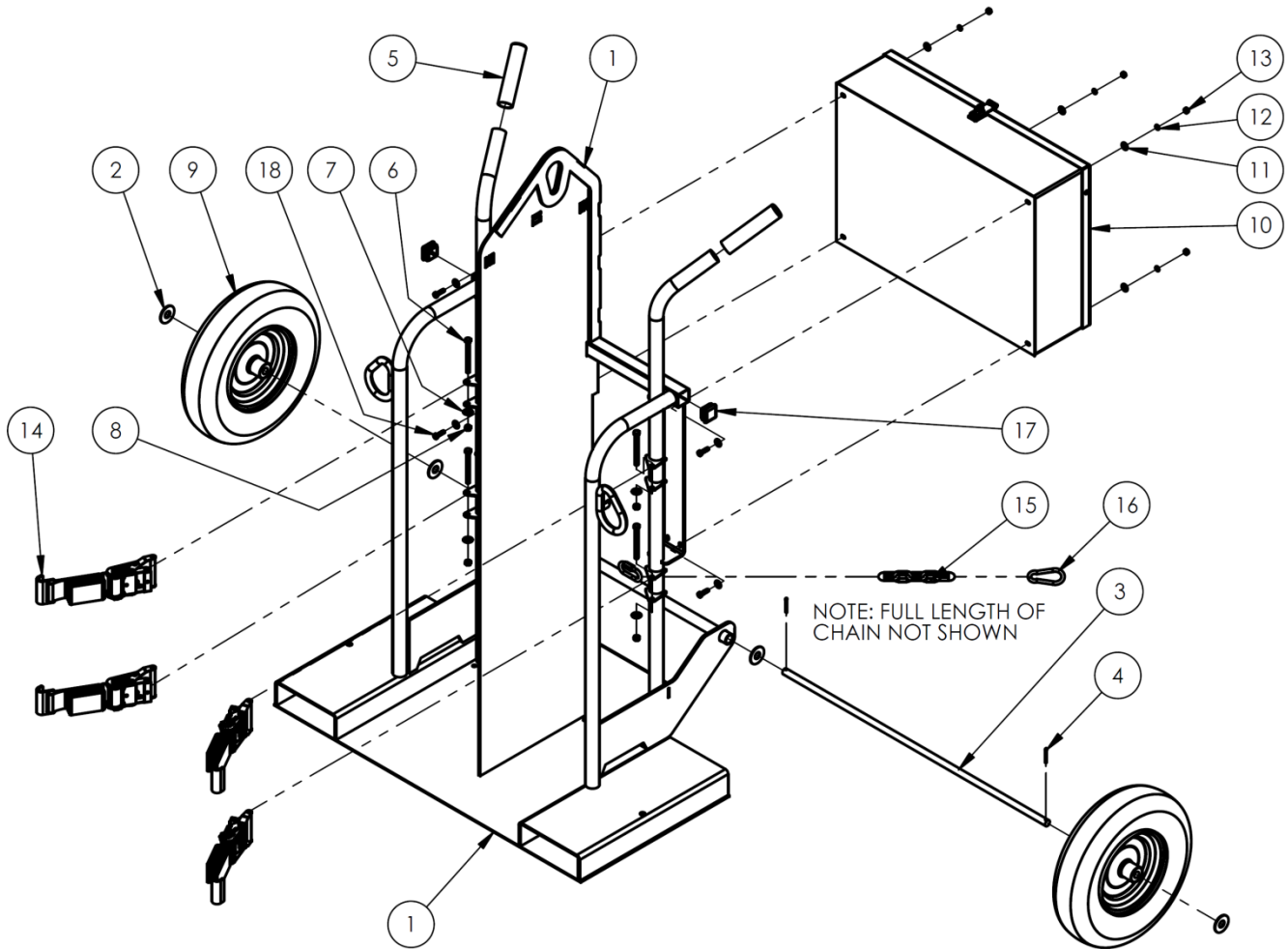

Item	Part no.	Description	Quantity
1	16-514-111	WELDMENT, FRAME, BASE	1
2	33016	FLAT WASHER, LOW CARBON, USS, ZINC PLATED, 5/8"	4
3	16-112-044	AXLE, PIN	1
4	65078	EXTENDED PRONG COTTER PIN, ZINC FINISH, 1/8" x 1 1/2"	2
5	07-025-005	HANDLE, BLACK RUBBER, 6"	2
6	11067	HHCS #2 Z PLATED, GRADE A, Ø 5/16 - 18 x 3.5 LG	4
7	33006	FLAT WASHER, ZINC PLATED, USS, Ø5/16"	4
8	37021	NYLON INSERT LOCK NUT, GRADE 2, ZINC FINISH, 5/16"-18	4
9	16-132-126 16-132-246	WHEEL: CLY-2: 4" x 16" pneumatic tire CYL-2-FF: 4" x 16" foam filled tire	2 2
10	99-514-010	TOOLBOX	1
11	33004	FLAT WASHER, USS, ZINC PLATED, Ø1/4"	8
12	33618	MEDIUM SPLIT LOCK WASHER, Ø1/4"	4
13	36102	HEX NUT, GRADE A, ZINC PLATED, 1/4-20	4
14	16-145-018	2" x 36" STRAP WITH RATCHET	4
15	09-145-018	CHAIN, 5/16" x 56" LG	1
16	08-145-041	SPECIALTY HARDWARE, SNAP HOOK, Ø5/16	1
17	11005	BOLT, GRADE A, Ø1/4-20 UNC x 1 LG, HHCS #2 Z-PLATED	4
18	99-145-084	LAP LINK, 5/16" X 1 1/2"	1



## USING THE CYLINDER CART

### ⚠ WARNING

USING THIS (FORKLIFT TRUCK) FRONT END ATTACHMENT AFFECTS THE CENTER OF GRAVITY OF YOUR LIFT TRUCK. BEFORE USING THIS DEVICE, US FEDERAL REGULATION [29 CFR 1910.178](#) REQUIRES YOU TO CONTACT THE MANUFACTURER OF YOUR LIFT TRUCK TO REQUEST:

- WRITTEN APPROVAL (29 CFR 1910.178(a)(4) TO USE THE ATTACHMENT WITH THE TRUCK; AND
- MARKINGS FOR THE LIFT TRUCK THAT IDENTIFY THE ATTACHMENT AND GIVE THE APPROXIMATE WEIGHT OF THE TRUCK AND ATTACHMENT AT MAXIMUM ELEVATION WITH A Laterally-Centered Load (29 CFR 1910.178(a)(5)). **DO NOT USE THIS DEVICE TO TRANSPORT CYLINDERS WHILE MOUNTED ON A LIFT TRUCK UNTIL YOUR TRUCK IS MARKED WITH CORRECTED CAPACITY TAGS. ONLY USE THIS DEVICE WITH LIFT TRUCKS THAT HAVE BEEN MARKED WITH CORRECTED CAPACITY TAGS.**

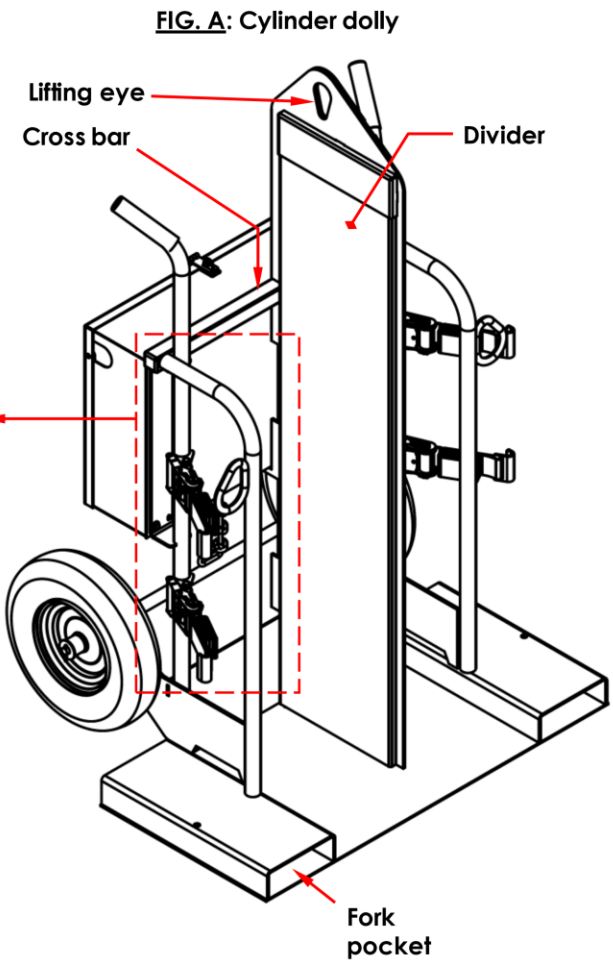
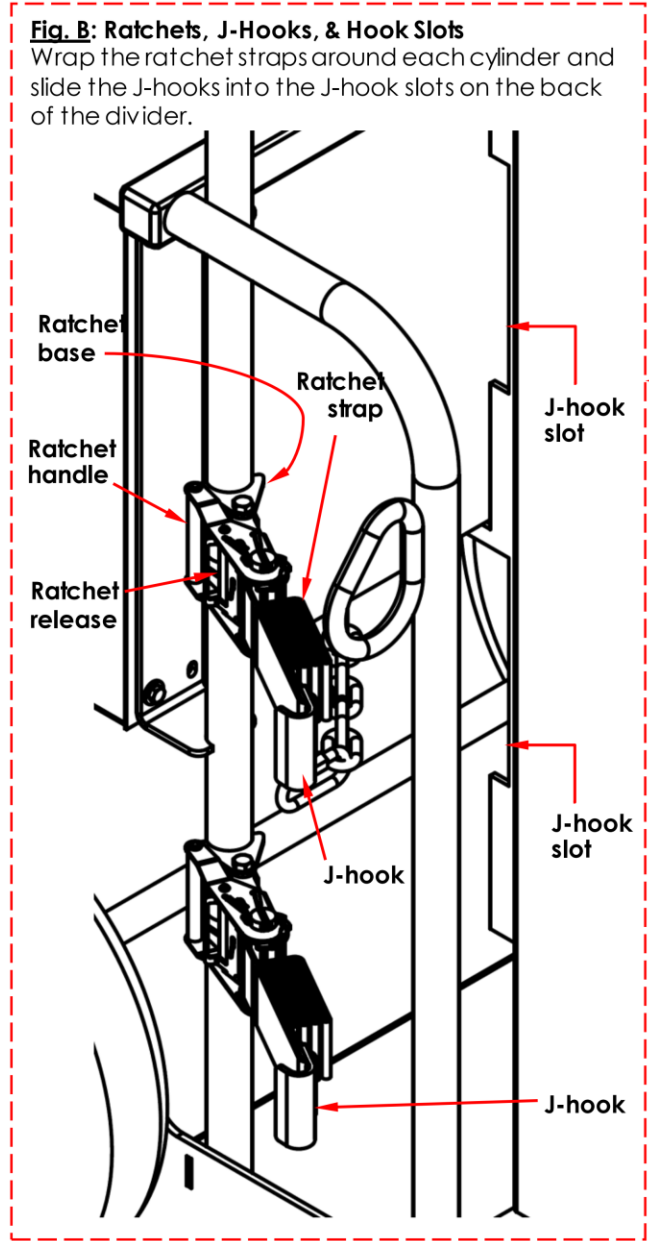

### TRANSPORTING THE CART

Step 1: To move the cylinder cart manually, simply grasp the handles and push the cart to the destination. If it is necessary to transport the cart by forklift, or to lift it with a hoist, follow the applicable instruction.

- i. **Hoist:** Attach the hoist hook to the shackle. Do not side load the hoist! Side loading the hoist will result in load swing as the cart lifts off of the ground.

- ii. **Forklift:** Adjust the positions of the forks on the fork carriage as necessary to match the spacing of the fork tubes. Drive forward and insert the forks into both fork tubes. Drive as far forward as possible. For example, drive forward until the forks wedge into the channels.

Step 2: Raise the cart a few inches above the ground. Observe the cart to determine whether the cart is stable and secure.

Step 3: Transport the cart to the desired location.

- i. **Overhead hoist:** Lift the cart ~5-6 inches above the ground. Stand behind the cart. Grasp the back of the tool tray or upright/post and carefully direct the cart to the desired location. Minimize load swing by moving the hoist **slowly and carefully**.
- ii. **Forklift:** Drive slowly, particularly while turning. Reduce speed during turns. Apply the brakes gradually to prevent jarring the cart or causing it to slide towards the tips of the forks.

Step 4: Before lowering the cart, make sure that it is not swinging, spinning, etc. Slowly lower the cart until there is slack in the hoist cable/chain or the forks are loose inside the fork tubes. Disconnect the cart from the hoist, or dismount the cart from the forklift.

### LOADING CYLINDERS ONTO THE CART

Step A. Place the cylinder on the cart. Position the cylinder so that it rests firmly against the crossbars.

Step B. Release the ratchet to extend the strap, if necessary. To release the ratchet, pull the release lever toward the handle and pivot the ratchet handle as far from the ratchet base as it will travel (approximately 180 degrees). By pulling on the strap now, it will unwind from the spindle and increase the usable length. Ratchet parts are identified in Fig. B on p. 6.

Step C. Wrap the ratchet straps around the cylinder and connect to the J-hook to the J-hook slots of the divider.

Step D. Pivot the handle back towards the base and let go of the release lever.

Step E. Tighten the strap against the cylinder by moving the handle towards and away from the base.

Step F. To remove a cylinder from the cart, release strap tension by following the procedure described in step B.

## RECORD OF SATISFACTORY CONDITION (THE "RECORD")

Before using this cart for the first time, create a record of its appearance and features. Photograph the unit from multiple angles so that all features are clearly imaged. Take close range photographs of the ratchets and straps, the divider and its lifting eye, labels, handle grips, wheels, fork pockets, and welds. Collect all writings and photographs in a file. This file is a record of the unit in satisfactory condition. **Compare the results of all inspections to this Record to determine whether the unit is still in satisfactory condition.** Restore the cart to satisfactory condition BEFORE using it again. Cosmetic changes, like damaged surface coating (paint or powdercoat) are not necessarily changes from satisfactory condition. However, touchup paint should be applied as soon as damage occurs to prevent rusting. Left untreated, rusting could compromise the integrity of the affected metal.

## INSPECTING & MAINTAINING THE CYLINDER CART

Inspections and repairs should only be performed by qualified persons. Compare the results of each inspection to the [RECORD OF SATISFACTORY CONDITION](#) (the "RECORD"). Do not use the cart unless all parts are in satisfactory condition. Replace parts that are not in satisfactory condition before using the cart again. **DON'T GUESS! If you have any questions about the condition of your cart, speak with [TECHNICAL SERVICE](#) personnel.** The phone number is provided on the cover page of this manual. **Never make temporary repairs of damaged or missing parts.** Only use manufacturer-approved replacement parts.

Make a dated record of each inspection that includes observations and descriptions of repairs and replacement parts installed.

Inspect the cylinder cart at least once per month.

1. Examine the frame for cracked welds, metal fatigue, rust, and corrosion that affects the structural integrity of the cart. The structure should be clean, square and rigid, and free of rust and corrosion. Remove dirt and debris.

2. Check the ratchets and straps. Confirm satisfactory operation and condition. Replace damaged straps and ratchets.
3. Labels: Confirm that all labels shown in the LABELING DIAGRAM are present, undamaged and easily readable. Order replacements for any labels that are missing or not easily readable.
4. Inspect the fork pockets. Each pocket should be square, rigid and structurally sound.
5. Lifting eye. Confirm that the opening is not elongated, widened, etc. The metal surrounding the eye should not be cracked, warped, etc.

## LABELING DIAGRAM

Label content and location are subject to change, and therefore, your product might not be labeled exactly as shown in the diagram below. If the labels applied to your unit differ from those shown in the diagram, contact [TECHNICAL SERVICE](#) and report the inconsistency. Thoroughly photograph the unit when you first receive it as discussed in the [Record of Satisfactory Condition](#) section on p. 7. Make sure that your Record includes at least 1 photograph of each label. Replace all labels that are, or later become, damaged, missing, or not easily readable (e.g. faded). To order replacement labels, contact the [Technical Service & Parts Department](#) online at <https://www.vestil.com/page-parts-request.php> or by calling (260) 665-7586 and asking the operator to connect you to the [Parts Department](#).

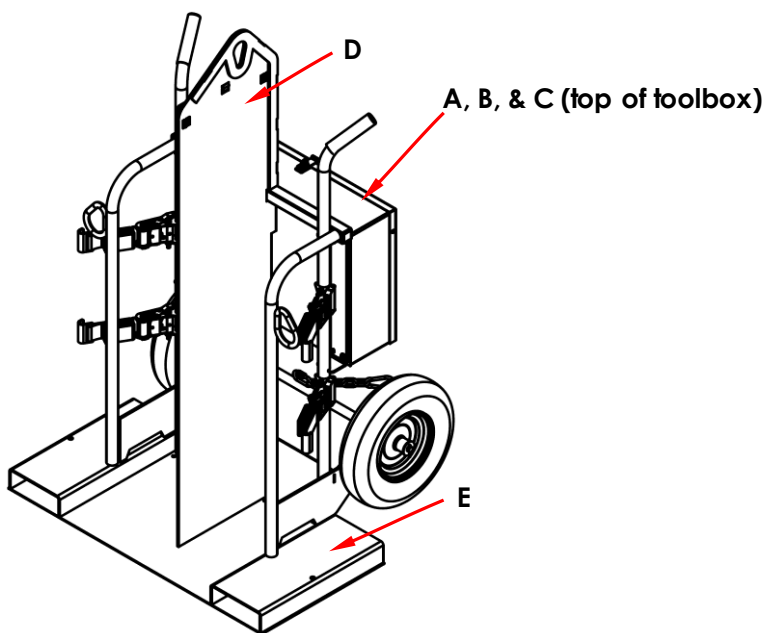

### A: Label 1153

MODEL / MODELO / MODÈLE _____
WEIGHT / PESO / MASS _____
CAPACITY / CAPACIDAD / CAPACITÉ _____
SERIAL / SERIE / SÉRIE _____
UNITS: 2.2 lb. = 1kg      1" (or 1in.) = 2.54cm      1153

### B: Label 821

	<b>WARNING</b>
	Risk of serious injury or death. Read and understand entire owner's manual BEFORE using.

### C: Label 658

⚠ WARNING	⚠ ADVERTENCIA	⚠ AVERTISSEMENT
Donot operate or move with unstable loads DO NOT LOAD beyond rated capacity DISTRIBUTE LOAD EVENLY DO NOT sit or ride	No use a mueva con cargas inestables No cargue mas de la capacidad tasada DISTRIBUYA LA CARGA A NIVEL NO SE SIENTE o vaya en el carro	Ne pas utiliser avec une charge instable NE PAS CHARGER au-delà du débit nominale DISTRIBUER la charge régulièrement NE PAS VOUS ASSEOIR OU VOUS PROMENER sur le chariot

### D: Label 286

⚠ WARNING	⚠ ADVERTENCIA
ONLY use to transport cylinders; DO NOT use as a storage device. Secure cylinder to dolly with all restraints For your safety, read all warnings on the cylinder	SOLO use para transportar cilindros NO USE como dispositivo de almacenaje Asegure el cilindro a la plataforma con todas las correas Para su seguridad, lea todas las advertencias en el cilindro

### E: Label 1210

<b>WARNING</b>
Unsafe use of this front end attachment creates risks of serious personal injuries and/or death.
<ul style="list-style-type: none"> <li>• DO NOT use this front end attachment with rough terrain lift trucks or telehandlers (boom lifts).</li> <li>• ONLY use this attachment with high lift fork trucks utilizing a vertical mast and carriage.</li> <li>• DO NOT operate truck with attachment on unimproved surfaces. ONLY operate the truck with the attachment on concrete or asphalt surfaces capable of supporting the truck and a full capacity load.</li> </ul>





## LIMITED WARRANTY

Vestil Manufacturing Company ("Vestil") warrants this product to be free of defects in material and workmanship during the warranty period. Our warranty obligation is to provide a replacement for a defective, original part covered by the warranty after we receive a proper request from the Warrantee (you) for warranty service.

### Who may request service?

Only a warrantee may request service. You are a warrantee if you purchased the product from Vestil or from an authorized distributor AND Vestil has been fully paid.

### Definition of "original part"?

An original part is a part used to make the product as shipped to the Warrantee.

### What is a "proper request"?

A request for warranty service is proper if Vestil receives: 1) a photocopy of the Customer Invoice that displays the shipping date; AND 2) a written request for warranty service including your name and phone number. Send requests by one of the following methods:

US Mail  
Vestil Manufacturing Company  
2999 North Wayne Street, PO Box 507  
Angola, IN 46703

Fax  
(260) 665-1339  
Phone  
(260) 665-7586

Email  
[info@vestil.com](mailto:info@vestil.com)  
Enter "Warranty service request" in the subject field.

In the written request, list the parts believed to be defective and include the address where replacements should be delivered. After Vestil receives your request for warranty service, an authorized representative will contact you to determine whether your claim is covered by the warranty. Before providing warranty service, Vestil will require you to send the entire product, or just the defective part (or parts), to its facility in Angola, IN.

### What is covered under the warranty?

The warranty covers defects in the following original, dynamic parts: motors, hydraulic pumps, motor controllers, and cylinders. It also covers defects in original parts that wear under normal usage conditions ("wearing parts"), such as bearings, hoses, wheels, seals, brushes, and batteries.

### How long is the warranty period?

The warranty period for original dynamic components is 90 days. For wearing parts, the warranty period is 90 days. Both warranty periods begin on the date Vestil ships the product to the Warrantee. If the product was purchased from an authorized distributor, the periods begin when the distributor ships the product. Vestil may, at its sole discretion, extend a warranty period for products shipped from authorized distributors by up to 30 days to account for shipping time.

### If a defective part is covered by the warranty, what will Vestil do to correct the problem?

Vestil will provide an appropriate replacement for any covered part. An authorized representative of Vestil will contact you to discuss your claim.

### What is not covered by the warranty?

The Warrantee (you) is responsible for paying labor costs and freight costs to return the product to Vestil for warranty service.

### Events that automatically void this Limited Warranty.

- Misuse;
- Negligent assembly, installation, operation or repair;
- Installation/use in corrosive environments;
- Inadequate or improper maintenance;
- Damage sustained during shipping;
- Collisions or other accidents that damage the product;
- Unauthorized modifications: Do not modify the product IN ANY WAY without first receiving written authorization from Vestil.

### Do any other warranties apply to the product?

Vestil Manufacturing Co. makes no other express warranties. All implied warranties are disclaimed to the extent allowed by law. Any implied warranty not disclaimed is limited in scope to the terms of this Limited Warranty. Vestil makes no warranty or representation that this product complies with any state or local design, performance, or safety code or standard. Noncompliance with any such code or standard is not a defect in material or workmanship.