

Instruction Manual

Drum Pallerizer



Note: The Owner/Operator must read carefully and understand all the information presented here before operation.

THANK YOU FOR USING THIS DRUM PALLERIZER. FOR YOUR SAFETY AND CORRECT OPERATION, PLEASE CAREFULLY READ THIS INSTRUCTION BEFORE USING IT.

NOTE: All of the information reported herein is based on data available at the moment of printing. The factory reserves the right to modify its own products at any moment without notice and incurring in any sanction. So it is suggested to always verify possible updates.

1. SPECIFICATION

Model	DJ365
Capacity	365kg / 800lbs
Acceptable Drum Style	55 gallon, steel
Overall Size L×W×H	1250*1100*1250 mm
Net Weight	60kg
Wheel (poly) Dia*Width	D150*50, D100*32mm

2. NOTICE

- 2.1 Do not operate this pallerizer more than 70m/min speed when overloading.
- 2.2 Do not operate the pallerizer unless you are trained and authorized.
- 2.3 Please operate the pallerizer on the hard surface.
- 2.4 Please push the drum when operating the pallerizer.

3. OPERATION

- 3.1 Clamp the pawl handle for putting the handle on the top position.
- 3.2 Push the drum near the pallet, the big hook button up the drum while two small hooks button up the side of drum, then pull the handle until the lowest position.
- 3.3 When release the drum, press the handle down, then clamp the pawl

handle and lower the handle slowly to put the drum on the ground.

4. EXPLODED VIEW & PART LIST

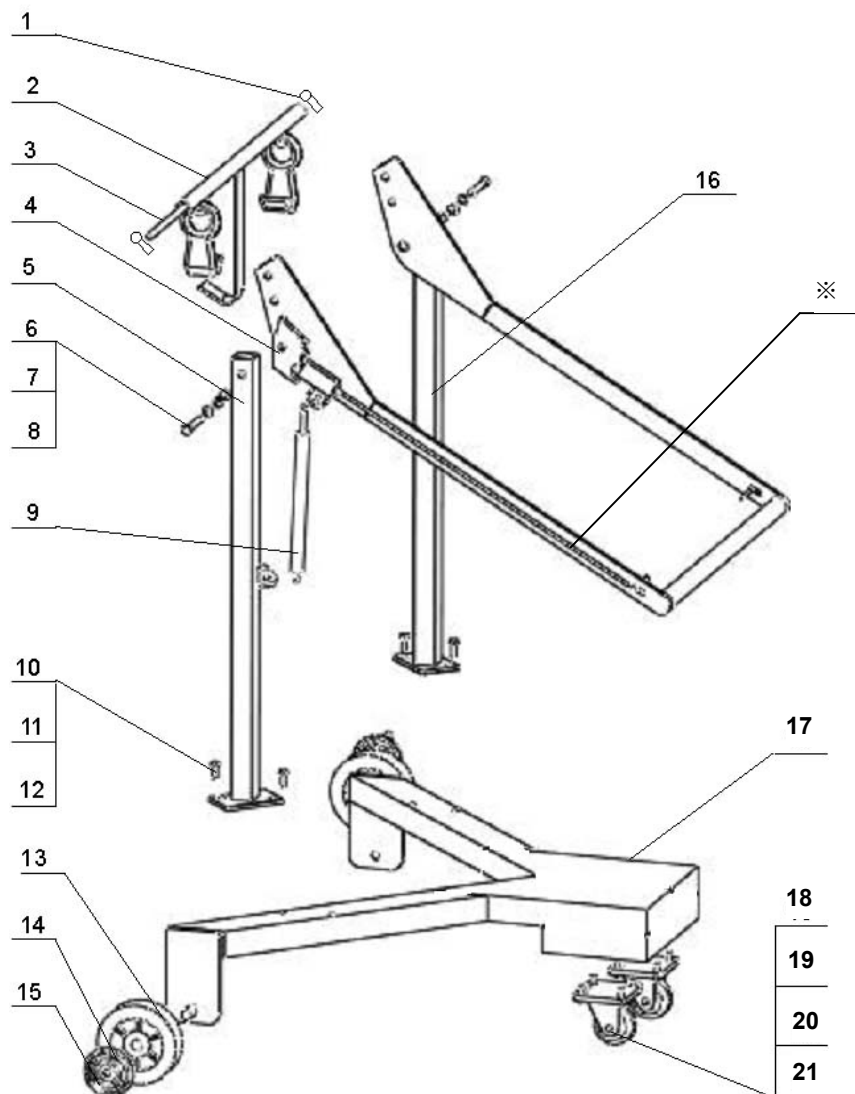

No.	Description	Qty	Remark
1.	Split pin	2	Φ 3.2*32
2.	Hook assembly	1	
3.	Pipe core	1	
4.	Handle assembly	1	
5.	Left columniation	1	
6.	Hex bolt	2	M12*80
7.	Flat washer	4	Φ 12
8.	Hex nut	2	M12
9.	Pneumatic columniation	1	
10.	Hex bolt	4	M10*70
11.	Flat washer	8	Φ 10
12.	Hex nut	4	M10
13.	Wheel	2	Φ 150
14.	Wheel shield	2	
15.	Hex nut	2	M12
16.	Right columniation	1	
※	Pawl handle	2	
17.	Pedestal	1	
18.	Swivel wheel	2	Φ 100
19.	Hex bolt	8	M10*20
20.	Flat washer	8	Φ 10
21.	Spring washer	8	Φ 10

NOTE: “※” had been contained in No 4 (the hand assembly)