

High Density Mobile Storage System

Assembly Instruction

Optional Joining Insert

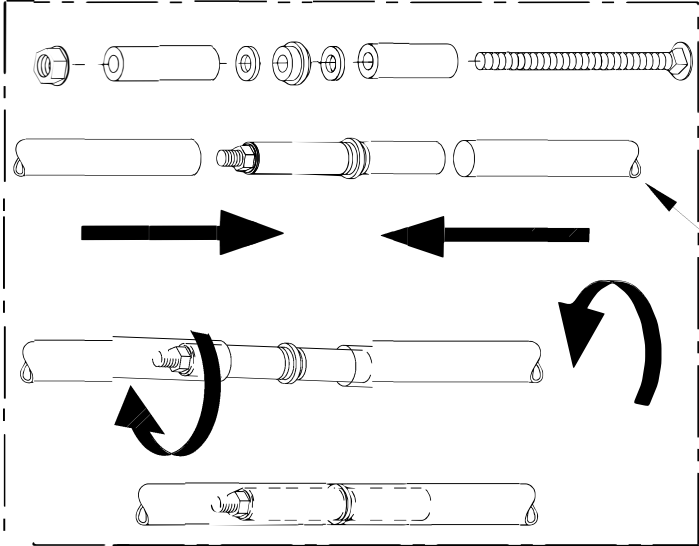

CONTENTS

REF.	QTY.	DESCRIPTION
1		LOCKING COLLAR (4) PER STATIONARY UNIT
2		GUIDE BLOCK (4) PER MOBILE UNIT
3		GUIDE BAR
4	1	ALLEN KEY
5	4	END CAP

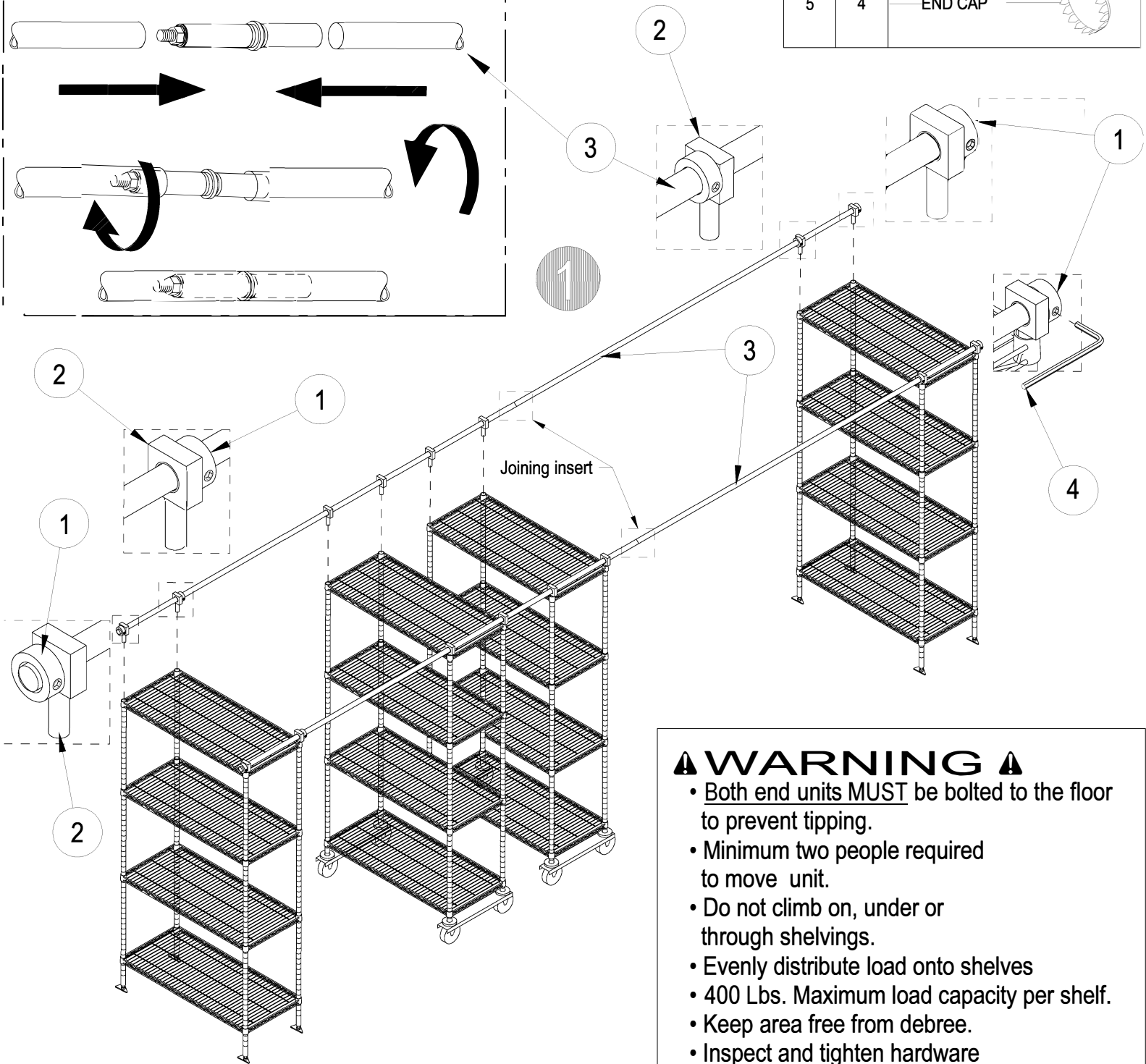

⚠ WARNING ⚠

- Both end units **MUST** be bolted to the floor to prevent tipping.
- Minimum two people required to move unit.
- Do not climb on, under or through shelvings.
- Evenly distribute load onto shelves
- 400 Lbs. Maximum load capacity per shelf.
- Keep area free from debris.
- Inspect and tighten hardware every six months.
- Replace rusted hardware and damaged components.

