



tradeSELECT®

**INTERACTIVE MENU**

- Ordering Guide
- Photometric Data
- Dimensional Data

**PROJECT INFORMATION**

Project Name \_\_\_\_\_

Type \_\_\_\_\_

Catalog No. \_\_\_\_\_

Date \_\_\_\_\_

**FEATURES**

- Lumen packages range from 11,000 to 27,000 lumens in a 2ft housing
- Frosted acrylic lens
- LED light engine provides nominal efficacies of 130 lm/w
- 0-10V dimming to 10%
- Universal voltage standard (120-277V); 347V, 480V optional
- 80+ CRI
- 6kV surge protection
- Long life LEDs with projected life over 122,000 hours at L<sub>70</sub>
- DLC® (DesignLights Consortium) Premium Qualified - see [www.designlights.org](http://www.designlights.org)



**CHB Linear High Bay**

**CONSTRUCTION**

Painted after fabrication full body steel housing constructed for shipment and job site durability. Channel includes top and side knockouts for simple and accessible wiring.

**ELECTRICAL**

Efficient LED light engine (nominal 130 lm/w) with long life (122,000 hours, calculated) LEDs. Driver is 6kV surge protected and available in 120-277V standard or 347V, 480V. 0-10V standard with dimming range of 100% to 10%.

**MOUNTING**

V-hook and chain hanger are standard with each luminaire. Additional mounting options include surface mounting with the use of tong brackets and a single point stem (pendant) mount; refer to Accessories table for details.

**OPTICS**

Optical grade PMMA with diffusion for distribution control and glare reduction.

**STANDARDS, CERTIFICATION AND COMPLIANCE**

All luminaires are built to UL1598 standards, and bear appropriate cULus labels for damp location. DLC® (DesignLights Consortium) Premium Qualified. Please refer to the DLC website for specific product qualifications at [www.designlights.org](http://www.designlights.org).

**WARRANTY**

Five year warranty (Terms and Conditions apply).

**STOCK**

CATALOG NUMBER	DESCRIPTION	LUMENS	WATTS	LM/W	QTY ON PALLET	FLUORESCENT REPLACEMENT
CHB2-40LX-FA-EDU	2' LED High Bay, 4000K, 0-10V dimming, 120-277V	11,380	87.7	130	44	4-lamp HLT8,
CHB2-50LX-FA-EDU	2' LED High Bay, 5000K, 0-10V dimming, 120-277V	11,483	87.7	131	44	2-lamp T5HO
CHB2-40ML-FA-EDU	2' LED High Bay, 4000K, 0-10V dimming, 120-277V	17,013	132.6	128	44	6-lamp T8
CHB2-50ML-FA-EDU	2' LED High Bay, 5000K, 0-10V dimming, 120-277V	17,105	131.7	130	44	
CHB2-40MH-FA-EDU	2' LED High Bay, 4000K, 0-10V dimming, 120-277V	21,949	172.7	127	44	6-lamp HLT8,
CHB2-50MH-FA-EDU	2' LED High Bay, 5000K, 0-10V dimming, 120-277V	22,038	172.4	128	44	4-lamp T5HO
CHB2-40MV-FA-EDU	2' LED High Bay, 4000K, 0-10V dimming, 120-277V	27,343	211.9	129	22	8-lamp HLT8,
CHB2-50MV-FA-EDU	2' LED High Bay, 5000K, 0-10V dimming, 120-277V	27,522	212.9	129	22	6-lamp T5HO

## ORDERING INFORMATION

EXAMPLE CHB2-40ML-FA-EDU

YOUR ORDER **CHB2 - - FA - ED -**

CHB	2	-	-	FA	-	ED	-	-	
MODEL	SIZE	COLOR TEMP	LUMEN OUTPUT (NOMINAL)	LENS	DRIVER	VOLTAGE	OPTIONS		
CHB Linear High Bay	2 2'	40 4000K 50 5000K	LX Low Extra High Lumen (11,000) ML Medium Low Lumen (17,000) MH Medium High Lumen (22,000) MV Medium Very High Lumen (27,000)	FA Frosted Acrylic	ED 0-10V Dimming	U 120-277V 347 347V 480 480V	<b>ELL14</b> Emergency Battery Pack, 1700lm <sup>1</sup> <b>OS1360</b> Factory-Installed End Mount PIR Occupancy Sensor, On-Off & Time Delay. 1:1 Mounting Height to Coverage Ratio <sup>1</sup> <b>ODS1360</b> Factory Installed End Mount Microwave Occupancy/Daylight Sensor, Dimming. 1:1 Mounting Height to Coverage Ratio <sup>1</sup> <b>C6TL152</b> 6' cord and Twist-Lock® Plug, 277V, 15A <sup>2</sup> <b>C6TL202</b> 6' cord with Twist-Lock® Plug, 277V, 20A <sup>2</sup> <b>F3C6</b> 3-conductor cord, 6ft <b>F4C6</b> 4-conductor cord, 6ft <sup>3</sup> <b>F5C6</b> 5-conductor cord, 6ft <b>F6C6</b> 6-conductor cord, 6ft <sup>3</sup>		

### ACCESSORIES (ORDER SEPARATELY)

- CHB-WG-N** Wire Guard Kit, Narrow, for LX, ML, and MH models
- CHB-WG-W** Wire Guard Kit, Wide, for MV model
- CHB-SMK-N** Surface Mount Kit, Narrow, for LX, ML, and MH Models
- CHB-SMK-W** Surface Mount Kit, Wide, for MV model
- CHB-PMK-SM** Pendant Mount Kit, Small, for LX model
- CHB-PMK-LG** Pendant Mount Kit, Large, for ML, MH, and MV models
- HBMS-REMOTE** Dimming Sensor Commissioning Remote Control

<sup>1</sup> Not available with 347V or 480V.  
<sup>2</sup> Only for use with 277V; select "U" voltage option.  
<sup>3</sup> Available with ELL14 only.

## PHOTOMETRIC DATA

Test# RKS180522019-10 Test Date 8/14/2018

### LUMINAIRE DATA

Luminaire	CHB2-40ML-FA-EDU Commercial Linear LED, Highbay 12.5" x 24" LED luminaire with frosted acrylic lens
Ballast	EDU
Ballast Factor	1.00
Lamp	LED 4000K
Fixture Lumens	17401
Watts	132.66
Mounting	Recessed
Shielding Angle	0° = 90 90° = 90
Spacing Criterion	0° = 1.24 90° = 1.24
Luminous Opening in Feet	Length: 1.90 Width: 0.95 Height: 0.00

### ZONAL LUMEN SUMMARY

Zone	Lumens	% Lamp	% Fixt.
0-30	5243	30.1	30.1
0-40	8509	48.9	48.9
0-60	14424	82.9	82.9
0-90	17401	100.0	100.0
0-180	17401	100.0	100.0

### ENERGY DATA

Total Luminaire Efficiency	100.0%
Total Lumens per Watt	131
IESNA RP-1-2004 Compliance	Non-Compliant
Comparative Yearly Lighting Energy Cost per 1000 Lumens	\$1.83 based on 3000 hrs. and \$0.08 per KWH

### INDOOR CANDELA PLOT

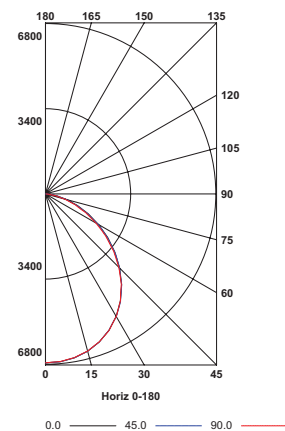

Test# RKS180522020-10 Test Date 8/14/2018

### LUMINAIRE DATA

Luminaire	CHB2-40MH-FA-EDU Commercial Linear LED, Highbay 12.5" x 24" Led luminaire with frosted acrylic lens
Ballast	EDU
Ballast Factor	1.00
Lamp	LED 4000K
Fixture Lumens	22550
Watts	172.79
Mounting	Recessed
Shielding Angle	0° = 90 90° = 90
Spacing Criterion	0° = 1.24 90° = 1.24
Luminous Opening in Feet	Length: 1.90 Width: 0.95 Height: 0.00

### ZONAL LUMEN SUMMARY

Zone	Lumens	% Lamp	% Fixt.
0-30	6808	30.2	30.2
0-40	11052	49.0	49.0
0-60	18707	83.0	83.0
0-90	22550	100.0	100.0
0-180	22550	100.0	100.0

### ENERGY DATA

Total Luminaire Efficiency	100.0%
Total Lumens per Watt	131
IESNA RP-1-2004 Compliance	Non-Compliant
Comparative Yearly Lighting Energy Cost per 1000 Lumens	\$1.85 based on 3000 hrs. and \$0.08 per KWH

### INDOOR CANDELA PLOT

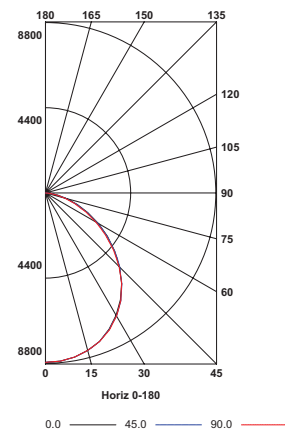

**DIMENSIONAL DATA**

End View – LX Model

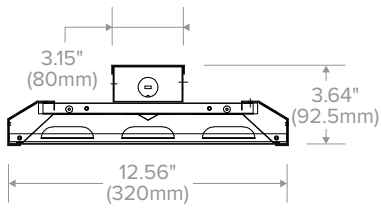

Weight: 11lbs

End View – ML, MH Models

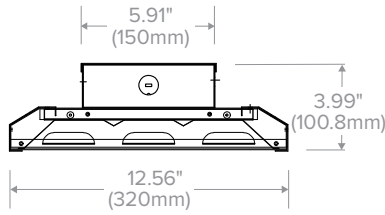

Weight: 13.5lbs

End View – MV Model

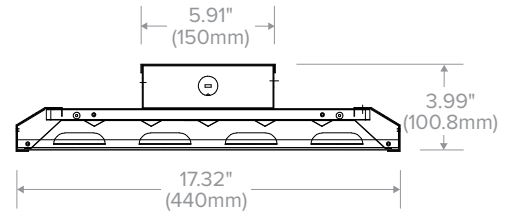

Weight: 16lbs

Side View – All Models

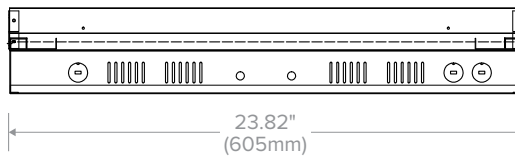

**MOUNTING OPTIONS**

Chain Hanger (Standard)



Surface Mount (Optional)



Pendant Mount (Optional)

