

# CONTENTS

REF.	QTY.	DESCRIPTION
1	1	POST
2	1	BRACKET
3	1	GRILL ASSEMBLY
4	1	BACK PLATE
H1	5	M12 x 1.75 x 32mm Lg. Carriage Bolt
H2	7	Ø 24 x 13.x 2 mm Plain Washer
H3	7	Ø 20 x 13 x 3 mm Split Washer
H4	7	M12 Hex Nut
H5	2	M12 x 1.75 x 32mm Lg. Carriage Bolt (with internal thread)
H6	2	M8 x 1.5 x 20mm Lg. Torx (6 Lobular)
H7	2	Ø 16 x 8.5 x 3 mm Washer



US: 888-628-3466  
 Canada: 888-645-2986  
 Mexico: 01.800.681.6940

## OUTDOOR PARK GRILL

MODEL 695299  
 ASSEMBLY INSTRUCTION

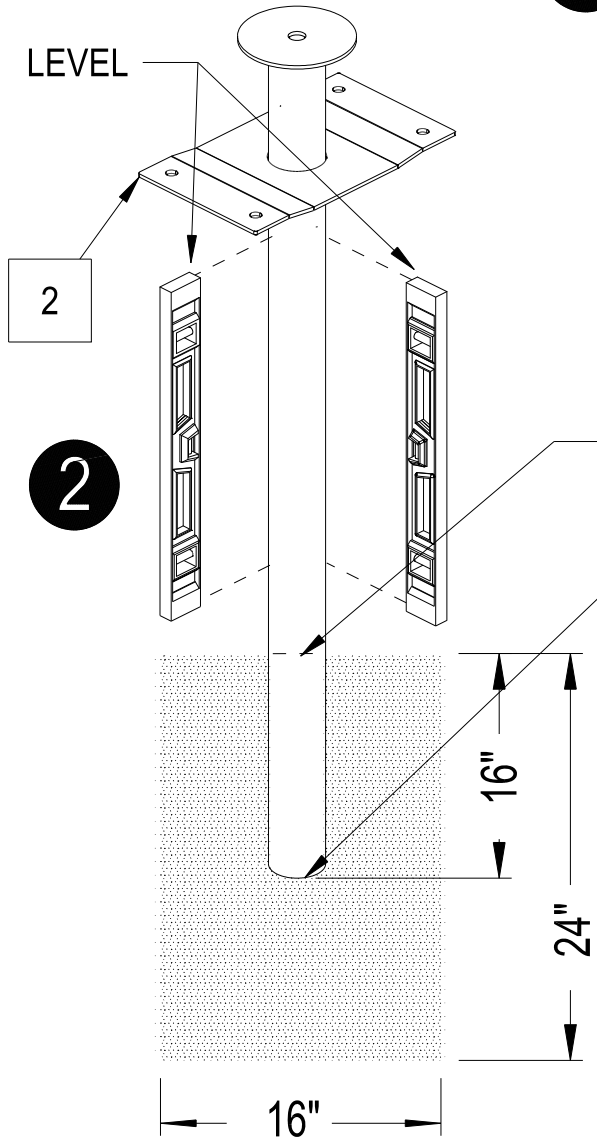
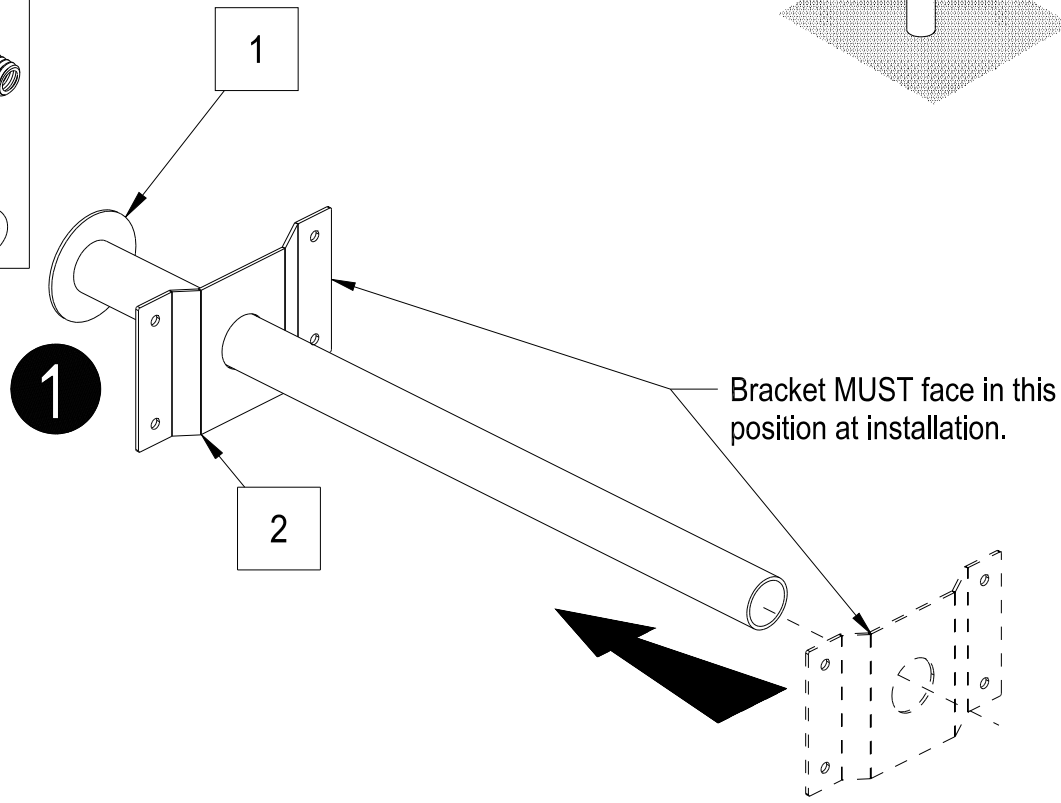
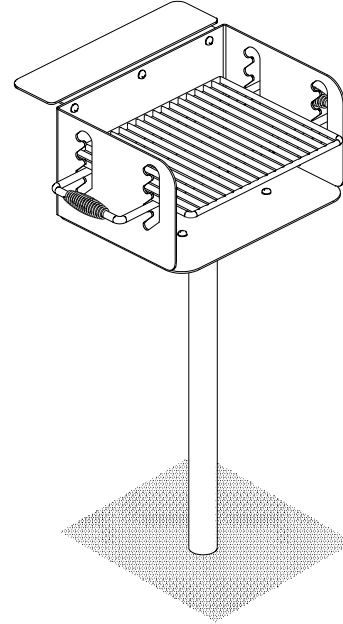

1. Dig hole approximately 16" x 16" x 24" as shown.
2. Mix concrete using the proper ratio of sand and cement.
3. Pour concrete into hole flush to surface.
4. Mark a line on the Post 16" up from the bottom.
5. Insert Post into freshly mixed concrete until marked line is flush with surface.
6. Align post using a Level as shown. (brace post appropriately for proper setting in concrete).
7. Allow concrete to cure completely before assembling the unit.

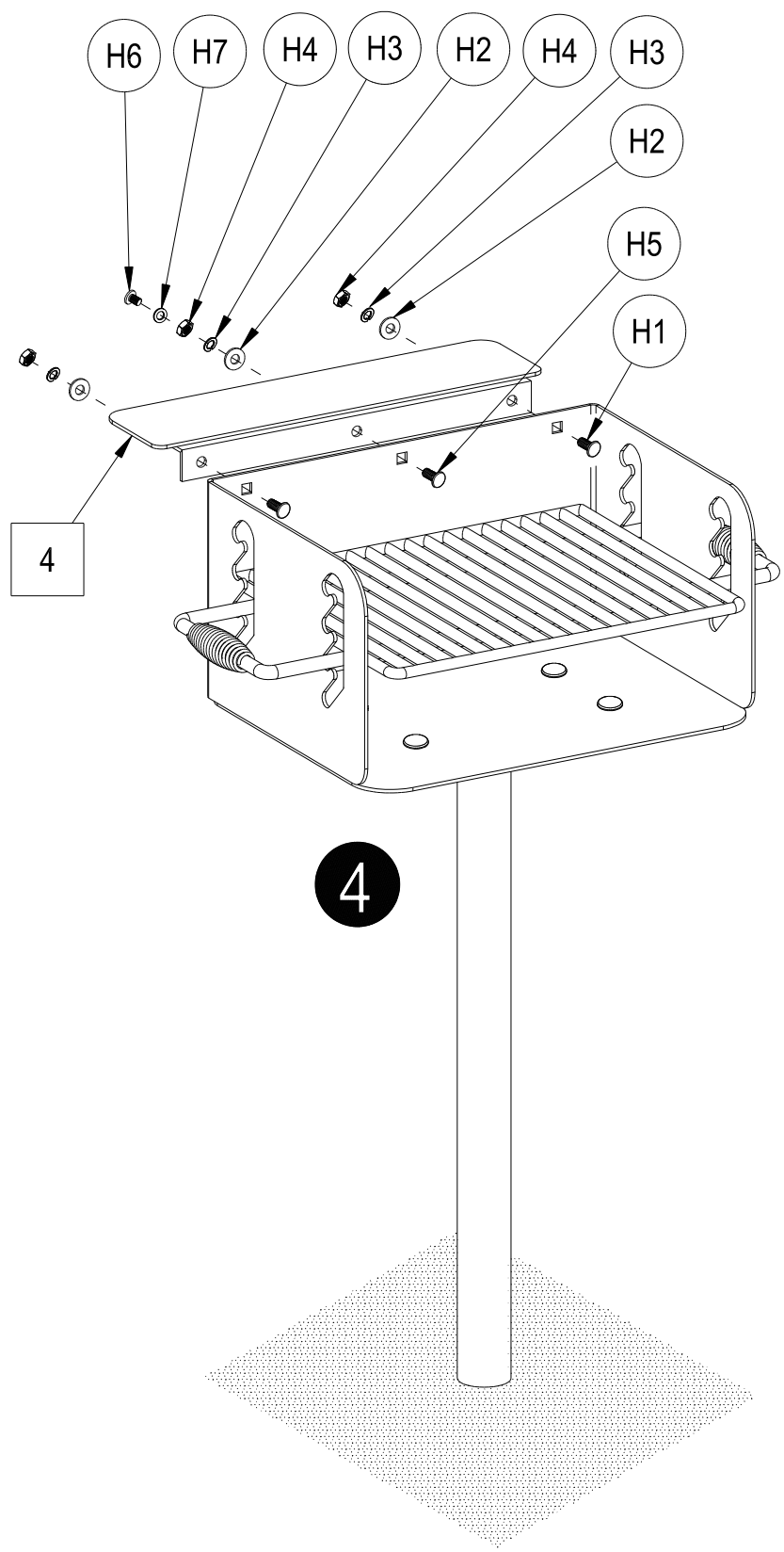
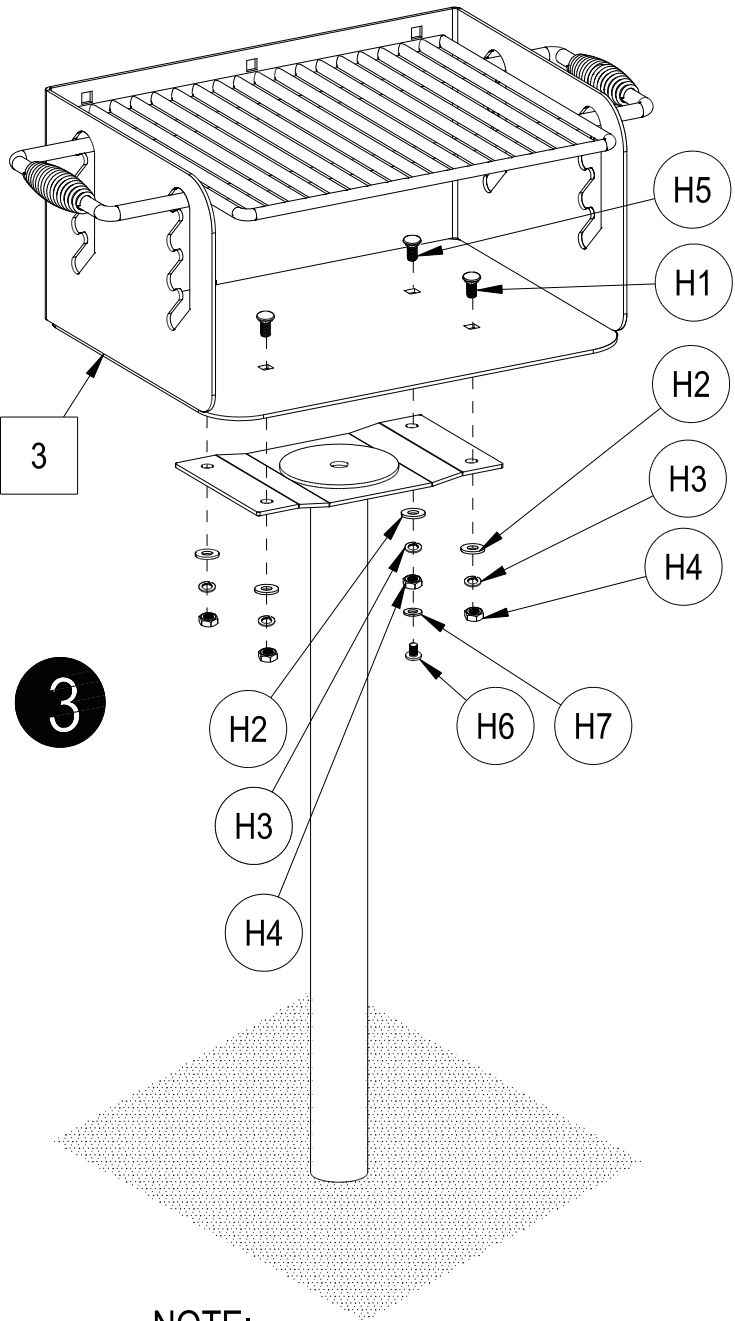

NOTE:  
Assemble unit after cement is cured

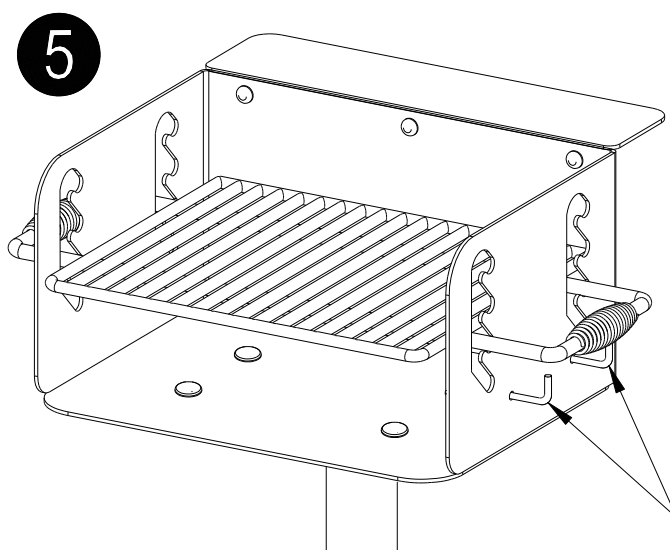

Utensil holder

# PARILLA AL AIRE LIBRE LIBRE DE PARQUE

MODELO 695299  
INTRUCCIÓN DE ENSAMBLAJE

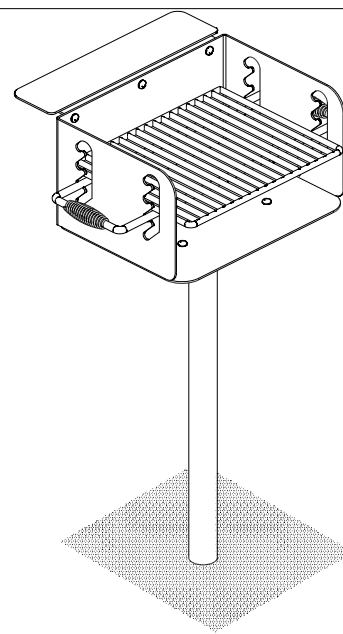

CONTENIDO		
REF.	CANT.	DESCRIPCIÓN
1	1	POSTE
2	1	SOPORTE
3	1	ENSAMBLAJE DE LA PARILLA
4	1	PLACA TRASERA
H1	5	Perno de Carruaje M12 x 1.75 x 32mm Lg
H2	7	Áranda plana 24 x 13 x 2 mm
H3	7	Áranda partida 20 x 13 x 3 mm
H4	7	Tuerca hexagonal M12
H5	2	Perno de carruaje (con rosca interior)
H6	2	Tornillo de sujetador (6 estrella) M8 x 1.5 x 20mm Lg.
H7	2	Áranda 16 x 8.5 x 3 mm

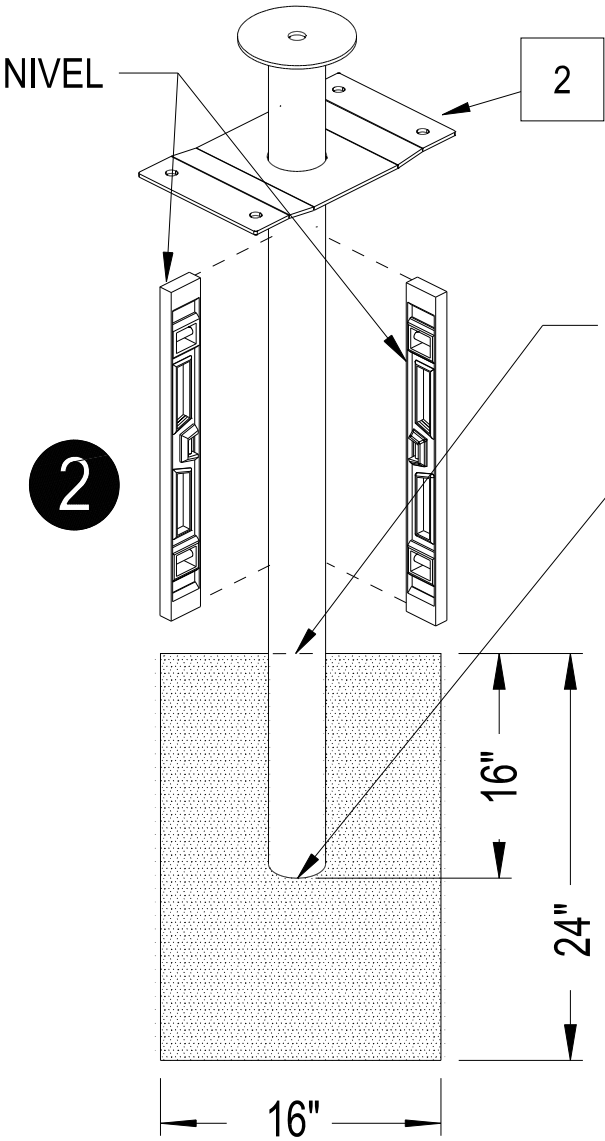
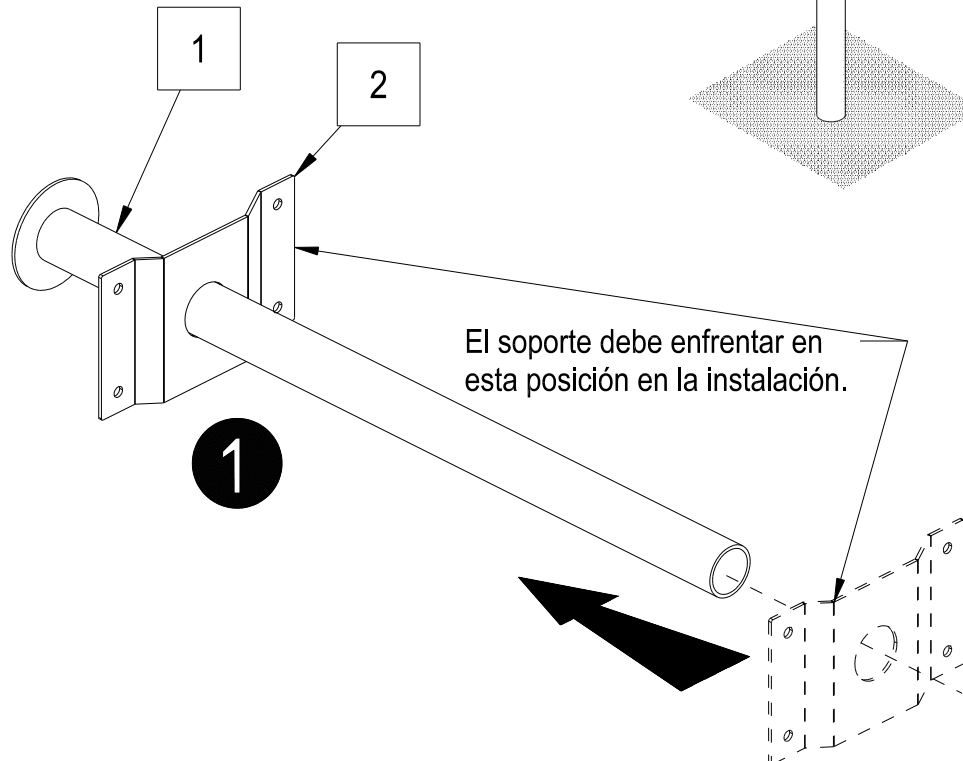

1. Escave un agujero de aproximadamente 18" x 18" x 30" como se muestra.
2. Mezcle concreto usando la proporción apropiada de arena y cemento.
3. Vierta el concreto en el agujero a ras de la superficie.
4. Marque una línea en el poste a 18" de la parte inferior.
5. Inserte el poste en la mezcla fresca de concreto hasta que la línea marcada quede al ras de la superficie.
6. Alinee el poste usando un nivel como se indica.

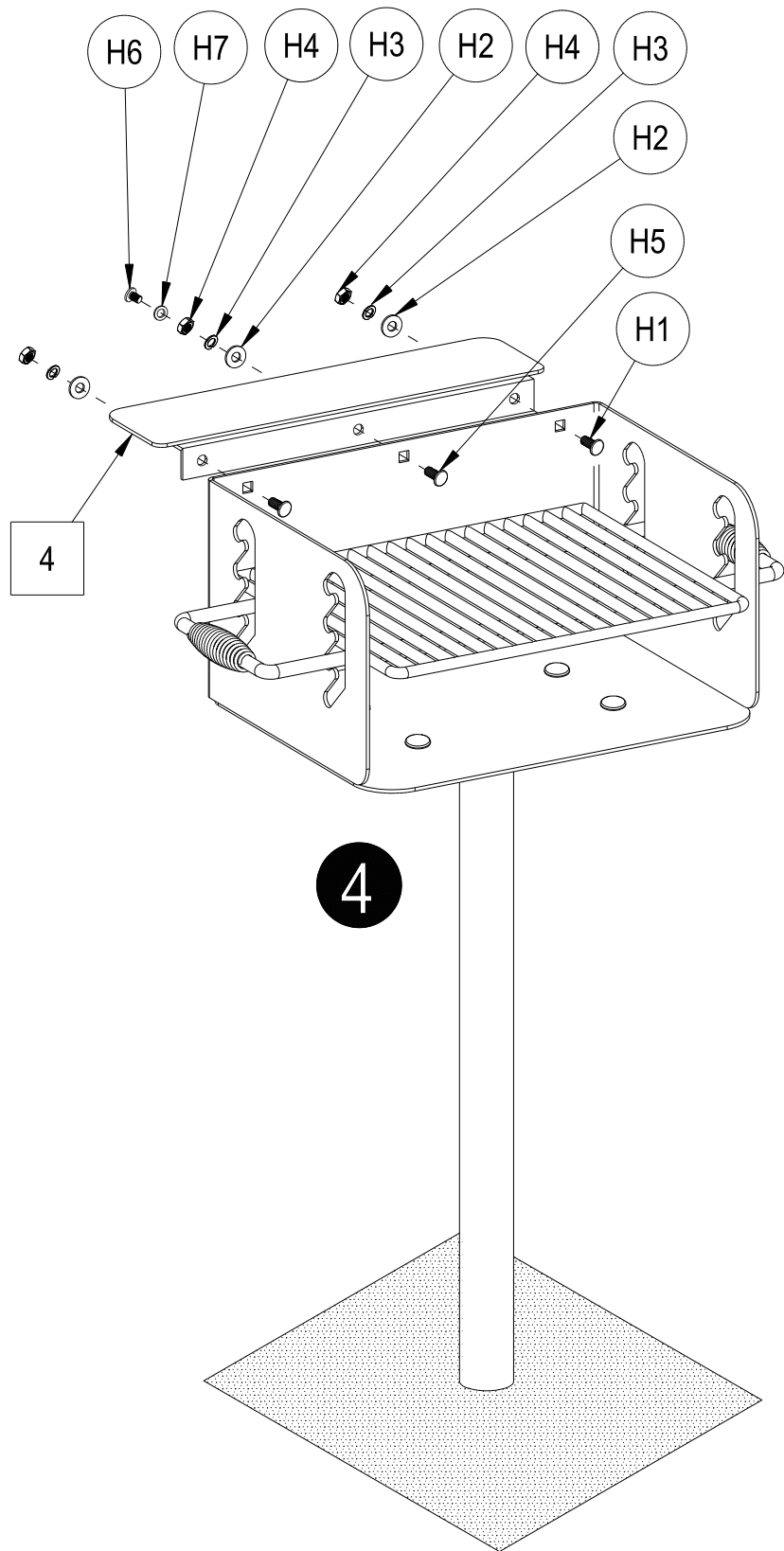
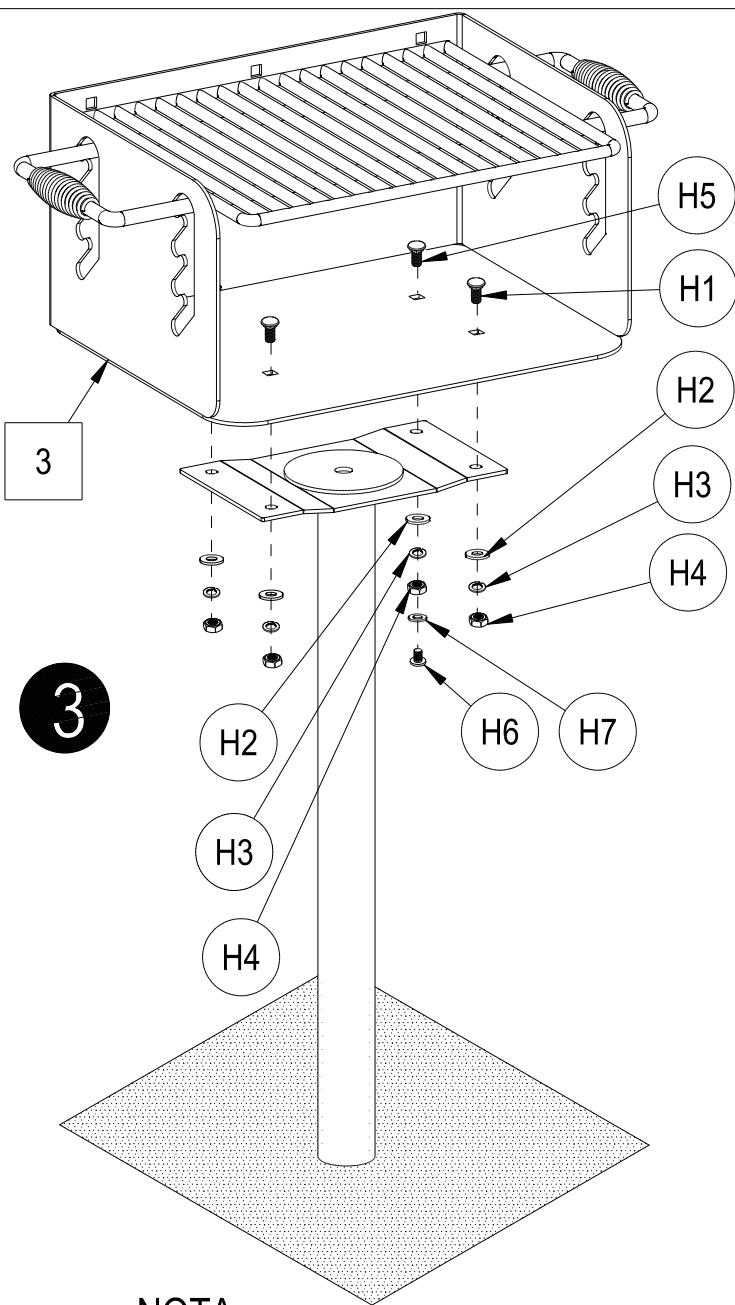

NOTA:  
Monte la unidad después de  
que el cemento esté curado.

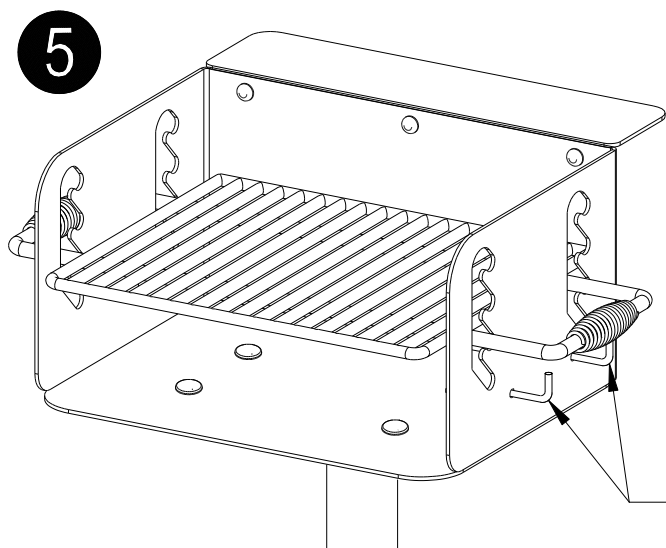

Sostenedor de utensilio