

Customer Service  
1-800-645-2986



Assembly  
Instructions

## Metal Mesh Bench with Back

Perforated Metal Steel Bench With Back  
Model No.262077BL/BK/GN/RD/GY  
Model No.694557BL/BK/GN/RD/GY  
Model No.695744BL/BK/GN/RD/GY

Expanded Metal Steel Bench With Back  
Model No.277155BL/BK/GN/RD/GY  
Model No.277154BL/BK/GN/RD/GY  
Model No.695743BL/BK/GN/RD/GY

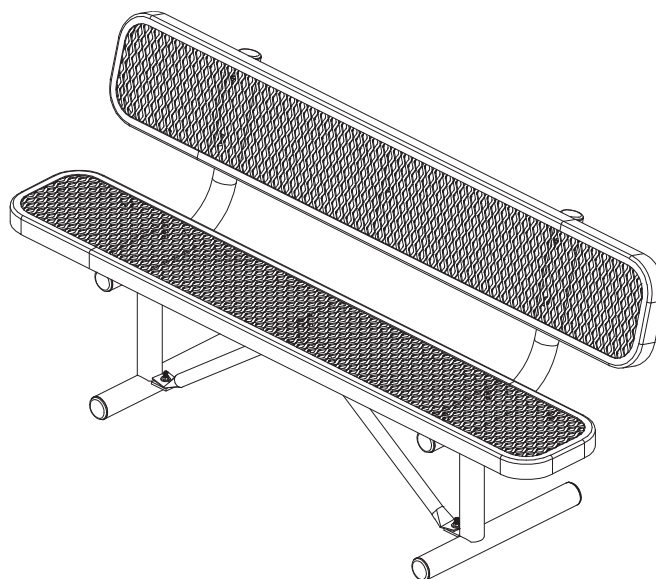

These assembly instructions and warnings should be retained by maintenance or safety department for future reference. Routine maintenance and inspection of the equipment should be performed every six months. Damaged and worn parts should be removed from service until replaced or repaired to prevent safety hazards.

### **⚠ WARNING ⚠**

- Assembly and installation of equipment should be performed by 2 people.
- Workers should use OSHA approved safety and lifting equipment.

### **⚠ WARNING**

- This product contains chemicals which are known by the state of California to cause cancer, birth defects or other reproductive harm.

### **⚠ WARNING ⚠**

- Do not climb on, under or through tables and benches.
- Two people required to move tables and benches.
- Do not use if any parts of bench or table are broken or damaged.
- Inspect and tighten hardware every six months.
- Replace rusted hardware and damaged components.

# Metal Mesh Bench with Back

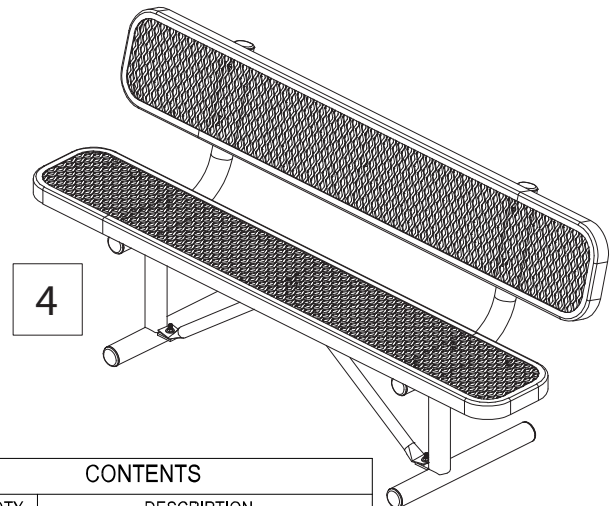
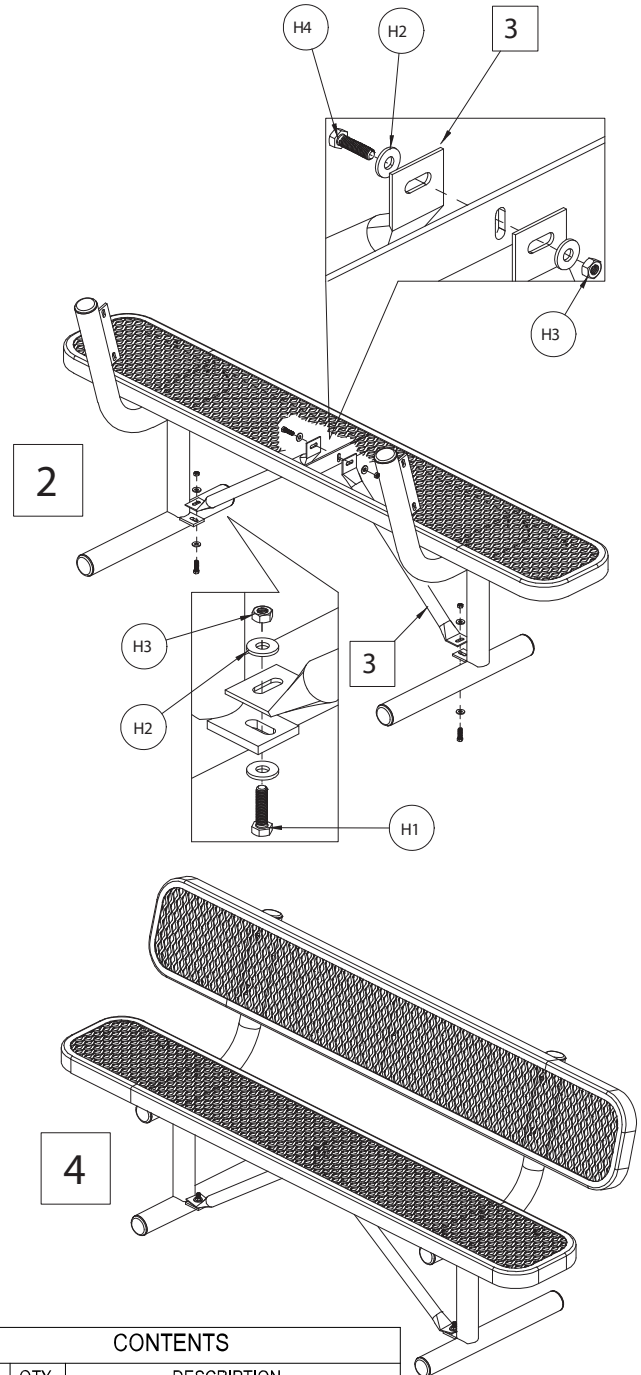
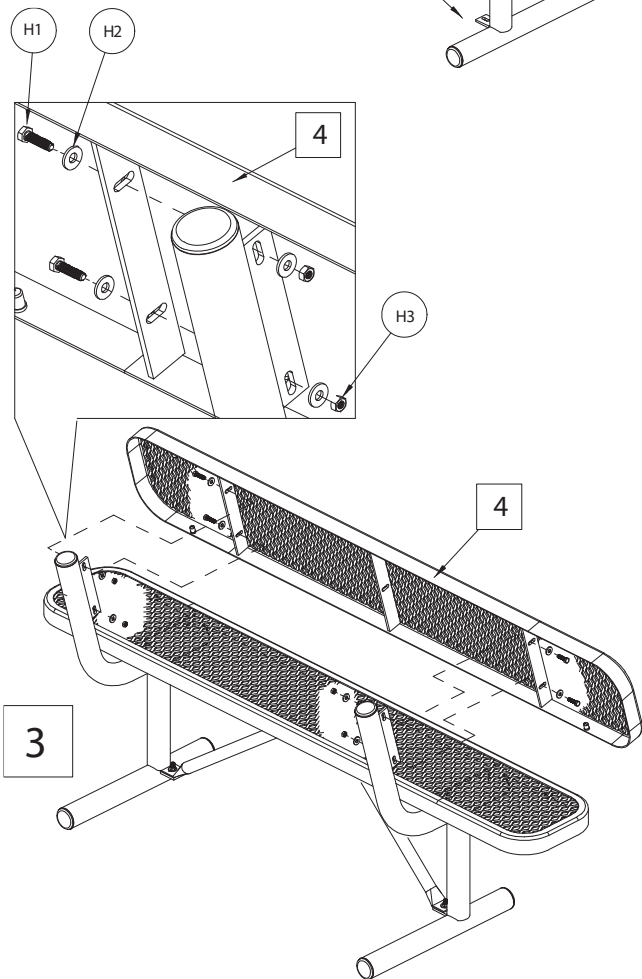
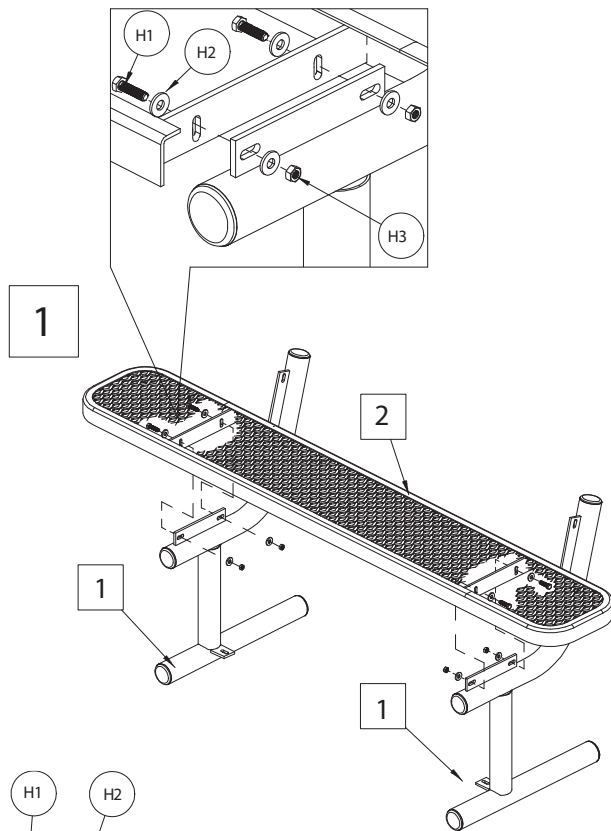

CONTENTS		
REF.	QTY.	DESCRIPTION
1	2	Leg
2	1	Seat
3	2	Leg Support
4	1	Back Rest
H1	10	M8 x 1.25 x 24mm Lg. Hex Bolt
H2	22	Plain Washer
H3	11	M8 x 1.25 Nylon Lock Nut
H4	1	M8 x 1.25 x 35mm Lg. Hex Bolt

277CP23