

Solar Garden Light

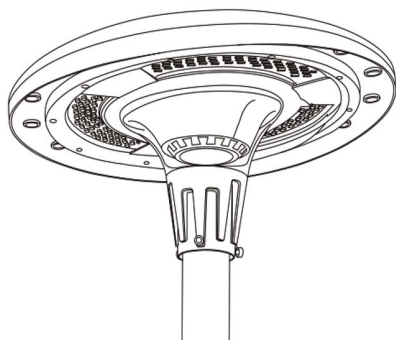

Product Overview

This well-built RGB UFO Post Light can be controlled by its supplied 2.4G remote control and/or Smart Phone. The light also has a day night/photocell sensing function that will be automatically ON/OFF by programed profiles from dusk-to-dawn all year round.

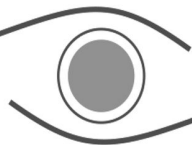

Operating Manual

(EE820W-RH15N, EE825W-RH18N)

Operating Instructions

Packing List

1.Light Body	2. 3" / 78mm Casing Tube	3.Remote Controller
4. Operating Manual	5.Screws	

Installation

Test the unit w/ control

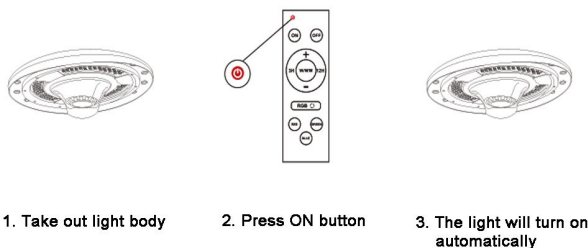

4. Need to placing the solar panel towards the sunlight, the unit will turn OFF automatically and the charging indicator will flash regularly during daytime

Installation

Set the light unit on the pole

- Set the unit on the pole (3" diameter) and lock tightly with provided screws.
- Install the light unit at the height of 10-15FT/3-5 metter with most 3" diameter pole and ensure the installation is secured and safe (May consult local contractor or engineering tech.)

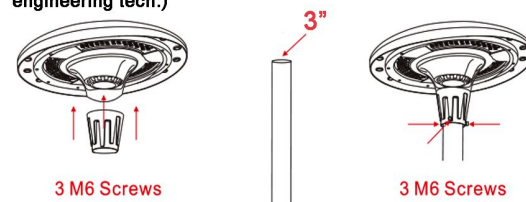

- Make sure the solar panel is facing the correct angle and direction to the Sun / South.

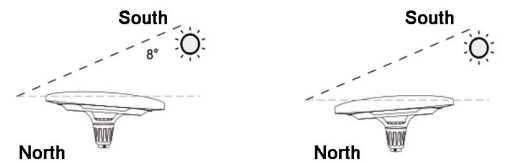

100% Charging Efficiency

50% Charging Efficiency

User Tips:

- Steup the direction of on top solar panel 5-8 degrees to South is best. Est to West will be fine.
- Ensure that the whole unit is affixed firmly to a permanent structure/underground foundation so it is not affected by high winds.
- Use the provided 2.4G Remote/Smart phone to select brightness and fixed color/color-temp to match the environment or seasons.
- Must be avoid installing it under the large shade of tress and any obstructions around.

Two Years Limited Warranty

ESGI guarantees this product to be free from defects in material & workmanship for (2) years. This warranty does not apply to damage from misuse or incorrect installation/ connection. This warranty does not cover accessories, bulbs, batteries, high voltage accidents, alterations, unauthorized use or repair, neglect, misuse, abuse, damages or defects resulting from normal wear and tear (including chips, fading scratches, abrasions or discoloration due to usage or sun exposure), or failure to follow instructions for care and maintenance, fire, flood, and Acts of God. This warranty does not include liability for incidental or consequential damages. ESGI is not responsible for any damages in excess of the retail purchase price of the product under any circumstances. The consumer is responsible for the installation of, removal of, and reinstallation of the product



12346 Valley Blvd, Suite A , El Monte, CA 91732
 Tel: 1-877-579-3889 Fax: 626-452-9194
www.eleding.com
sales@eesgi.com

EE SYSTEMS GROUP, INC.

Remote Controller Instructions

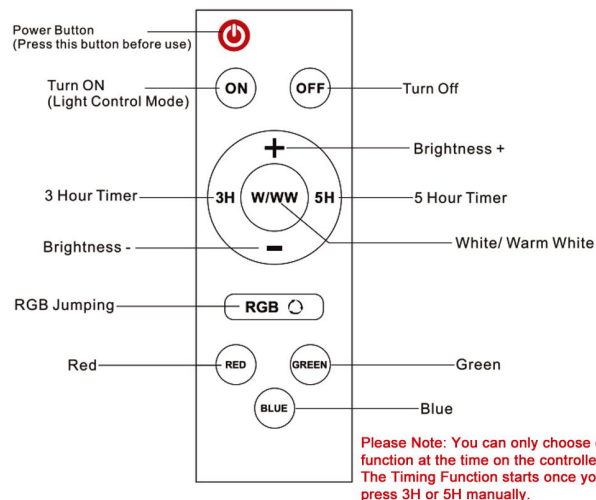

Important Notification

1. Please never connect AC power to this unit as it will damage the system and very likely cause personal injury by electric shock and fire.
2. Please ensure the Installation is affixed firmly to solid/permanent fixture so as to avoid it falling & causing injury and damage.
3. Disassembling the light unit or any of its parts will void the warranty immediately.
4. Please clean the Solar Panel on top regularly of dust, debris and bird dropping as this will keep the Panels output at its highest efficiency for charging the batteries.

APP Instructions

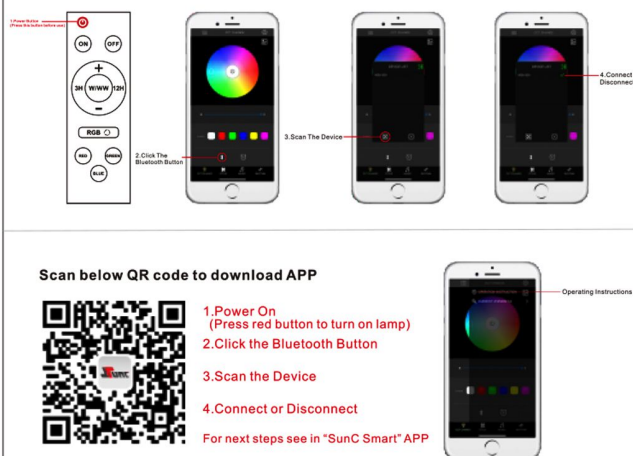

Connect Bluetooth Speaker(Optional)



Remark: Connecting Bluetooth speaker, will be compatible with the function of APP. such as lighting mode. Music rhythm etc.

Related Products

EE800W-AI:
<https://eleding.com/ee800w-ai>

EE-DW900:
<https://eleding.com/ee-dw900>



Looking for the pole?
Check our 13ft black metal pole:
<https://eleding.com/ee-pl4m>



Two Years Limited Warranty

ESGI guarantees this product to be free from defects in material & workmanship for (2) years. This warranty does not apply to damage from misuse or incorrect installation/ connection. This warranty does not cover accessories, bulbs, batteries, high voltage accidents, alterations, unauthorized use or repair, neglect, misuse, abuse, damages or defects resulting from normal wear and tear (including chips, fading scratches, abrasions or discoloration due to usage or sun exposure), or failure to follow instructions for care and maintenance, fire, flood, and Acts of God. This warranty does not include liability for incidental or consequential damages. ESGI is not responsible for any damages in excess of the retail purchase price of the product under any circumstances. The consumer is responsible for the installation of, removal of, and reinstallation of the product



12346 Valley Blvd, Suite A, El Monte, CA 91732
Tel: 1-877-579-3889 Fax: 626-452-9194
www.eleding.com
sales@eesgi.com