

SQUARE TABLE

USER 
MANUAL



CONTENTS

TOP UNIT

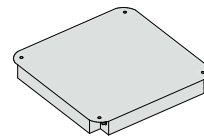

x1

BASEPLATE

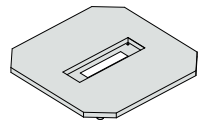

x1

STAND



x1

THUMBSCREW



x8

EXTENSION CORD



x1

POWER CORD



x1



120V 15A OUTLET
REQUIRED



 SCAN ME

INCHARGED. SQUARE TABLE



(800) 516-3580

SETUP INSTRUCTIONS



01

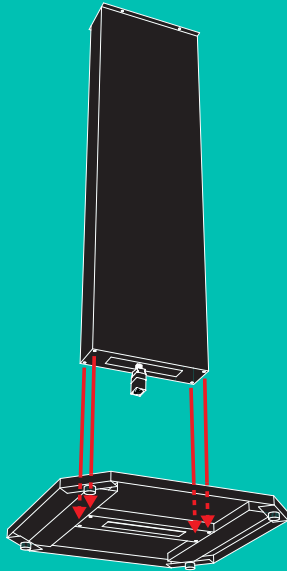

Attach the stand to the baseplate

02

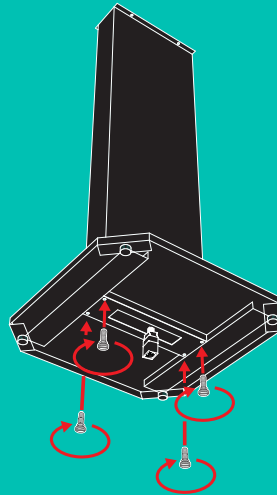

Fix stand to the baseplate using 4 thumbscrews

03

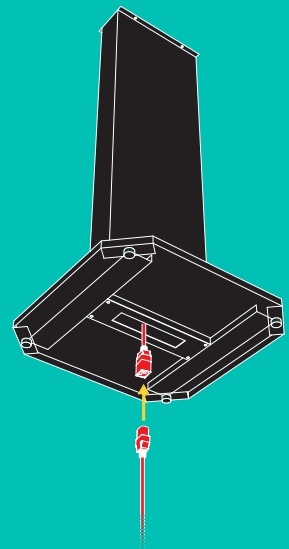

Connect power cord with the extension cord

04

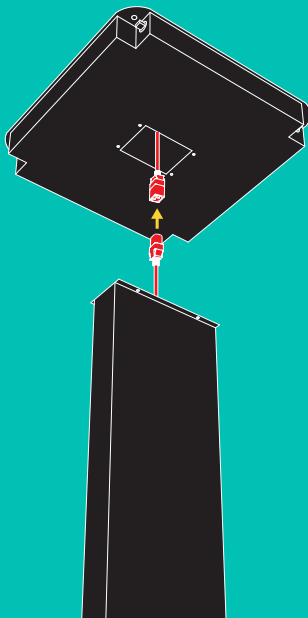

Connect power cord with the extension cord

05

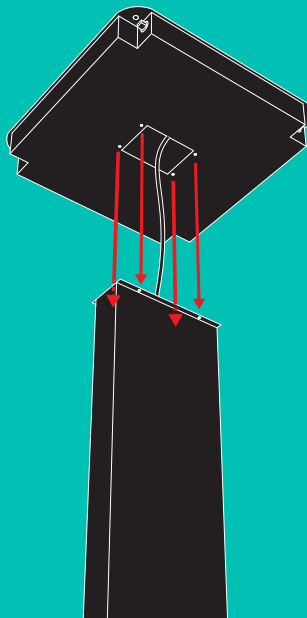

Attach top unit to the stand

06

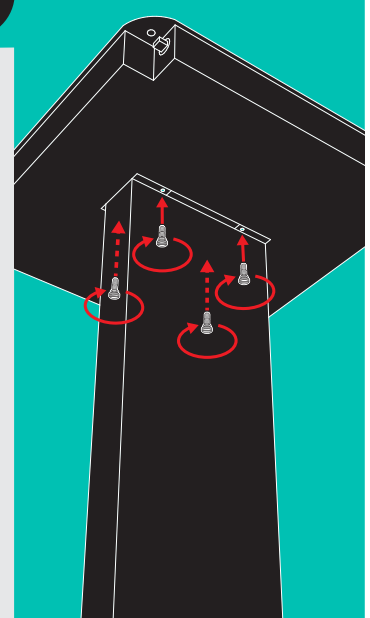

Fix top unit to the stand using 4 thumbscrews