

Clear Plastic Protective Shield for Mobile Computer Cart 309235BK/BG

Parts List

A: 4x Screws to affix bases or C-Clamps to uprights

B: 1x Allen Key to use to attach bases to uprights

C: 2x C-Clamps

D: 6x Panel Grippers

E: 2x Uprights

F: 4x Screws to affix panels to uprights

G: 4x Finishing washers to use when affixing panels to uprights

H: 2x PETG Clear Plastic Shield with pre-drilled holes

J: 1x PETG Clear Plastic Shield plain (without holes)

K: 2x Adhesive backed Fined Grippers

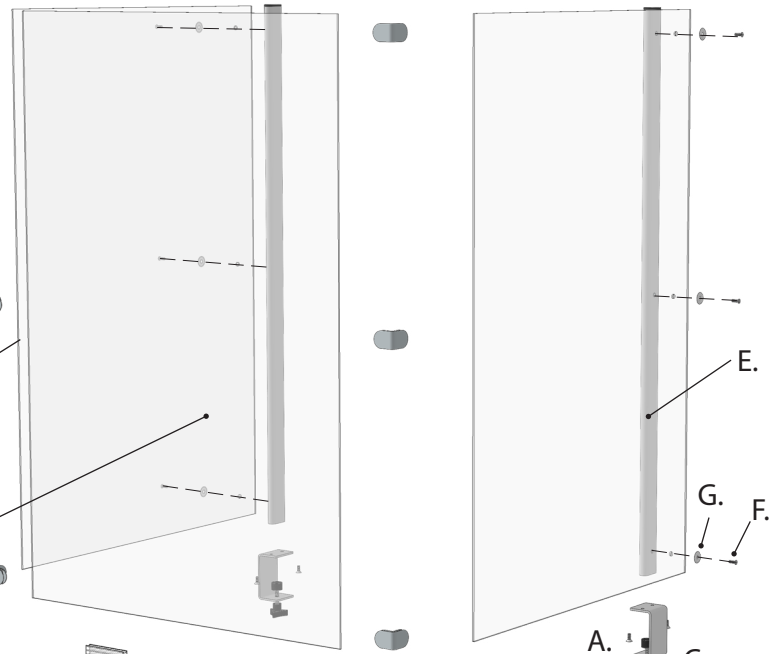
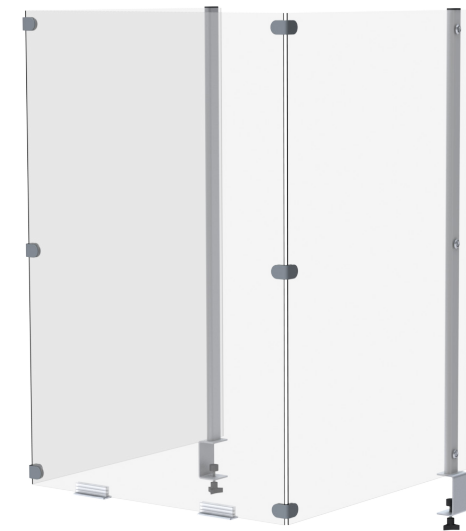
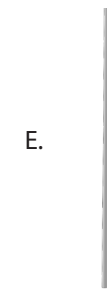
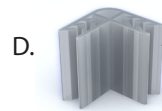
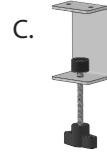

Model no. 309235S

Clear Plastic Protective Shield for Mobile Computer Cart 309235BK/BG

Assembly Steps

1. Unbox Uprights, Clear Panel, Clamps, Grippers and Screws.
2. Mount each upright to each clamp using the Allen screws provided, with the screw holes on the uprights facing the flat side of the clamp bracket.
3. Mount each clamp to opposite sides of your table, approximately 1-1/4" from the edge as shown below. The nylon puck on the bottom of the clamp will tighten against the steel tubing below the table top. Tighten the clamp knobs to secure the uprights.
4. Mount each Clear Panel with pre-drilled holes (Part H) to the uprights using the short countersunk screws (Part F) and finishing washers (Part G).
5. Slide the panel grippers (Part D) over the edge of the plain clear panel (Part J). Attach the grippers onto the adjacent panels (Part H).
6. Use the included Adhesive Backed Fined grippers (Part K) to attach the panels to the desktop. Be sure to have the spacing correct first, with the back panel over the desk, and where the adhesive grippers will be completely on the desk, not hanging off.

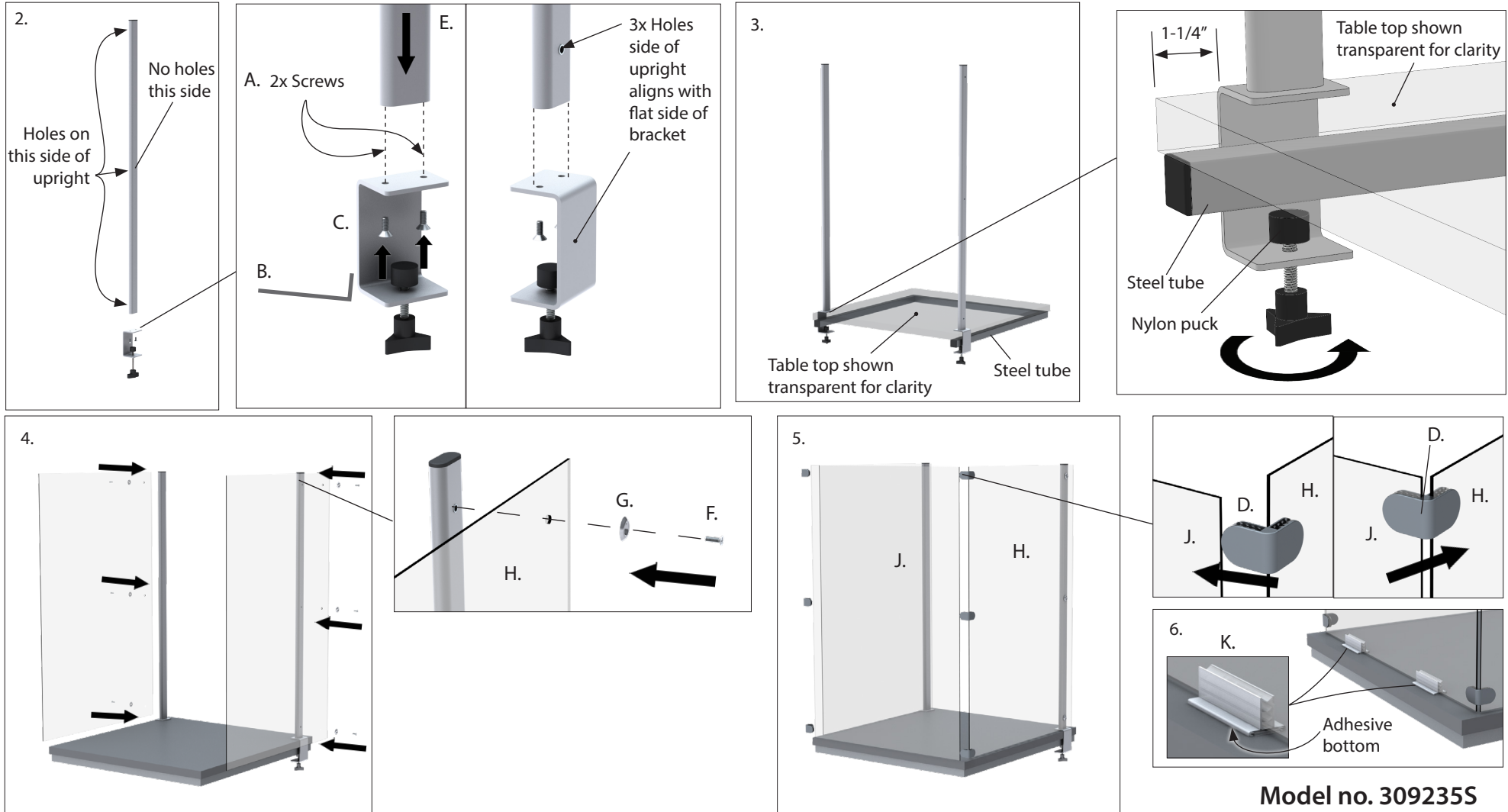

Model no. 309235S

Clear Plastic Protective Shield for Mobile Computer Cart 309235BK/BG

Cleaning Instructions:

- PETG is a flexible material that can be scratched or become hazy if using the wrong chemicals or materials to clean.

Recommendations:

- Use clean soft cloths for cleaning.
- Use a small amount of mild dish liquid detergent, (Dawn, Joy, or Ivory), mixed with lukewarm water to clean.

Items not to do:

- Don't use scrapers, squeegees, or razors.
- Don't use cleaners with high alkaline, ammonia or alcohol. **NO WINDEX.**

