

User's manual	Manual del usuario	Manuel de l'utilisateur
Customer Service US: 1-800-645-2986	Servicio de atención al Cliente US: 1-800-645-2986	Service à la clientèle Canada: 888-645-2986

HEPA Canister Vacuum - 4 Gallon

Model 713165



Keep this manual for future reference

CAUTION:

This machine is equipped with a specially designed cable, which if damaged, must be replaced by a cable of the same type at authorized service shops.

CAUTION:

This machine is equipped with a thermal cut-out to protect the motor and other vital machine parts from overheating. Should the machine cut out, you will have to wait at least 5-10 minutes for it to automatically reset. While you are waiting, switch the machine off and unplug it, then check the hose, dust bag and filters to be sure that nothing is blocking the flow of air through the machine.

WARNING:

ALWAYS remove the plug from the main socket before servicing or performing maintenance on this unit.

Replacement Accessories

Model 713167
Replacement HEPA Filter

Model 713168
Replacement Debris Bags - 5 Pack

For more information, contact Global Industrial Customer Service at 1-800-645-2986 or visit: www.globalindustrial.com

WARNING:

• Read entire manual carefully prior to assembly and use. If there are additional questions, contact Global Industrial Customer Service at 1-800-645-2986 or visit us at: www.globalindustrial.com

WARNING:

To reduce the risk of fire, electric shock, and/or injury, read and follow all safety precautions and instructions prior to use.

- This vacuum is for commercial use only and is designed to be safe when used for cleaning functions as specified in this manual. Should damage occur to electrical or mechanical parts, the cleaner and/or accessories must be repaired by authorized personnel or service centers.
- DO NOT attempt to repair or service this unit yourself, doing so will void warranty.
- DO NOT use outdoors or on wet surfaces.
- DO NOT use to pick up liquids.
- Disconnect the vacuum before servicing and when not in use.
- DO NOT leave the vacuum plugged in unattended.
- DO NOT use if cord or plug is damaged.
- To unplug, grasp the plug, not the cord. Turn off all controls before unplugging.
- DO NOT handle plug or cleaner with wet hands.
- DO NOT pull or carry by cord, use cord as a handle, close a door on cord, or pull cord around sharp edges or corners.
- DO NOT run cleaner over cord.
- Keep cord away from heated surfaces.
- Keep hair, loose clothing, fingers and all parts of the body away from the opening and moving parts. DO NOT put anything else that could reduce or block the flow of air.
- DO NOT pick up anything that is burning or smoking, such as cigarettes, matches, or hot ashes.
- DO NOT pick up broken glass and sharp-edged objects.
- Use with extra care when using on stairs.
- DO NOT use to pick up flammable or combustible liquids such as gasoline, or use in areas where they may be presents.
- Keep the appliance out of reach from children.
- DO NOT pick up hazardous materials.
- DO NOT use unless filters are fitted.
- NEVER immerse the appliance in water or other liquids.
- Use only as described in this manual and only with Global Industrial's recommended attachments.
- Before vacuum is plugged in, check the rating plate to see if the rated voltage agrees within 10% of the voltage available.
- Use only identical, Global Industrial replacement parts.
- This appliance conforms with the CE directive for radio interference suppression and low-voltage safety and has been built to meet current safety requirements.

HEPA Canister Vacuum - 4 Gallon

Assembly and Operation

1. To Open

- Pull the retaining clips upward and outward
- Lift the cover from the container

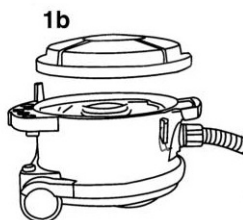
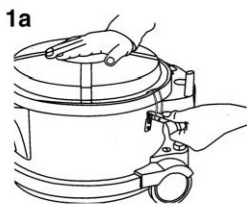

2. Debris Bag

Fit the opening on the debris bag over the air inlet. Press the membrane over the flanged edge on the inlet. Secure with the lock washer.

Note: Use only with Global Industrial debris bag - Model 713168

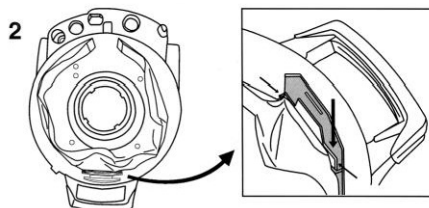

3. Hose Connection

Push the hose coupling all the way in and turn clockwise.

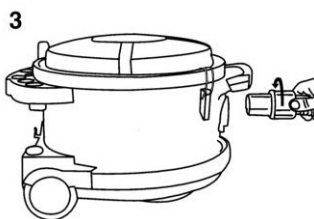

4. Tube Assembly

- Fit the telescopic tube into the nozzle and twist to fix it in position
- Use the extension tube to achieve required length

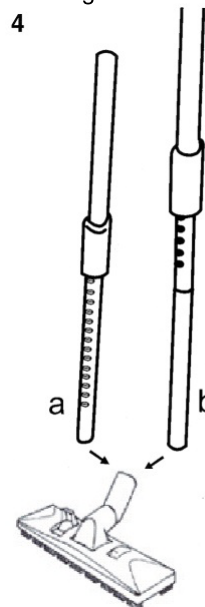

5. Accessories

a) Combination Nozzle:

- Brush for hard floors
- Brush for carpets

b) Small Nozzle: Ideal for curtains and like material.

c) Crevice Nozzle: Use to clean corners, grooves and other hard-to-reach places.

d) Small Brush: For furniture, picture frames, upholstery, car seats and other soft surfaces.

e) Clip: The clip on the tube holds the small nozzle and small brush when they are not in use.

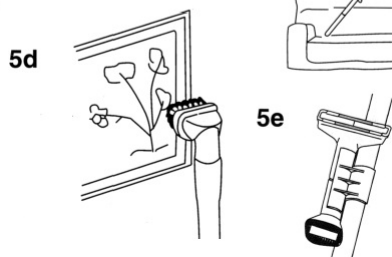
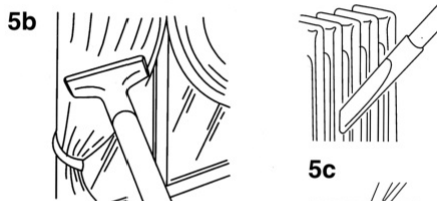
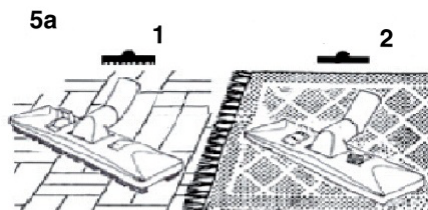

6. Air Slider Valve

The valve in the hose handle lets you regulate the air-flow pressure or helps to release any items stuck in the nozzle.

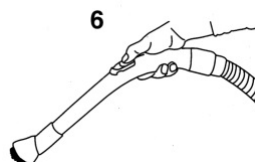

7. Start/Stop

- Foot operated on/off switch
- Plug-in socket for power cord
- Adjust the electronic power control knob to regulate the suction strength

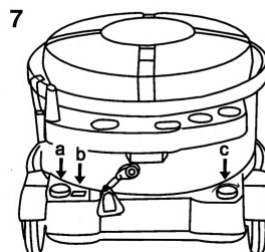

8. Filter

The main filters are located inside the lid. To reach them, lift out the filter holder (a). The standard filter (b) should be inspected regularly and replaced if necessary. The machine is also fitted with a backup filter (c) located above the motor. This filter should also be inspected and replaced if necessary.

