

User Manual

Manual de Usuario

Manuel de l'Utilisateur

 Customer Service  
 US: 1-800-645-2986

 Servicio de atención al Cliente  
 US: 1-800-645-2986

 Service à la clientèle  
 Canada: 888-645-2986

Model 641830

# Wide Area Carpet Vacuum Cleaner

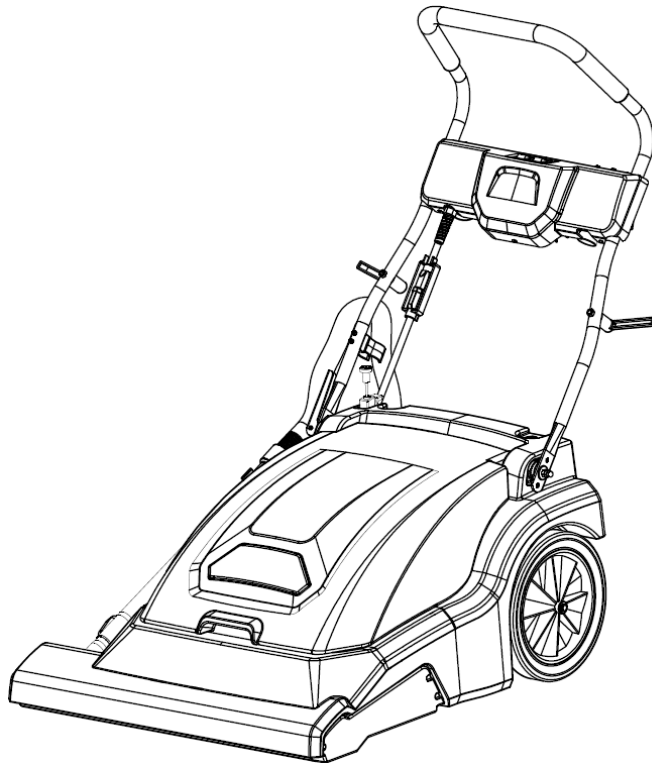

## ⚠ WARNING:

- Do not leave the vacuum cleaner alone when the power is on. Unplug the machine when not in use or before removing filter.
- Do not immerse the vacuum cleaner in water or other liquids.
- Please follow the instructions. Use only the accessories recommended by Global Industrial.
- Do not use the power cable or plug when it is damaged. Do not use the machine if it has been dropped, damaged, left outdoors, or dropped into water. Please send the machine to us for inspection, repair or adjustment.
- Do not pull the power cord to drag the machine or lift the machine; do not leave the cable line in front of a door. Keep the cord away from sharp edges or corners. Do not step on the power cord. Do not allow the power cord to touch hot surfaces.
- Do not unplug the machine by pulling the cord. To pull the plug, grab the plug, not the cable.
- Do not touch plugs or machines with wet hands.
- Do not use the vacuum cleaner to pick up large objects or objects that could damage the machine.
- Keep hair, loose clothing, fingers, feet and other parts of the body away from vacuum's inlet, rolling brushes, and other moving parts. Never vacuum with barefoot or open-toed shoes.
- Do not pick up heat coal, cigarette ends, matches, or anything hot, smoking, or burning.
- Do not pick up hard or sharp objects such as glass, nails, screws, etc.
- Do not use this vacuum cleaner if the filter is not in its proper position. Only use filters and accessories provided by Global Industrial. Using other brands will void warranty.
- Do not vacuum flammable or inflammable materials (lighter fluid, gasoline, kerosene, etc.) or use with explosive liquids or gases present.
- Do not use a vacuum cleaner in a confined space filled with gases released by oil-based paints, paint thinners, insect repellents, combustible dust, or explosive and toxic gases
- Use only indoors and on dry surfaces.
- Do not put anything into the vacuum tunnel. Do not use a vacuum cleaner when the vacuum inlet is blocked.
- Remove dust, cotton thread, hair, and other material from your body that may slow the flow of air.
- Store the machine indoors in a cool, dry area.
- Keep lights on in your cleaning area.
- Keep hose ports, inlets/outlets, and all moving parts away from your face, body and clothing.
- This machine is not suitable for children, disabled, or those who are lack of relevant knowledge and experience, unless there is special guidance/supervision to ensure their safety.

# Wide Area Vacuum

## ⚠ WARNING:

- Electrical - 115 Volt  
This machine is designed to operate on a standard 15 amp, 115 volt, 60 hz, AC circuit. Voltages below 105 volts AC or above 125 volts AC could cause serious damage to the motor.
- Grounding Instructions  
To protect the operator from electrical shock, this machine must be grounded while in use. This machine is equipped with an approved three-conductor power cord and grounding type plug to fit the proper grounding type receptacle.
- This machine is for use on a nominal 120 volt circuit and has a grounding plug (see illustration). Make sure that the machine is connected to an outlet having the same configuration as the plug. No adapter should be used with this machine.

**WARNING** – This appliance must be grounded. If it should malfunction or breakdown, grounding provides a path of least resistance for electric current to reduce the risk of electric shock. This appliance is equipped with a cord having an equipment-grounding conductor and grounding plug. The plug must be inserted into an appropriate outlet that is properly installed and grounded in accordance with all local codes and ordinances.

**WARNING** – Improper connection of the equipment-grounding conductor can result in a risk of electric shock. Check with a qualified electrician or service person if you are in doubt as to whether the outlet is properly grounded. Do not modify the plug provided with the appliance – if it will not fit the outlet, have a proper outlet installed by a qualified electrician.

## Specifications:

Model: 641830  
Cleaning Width: 30"  
Voltage: 120V 60Hz  
Current: 12A  
Dimensions: 30.7"W x 33"D x 15.4"H (folded)  
52"H (max with handle)  
Weight: 115 lbs.  
Debris Capacity 10.5 Gallons  
Filter: Deodorizing HEPA  
Power Cord: 80 ft.; replaceable  
Certification: ETL/cETL

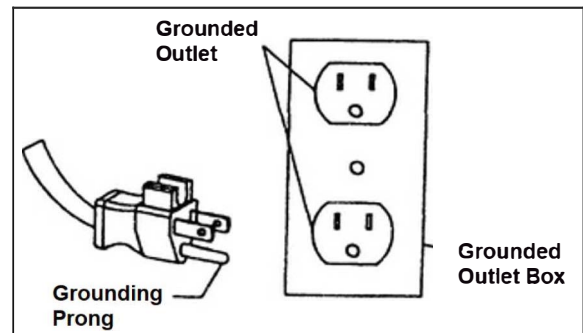

## Machine Overview:

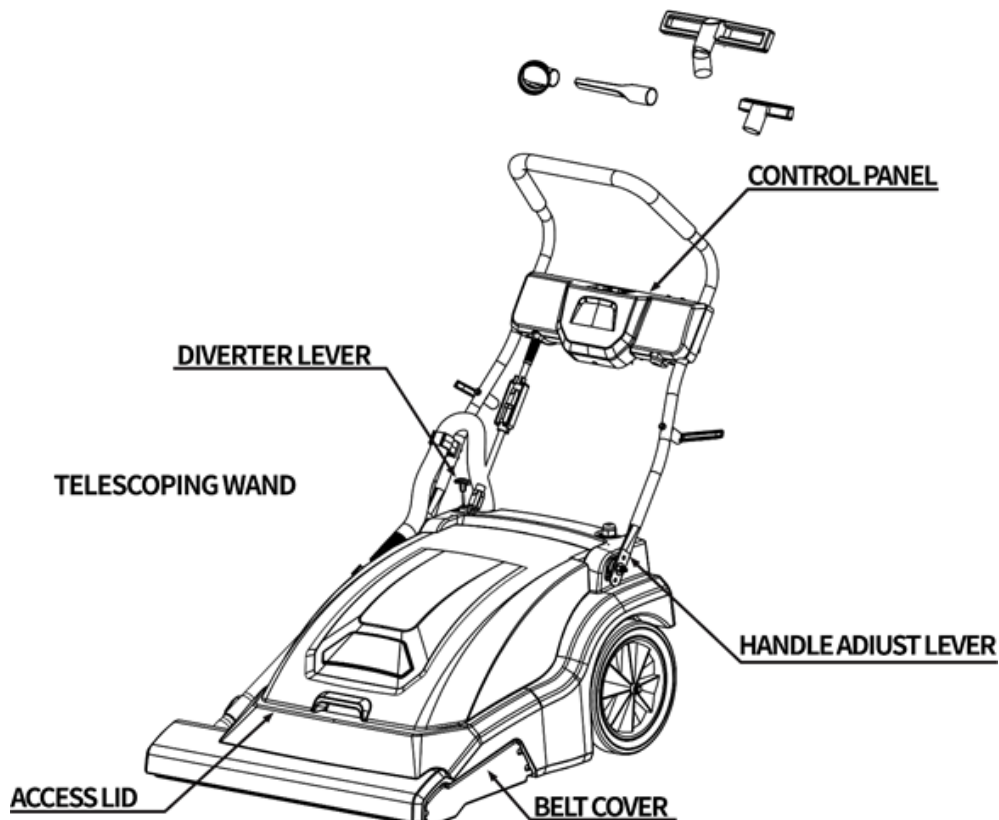

# Wide Area Vacuum

## Brush Pedal

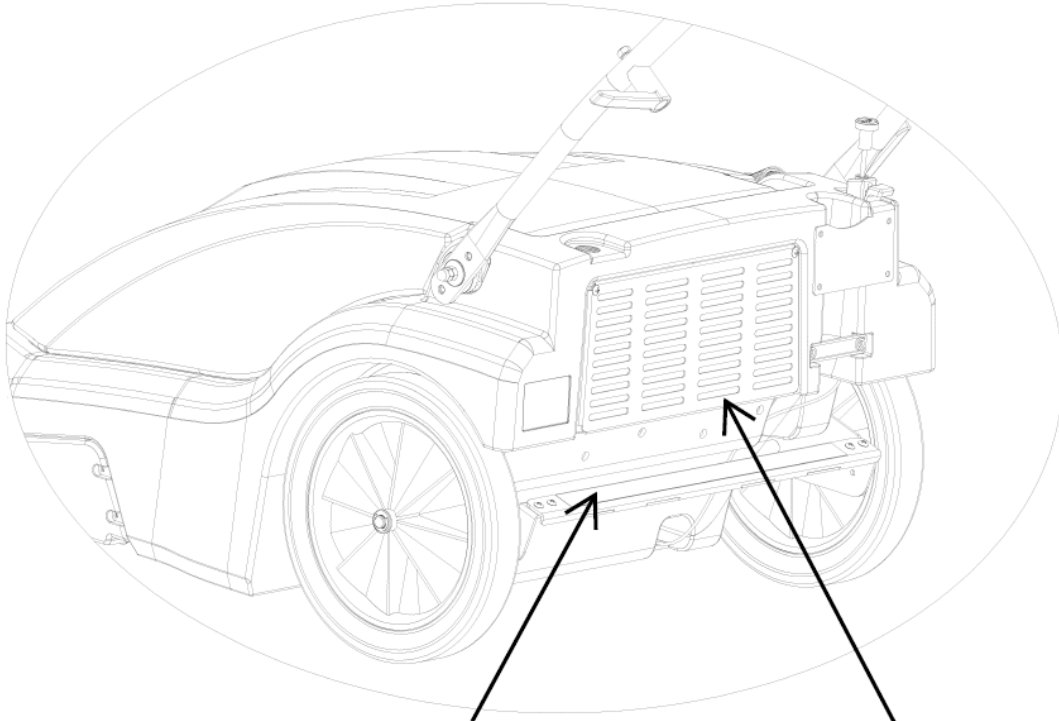

DEPRESS PEDAL TO LOWER  
BRUSH HEIGHT

RAISE PEDAL TO SET BRUSH  
AT HIGHER PILE HEIGHT

REMOVE SCREWS ON BOTTOM  
OF COVER TO REPLACE THE  
EXHAUST FILTER

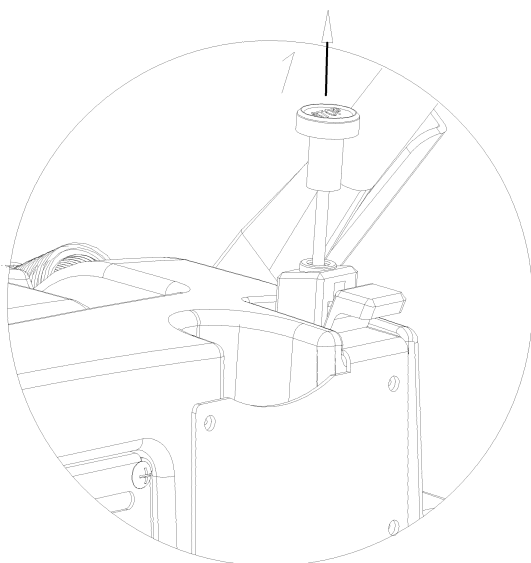

RAISE THE DIVERTED LEVER (1) TO ACTIVATE THE  
OFF-AISLE WAND FUNCTION.

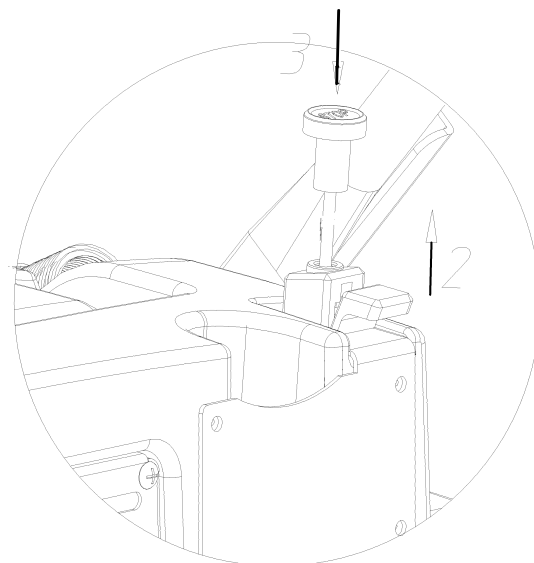

TO RELEASE THE LEVER, PULL UP ON THE LOCK  
TAB (2) AND PUSH DOWN ON THE DIVERTED LEVER  
(3) SIMULTANEOUSLY.

# Wide Area Vacuum

## Operation:

The vacuum is designed primarily for use on carpet, although it also performs very well on hard surface floors. Sand, dust, paper, etc. are readily vacuumed from these types of floors. However, it is not recommended that this machine be used to vacuum metal hardware, shavings, or similar type of debris from floors, carpeted or otherwise. Inspect the carton for shipping damage when received.

## Operating Instructions

Before starting, familiarize yourself with machine and controls (see 'Machine Overview' and 'Control Panel' diagrams). Large debris such as paper cups, plates, etc. should be picked up before starting the cleaning process.

To operate machine, do the following:

1. Make sure unit is used only on voltage shown on nameplate.
2. From storage position (handles folded), position machine so all four wheels are on floor.
3. Adjust handle to a desired and comfortable position by lifting on adjustment lever located on left side of machine at base of metal handle. After desired handle position is set, lock in place by closing adjustment lever.
4. Install paper and/or cloth bags inside main compartment by pushing rubber collar onto flanged bag adaptor.
5. If using both bags, install cloth bag as described above, unzip it, and place paper bag inside. Push rubber gasket seal over adaptor. Zip up cloth bag and make sure there is no damage to paper bag. Close lid.
6. There are four (4) brush settings for different carpet piles. This can be adjusted by either depressing foot pedal (lowest level) for short naps, such as indoor/outdoor carpeting, or by lifting pedal for taller naps (highest setting). Set brush height to lightly hit carpet surface.
7. Turn on vacuum and brush switch (see control panel). Keep machine moving while brush is activated. Damage to carpet could occur if brush is kept in same spot.
8. The rate at which the operator pushes machine depends on debris load, type of debris, and carpet nap length. In areas where large amounts of 'tracked in' sand are present, carpets should be vacuumed with a double pass (forward and backward pass made without turning machine around at the end of one pass). A slow, moderate walking pace by the operator normally gives a good cleaning result.
9. To use off-aisle wand, turn off brush power switch, pull up and twist to lock control cable (see machine overview) to divert air from main nozzle to auxiliary hose.
10. For storage, handle may be folded over and machine parked in an upright position to increase closet space. To fold for storage, unlock handle adjustment lever when the machine is on all four wheels, push handle forward as far as it will go and re-lock the handle adjustment lever. Tilt machine back on large wheels until it is in an upright position and ready to be stored.

## Maintenance:

Periodic maintenance should be followed for good performance and longer machine life. Unplug power cord from electrical source before making any repairs or adjustments to machine.

### Daily:

For cloth bags, shake down bag daily. For paper bags, check if full and replace as necessary. Check power cord for damaged or frayed insulation. Return machine to 'storage' position when not in use. Check and remove any string, lint, or debris from around brush and brush housing.

### Monthly:

Remove rear wheels and clean axle. Apply thin coat of silicone lubricant on each wheel axle and front casters. This should be done at least twice a year. The cloth filter bag can be washed twice before losing its filtering capabilities. Wash with mild detergent and cool water, drip dry. Make sure bag is totally dry before reinstalling to machine, otherwise electrical shock may occur. Inspect all hoses, cables, filters, and gaskets. Clogged filters and damaged hoses and gaskets can result in loss of vacuum.

### Brush Adjustment/Replacement

Inspect brush for wear. Adjust or replace brush when necessary.

#### Adjustment:

1. The brush housing is set up so you can change the brush position to extend the brush life. When bristles are worn down enough so there is no contact with floor on lowest setting, you may reposition brush as described:
2. Unplug power cord from electrical source.
3. Remove belt cover by removing three screws.
4. Remove the two screws and washers from each end of brush housing (it may be necessary to remove housing assembly for easier access).
5. Rotate bearing retainer ring and bearing support ring so that they line up with second set of mounting holes, which lowers the brush by 1/16".

#### Replacement:

1. Unplug power cord from electrical source.
2. Remove belt cover by removing three screws.
3. Loosen brush motor plate and roll belt off brush pulley.
4. Remove the ten screws securing brush housing assembly from main body.
5. Loosen set screw, remove pulley from shaft.
6. Remove the two screws and washers from each end of brush assembly.
7. Remove the two flat head screws that attach brush to shaft, slide shaft out of brush core.
8. Inspect bearings; make sure to remove the two bushings at each brush end to replace them on new brush.
9. Install new brush to shaft and assemble accordingly.
10. When attaching bearing retainer and supporting ring, make sure screws and washers are placed on normal (horizontal) position otherwise machine will not function properly.
11. After reinstalling brush housing assembly check for proper belt tension.